

Uputstvo za upotrebu (EN)

MARSHALL bluetooth zvučnik Middleton Black

Marshall



Tehnoteka je online destinacija za upoređivanje cena i karakteristika bele tehnike, potrošačke elektronike i IT uređaja kod trgovinskih lanaca i internet prodavnica u Srbiji. Naša stranica vam omogućava da istražite najnovije informacije, detaljne karakteristike i konkurentne cene proizvoda.

Posetite nas i uživajte u ekskluzivnom iskustvu pametne kupovine klikom na link:

<https://tehnoteka.rs/p/marshall-bluetooth-zvucnik-middleton-black-akcija-cena/>

Marshall

MIDDLETON – PORTABLE LOUDSPEAKER

FULL ONLINE MANUAL

CONTENTS

ENGLISH

INDEX

Device layout.....003

Getting started.....006

Connecting an AUX device.....006

Cleaning the speaker.....006

Battery care guide.....007

Performing a factory reset.....007

Attaching the carry strap.....008









Stack mode.....009

Troubleshooting.....010

DEVICE LAYOUT

ENGLISH



2	I.	II.	III. IV.	V.
 0:02 	 		  	

DEVICE LAYOUT

ENGLISH

① BATTERY STATUS BUTTON

Push the Battery status button to see the battery charge.

② BLUETOOTH BUTTON

Push and hold the Bluetooth® button until the LED turns to a slow red pulse to start pairing mode.

③ BATTERY INDICATOR

The 10 segment battery indicator shows battery status or audio control levels. Pushing the Battery status button will show the battery charge. Adjusting the volume, bass, or treble will show the level for the adjusted control. A rising animation indicates that the battery is charging.

④ CONTROL KNOB

- I. Push and hold for 2 seconds to turn on/off
- II. Push once to play/pause
- III. Push right/left to skip forward/back
- IV. Hold right/left to fast forward/rewind
- V. Push upwards/downwards to adjust the volume

⑤ BASS AND TREBLE CONTROLS

Use the bass and treble controls to adjust the audio balance. The 10 segment indicator shows the bass or treble level while adjusting.

⑥ CARRY STRAP HINGE

Attach the included carry strap to the hinge, see Attaching the carry strap.

DEVICE LAYOUT

ENGLISH

⑦ **AUX - 3.5 MM AUDIO INPUT**

Plug in an audio device with an analogue output and a 3.5 mm stereo jack.

⑧ **USB C - POWER INPUT/OUTPUT**

Charge the speaker by plugging it into a USB power source or plug in a USB-C device and use the speaker as a powerbank.

INSTRUCTIONS

ENGLISH

GETTING STARTED

- I. Push and hold the control knob until the speaker turns on.
- II. Push the Bluetooth® button until the LED turns to a slow red pulse.
- III. Select MIDDLETON from your audio device's Bluetooth list.

CONNECTING AN AUX DEVICE

- I. Connect a lead with a 3.5 mm stereo jack to the AUX input on the back of the speaker.
- II. Connect the other end of the lead to the audio output on your audio source.
- III. Make sure all connected Bluetooth audio devices are paused.

Note: Audio leads are not included.

CLEANING THE SPEAKER

Clean your speaker regularly to keep it fresh and last longer.

Unplug any leads before cleaning the speaker and make sure everything is completely dry before plugging in any audio or USB leads.

The silicone sleeve and strap can be removed and cleaned separately. Use a disinfectant wipe or a lint-free cloth, slightly damp with 70% isopropyl alcohol or 75% ethyl alcohol to gently clean silicon parts. Dry them with a towel before putting them back on the speaker.

Carefully clean the speaker mesh and openings with a dry and soft brush, or a cotton swab.

- Do not use any sharp or metal objects.
- Do not use compressed air.
- Do not use products containing bleach or hydrogen peroxide.
- Do not submerge the speaker in any cleaning agents.

INSTRUCTIONS

ENGLISH

BATTERY CARE GUIDE

Your speaker comes equipped with a high-performance lithium-ion battery and the life span is affected by charging and usage. Follow the guidelines below to keep your battery in great condition for as long as possible.

- Avoid using fast chargers if possible. Fast charging causes stress on the battery and will degrade it.
- Avoid charging the battery when it is already full or letting it drain completely. Try keeping the charge between 30% and 80%.
- If the speaker is stored for a long time, do so with a half-charged battery and in a cool, dark, and dry place.
- Do not use or charge the speaker in hot and unventilated places, 45°C/113°F and above, such as in a parked car or by a window in direct sunlight.
- Avoid charging the battery at low temperatures, below 10°C/50°F and using the speaker below 0°C/32°F.
- Avoid strong mechanical shocks such as dropping the speaker on hard surfaces as it might damage the battery.

PERFORMING A FACTORY RESET

A factory reset will return the speaker to its original settings, excluding any firmware updates.

Note: This will delete all user settings meaning the speaker will need to be set up again.

- I. Ensure that the speaker is on.
- II. Push and hold the Bluetooth button for 7 seconds. All indicators turn off and the speaker restarts.
- III. Remove Middleton from your audio device's Bluetooth list before pairing again.

MARSHALL BLUETOOTH APP

Download the Marshall Bluetooth app to get the most out of your speaker and keep it up to date with the latest software.



ATTACHING THE CARRY STRAP

ENGLISH

- I. Remove the screw from the carry strap.
- II. Thread the end of the strap through the top of the hinge on the speaker.
- III. Join the end of the strap with the screw and tighten it.

Make sure the carry strap is secured to the speaker before use.

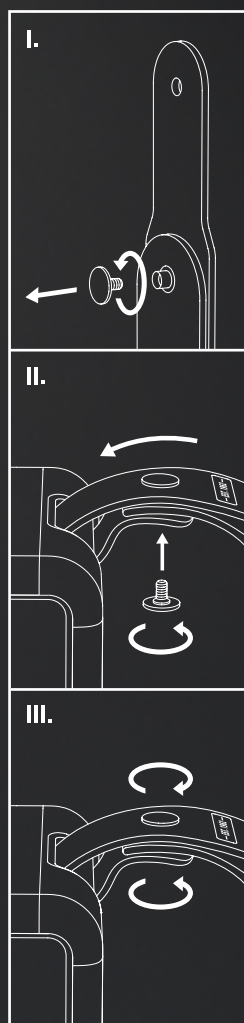

STACK MODE

ENGLISH

Connect two or more Middleton speakers in a Stack session for a bigger sound. Play anything on the main speaker and all speakers in the session will play in sync. You can adjust the volume on any individual speaker for the perfect balance.

1 MAIN SPEAKER

Triple press the Bluetooth button to start or end a Stack session. The LED starts to blink until another speaker joins the session.

2 ADDITIONAL SPEAKER

Double press the Bluetooth button on any speaker you want to add to the session. The LED starts to blink until the speaker has joined the session.

While in a session, the speaker will disconnect from any previously connected audio device and will try to reconnect after leaving the session.

To remove a speaker from the session, double press the Bluetooth button on that speaker.

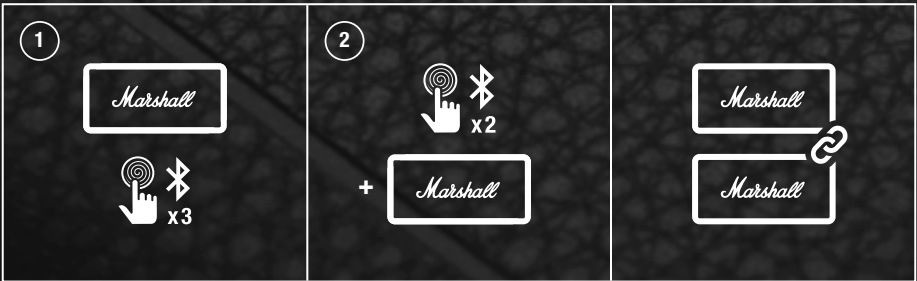

TROUBLESHOOTING

ENGLISH

PROBLEM	CAUSE	ACTION
Cannot connect or pair with a Bluetooth device	The battery has no charge.	Plug the speaker into a USB power source to charge it. Push and hold the control knob for 2 seconds until the speaker turns on.
	Bluetooth is not enabled on your device (smartphone, tablet, computer).	Activate Bluetooth on your playback device.
	The speaker is not turned on.	Push and hold the control knob for 2 seconds to turn on the speaker before setting it in pairing mode.
Cannot play in Stack mode	The speaker is not in pairing mode.	Push the Bluetooth button until the Bluetooth LED pulses red.
	The playback device is not connected to the main speaker.	Make sure that your playback device (phone or computer) is paired with the main speaker.

TROUBLESHOOTING

ENGLISH

PROBLEM	CAUSE	ACTION
Bluetooth connection drops out	The two Bluetooth devices are too far apart, or the connection is affected due to obstacles.	Move the devices closer to each other so that they are unobstructed by obstacles such as walls or doors.
	There is a strong electric field surrounding the speaker. Items such as microwave ovens, wireless network adapters, fluorescent lights and gas cookers use the same frequency range as the Bluetooth device. This may lead to electrical disturbances.	Move the speaker to another spot or turn off or move the interfering electronic device.
Erratic behavior	The speaker is not using the latest firmware version.	Download the Marshall Bluetooth app and connect to the speaker. Follow the in-app instructions to ensure that the speaker has the latest firmware version.
	There is a software error.	Perform a factory reset by pressing the Bluetooth button for 7 seconds. The speaker needs to be set up again.

TROUBLESHOOTING

ENGLISH

Design of device and packaging are intellectual properties of Zound Industries International AB and Marshall Amplification Plc. © All Rights Reserved. MARSHALL, Marshall Amps, their respective logos, "Marshall" and "Marshall" trade dress are trademarks and intellectual property of Marshall Amplification Plc and may not be used without permission. Permission granted to Zound Industries International AB. The Bluetooth® wordmark and logos are registered trademarks owned by the Bluetooth SIG, Inc. and any use of such marks by Zound Industries International AB is under license. Google Play is a trademark of Google LLC. App Store is a service mark of Apple Inc., registered in the U.S. and other countries. R 0.14

Ovaj dokument je originalno proizveden i objavljen od strane proizvođača, brenda Marshall, i preuzet je sa njihove zvanične stranice. S obzirom na ovu činjenicu, Tehnoteka ističe da ne preuzima odgovornost za tačnost, celovitost ili pouzdanost informacija, podataka, mišljenja, saveta ili izjava sadržanih u ovom dokumentu.

Napominjemo da Tehnoteka nema ovlašćenje da izvrši bilo kakve izmene ili dopune na ovom dokumentu, stoga nismo odgovorni za eventualne greške, propuste ili netačnosti koje se mogu naći unutar njega. Tehnoteka ne odgovara za štetu nanесenu korisnicima pri upotrebi netačnih podataka. Ukoliko imate dodatna pitanja o proizvodu, ljubazno vas molimo da kontaktirate direktno proizvođača kako biste dobili sve detaljne informacije.

Za najnovije informacije o ceni, dostupnim akcijama i tehničkim karakteristikama proizvoda koji se pominje u ovom dokumentu, molimo posetite našu stranicu klikom na sledeći link:

<https://tehnoteka.rs/p/marshall-bluetooth-zvucnik-middleton-black-akcija-cena/>