

Uputstvo za upotrebu (EN)

AQIRYS bežični miš Zephyr White



Tehnoteka je online destinacija za upoređivanje cena i karakteristika bele tehnike, potrošačke elektronike i IT uređaja kod trgovinskih lanaca i internet prodavnica u Srbiji. Naša stranica vam omogućava da istražite najnovije informacije, detaljne karakteristike i konkurentne cene proizvoda.

Posetite nas i uživajte u ekskluzivnom iskustvu pametne kupovine klikom na link:

<https://tehnoteka.rs/p/aqirys-bezicni-mis-zephyr-white-akcija-cena/>



ZEPHYR

MANUAL DE UTILIZARE
USER MANUAL

RO / EN

MULTUMIM!**THANK YOU!**

RO Multumim ca ati ales Zephyr ca aliatul vostru in bataliile digitale!

Pentru a va bucura de cea mai buna performanta in gaming, va sugeram sa instalati software-ul inclus.

Actualizarile viitoare vor fi disponibile pe site-ul nostru, WWW.AQIRYS.COM.

#SOLID #SMOOTH #FAST #ELEMENTAL

Welcome to the feel of AQIRYS®!

EN Thank you for choosing Zephyr as your ally in digital battles!

For the best gaming performance, we strongly recommend installing the included software.

Future updates will be available on our website, WWW.AQIRYS.COM.

#SOLID #SMOOTH #FAST #ELEMENTAL

Welcome to the feel of AQIRYS®!



CUPRINS

SUMMARY

Specificatii Tehnice / Technical Specifications.....	1
Continut Pachet / Packing List.....	2
Prezentare / Overview	3
Conectarea Mouse-ului Wireless / Wireless Mouse Connection.....	4-5
Conectarea Mouse-ului cu fir / Wired Mouse Connection.....	6
Iluminarea RGB Dock / Dock RGB Illumination.....	7
Nivelul Bateriei / Battery Level.....	7
Incarcarea Bateriei / Battery Charging.....	8
Recomandari / Recommendation.....	8
Atasarea gripurilor / Button and side grips.....	9
Inlocuirea patinelor / Skates replacement.....	9
Atentionari / Warnings.....	10
Reglementari / Regulatory.....	11-12
Suport / Support.....	13

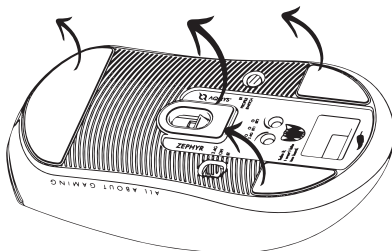
ATENȚIE!
ATTENTION!

RO

Va rugam sa indepartati folia de protectie a patinelor inainte de a incepe sa utilizati mouse-ul.

EN

Please, remove the skates' protecting film before starting using the mouse.

Specificatii Mouse
Mouse Specifications

Distanța operare	8 - 10 m
Senzor	PixArt 3395
Sensibilitate	26000 DPI
Polling rate	1000 Hz
Viteza maxima	650 ips
Acceleratie maxima	50 G
Accelerare hardware	Nu
Contacte butoane	Huano (80 mil. apasari)
Greutate	56 g
Baterie	300 mAh

Operating distance	8 - 10 m
Sensor	PixArt 3395
Sensitivity	26000 DPI
Polling rate	1000 Hz
Max. tracking speed	650 ips
Max. acceleration	50 G
Hardware acceleration	No
Buttons switch	Huano (80 mil. clicks)
Weight	56 g
Battery	300 mAh

Specificatii Transmisor Wireless
Wireless Receiver Specifications

Conectare	USB 2.0
Distanța operare	10 m
Voltaj functionare	5V
Curent functionare	14 - 27 mA

Interface	USB 2.0
Transmission Range	10 m
Operating voltage	5V
Operating current	14 - 27 mA

Continut Pachet
Packing List

1. Mouse Wireless	1. Wireless Mouse
2. Dock incarcare cu porturi USB	2. Charging Dock with USB ports
3. Cablu Incarcare USB Type-C	3. USB Type-C charging cable
4. Manual de Utilizare	4. User Manual
5. Transmisor Wireless	5. Wireless Receiver
6. Patine PTFE de rezerva	6. Spare PTFE skates
7. Grip-uri laterale si pentru butoanele principale	7. Side and main button grips

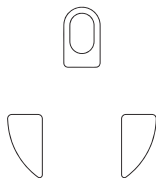
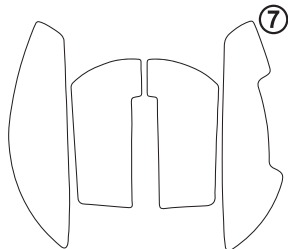
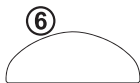
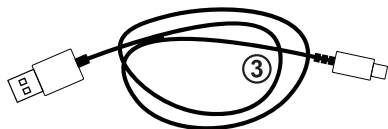

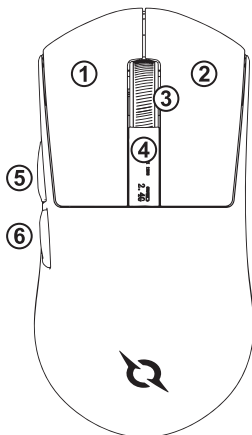
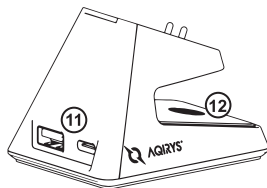
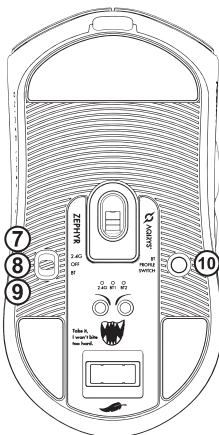
FRONT

BACK

RO

1. Buton Stanga
2. Buton Dreapta
3. Rotita Scroll
4. Buton DPI si display OLED
5. Buton Lateral 1
6. Buton Lateral 2
7. Mod 2.4GHz
8. OFF
9. Mod Bluetooth
10. Buton de Schimbare Profil BT si de Paring
11. Porturi USB 2.0 si Type-C
12. Controlul Iluminarii Dock prin Atingere
13. Buton Iluminare Dock
14. Transmitator Wireless

EN

1. Left Button
2. Right Button
3. Scroll Wheel
4. DPI Button and OLED Display
5. Side Button 1
6. Side Button 2
7. 2.4GHz Mode
8. OFF
9. Bluetooth Mode
10. BT Profile Switch and Pairing Button
11. USB 2.0 and Type-C Ports
12. Touch-activated Dock Lighting Control
13. Dock Lighting Button
14. Wireless Transmitter

Conectarea Mouse-ului Wireless

Wireless Mouse Connection

RO

1. Inicializarea mouse-ului:

- Porniti mouse-ul prin comutarea butonului din **pozitia 8 (OFF)** in **pozitia 7 (2.4GHz)** sau **pozitia 9 (BT)** pentru a selecta un mod de conectivitate.

2. Conectare Initiala:

- La prima utilizare, aveti optiunea de a conecta mouse-ul atat la un dispozitiv Bluetooth, cat si la transmitatorul wireless inclus in pachet

3. Conectarea la Dispozitiv Bluetooth:

- Asigurati-va ca functia Bluetooth a dispozitivului este activata.
- Cautati "AQIRYS Zephyr Wireless Mouse" in lista de dispozitive Bluetooth din apropiere si selectati-l pentru a va conecta.
- Daca conexiunea este reusita, o sa fie afisat pe ecranul OLED mesajul: "Link OK"

4. Conectarea la un nou Dispozitiv Bluetooth:

- Verifica daca mouse-ul este pe profilul Bluetooth corect. Apasa **butonul 10** o data scurt pentru a schimba profilul BT, daca e nevoie.
- Pentru a intra in modul pairing, tine apasat pe **butonul 10** timp de 5 secunde. Vezi modul de pairing activ pe ecranul OLED si prin clipirea LED-ului albastru deasupra profilului activat.
- Deschide setarile Bluetooth pe dispozitivul tau si cauta "AQIRYS Zephyr Wireless Mouse" in lista de dispozitive disponibile.
- Selecteaza mouse-ul pentru conectare. Dupa ce s-a conectat, mouse-ul confirma pe OLED cu "Link OK".

5. Conectarea prin Modul 2.4 GHz:

- Pentru a realiza conexiunea prin modul 2.4 GHz, va rugam sa conectati transmitatorul 2.4 GHz furnizat in pachet la un port USB 2.0 disponibil pe dispozitivul dvs. sau puteti utiliza dock-ul inclus pentru a reduce distanta dintre receiver si mouse.
- Dupa realizarea conexiunii, transmitatorul 2.4 GHz va intra automat in modul Pairing.
- In urma acestei actiuni, mouse-ul si transmitatorul 2.4 GHz se vor conecta automat, fapt confirmat de mesajul afisat pe ecranul OLED integrat in **butonul 4**: "ReLink OK"

6. Comutarea modurilor de conectare:

- Mutati butonul de selectare al mouse-ului din pozitia curenta in **pozitia 7** pentru conectarea prin 2.4GHz sau in **pozitia 9** pentru Bluetooth, pentru a schimba modul de conectare. Ecranul OLED integrat in **butonul 4** va afisa modul de conectare selectat, fie "2.4G", fie "BT1" sau "BT2". Acest mouse suporta conectarea simultana la trei dispozitive, unul prin 2.4 GHz si doua prin Bluetooth.

Conectarea Mouse-ului Wireless

Wireless Mouse Connection

EN**1. Mouse Initialization:**

- Turn on the mouse by switching the button from **position 8 (OFF)** to **position 7 (2.4GHz)** or **position 9 (BT)** to select a connectivity mode.

2. Initial Connection:

- On the first use, you have the option to connect the mouse both to a Bluetooth device and to the wireless transmitter included in the package.

3. Connecting to a Bluetooth Device:

- Make sure the Bluetooth function of the device is activated.
- Look for "AQIRYS Zephyr Wireless Mouse" in the list of nearby Bluetooth devices and select it to connect.
- If the connection is successful, the message "Link OK" will be displayed on the OLED screen.

4. Connecting to a New Bluetooth Device:

- Check if the mouse is on the correct Bluetooth profile. Press **button 10** once briefly to switch the BT profile if needed.
- To enter pairing mode, hold down **button 10** for 5 seconds. See the active pairing mode on the OLED screen and through the blinking of the blue LED above the activated profile.
- Open the Bluetooth settings on your device and search for "AQIRYS Zephyr Wireless Mouse" in the list of available devices.
- Select the mouse for connection. After connecting, the mouse will confirm on the OLED with "Link OK".

5. Connecting via 2.4 GHz Mode:

- To connect via the 2.4 GHz mode, please connect the provided 2.4 GHz transmitter to an available USB 2.0 port on your device, or you can use the included dock to decrease the distance between the receiver and the mouse.
- After establishing the connection, the 2.4 GHz transmitter will automatically enter Pairing mode.
- Following this action, the mouse and the 2.4 GHz transmitter will automatically connect, as confirmed by the message displayed on the integrated OLED screen in **button 4**: "ReLink OK"

6. Switching Connectivity Modes:

- Move the mouse's selection button from the current position to **position 7** for 2.4GHz connection or to **position 9** for Bluetooth, to change the connectivity mode. The OLED screen integrated into **button 4** will display the selected connectivity mode, either "2.4G", "BT1", or "BT2". This mouse supports simultaneous connection to three devices, one through 2.4 GHz and two through Bluetooth.

Utilizari Ulterioare**Subsequent Connections****RO**

Dupa prima utilizare informatia de pairing va ramane salvata pe echipamentul dumnevoastra, iar conexiunile ulterioare intre transmitator si mouse se vor face automat.

EN

After the first use, the pairing information will remain saved on your equipment, and the subsequent connections between the receiver and the mouse will be made automatically.

Activare/Dezactivare Transmitator**Wireless Receiver Power On/Off****RO**

Transmitatorul este activat si dezactivat automat la conectarea si deconectarea sa la portul USB.

EN

The receiver is automatically turned on and off when connected and disconnected to the USB port.

Conectarea Mouse-ului cu fir**Wired Mouse Connection****RO**

Cand conectati mouse-ul prin cablu, acesta va intra automat in modul de conectare USB, confirmat de mesajul "Link OK! USB" afisat pe ecranul OLED integrat in butonul de DPI nr. 4. In timpul utilizarii pe fir, mouse-ul isi incarca si bateria integrata, fapt indicat prin mesajul "Charging" afisat pe acelasi ecran OLED. Odata conectat in modul USB, mouse-ul dezactiveaza functiile wireless 2.4GHz sau Bluetooth pentru a optimiza utilizarea si performanta.

EN

When you connect the mouse via cable, it will automatically enter USB connection mode, confirmed by the "Link OK! USB" message displayed on the OLED screen integrated in DPI button no. 4. While using the wired connection, the mouse also charges its integrated battery, indicated by the "Charging" message displayed on the same OLED screen. Once connected in USB mode, the mouse disables the wireless 2.4GHz or Bluetooth functions to optimize usage and performance.

Deconectare si Reconectare Automata**Auto Disconnect and Reconnect****RO**

Daca mouse-ul nu este folosit, intra in modul de economisire energie dupa 30 de secunde. Daca ramane inactiv timp de 10 minute, intra in modul deep sleep. Pentru a-l reactiva, miscati mouse-ul sau apasati orice buton principal.

EN

If the mouse is not used, it enters energy-saving mode after 30 seconds. If it remains inactive for 10 minutes, it enters deep sleep mode. To reactivate it, move the mouse or press any main button.

Iluminarea RGB Dock**Dock RGB Illumination****RO**

Pentru a schimba modul de iluminare al dock-ului de incarcare inclus in pachet, aveti doua optiuni. Puteti utiliza functia touch situata la baza dock-ului, indicata cu **numarul 12** in prezentare, sau puteti apasa butonul **numarul 13** situat in partea inferioara a dock-ului. Ambele optiuni va permit sa schimbati modul de iluminare dupa preferintele dvs.

EN

To change the lighting mode of the included charging dock, you have two options. You can use the touch function located at the base of the dock, indicated as number 12 in the presentation, or you can press button number 13 located at the bottom of the dock. Both options allow you to adjust the lighting mode according to your preferences.

Nivelul Bateriei**Battery Level****RO**

Pe ecranul OLED integrat in butonul 4, puteti verifica nivelul bateriei.

Nota: Cand mouse-ul este pornit, va afisa pe ecranul OLED nivelul bateriei 100%, dupa 5 secunde o sa fie afisat nivelul actual al bateriei.

EN

On the OLED screen integrated in button 4, you can check the battery level.

Note: When the mouse is turned on, it will display the battery level as 100% on the OLED screen, and after 5 seconds, the actual battery level will be displayed.

Incarcarea Bateriei**Battery Charging****RO**

Pentru a incarca bateria mouse-ului, aveti doua optiuni disponibile. In primul mod, puteti lasa mouse-ul pe dock-ul de incarcare, insa nu puteti utiliza mouse-ul in timp ce acesta se incarca. Timpul aproximativ de incarcare de la 0 la 100% este de 2 ore. In al doilea mod, puteti conecta mouse-ul in modul cu fir. Pentru aceasta, trebuie sa conectati mouse-ul la firul USB Type-C furnizat in pachet si sa introduceti firul intr-un port USB disponibil pe dispozitivul dvs. Timpul aproximativ de incarcare de la 0 la 100% este de 50 de minute.

EN

To charge the mouse battery, you have two available options. In the first mode, you can leave the mouse on the charging dock, but you cannot use the mouse while it is charging. The approximate charging time from 0 to 100% is 2 hours. In the second mode, you can connect the mouse in wired mode. For this, you need to connect the mouse to the provided USB Type-C cable and insert the cable into an available USB port on your device. The approximate charging time from 0 to 100% is 50 minutes.

Recomandari**Recommendation****RO**

1. Inainte de prima utilizare recomandam rularea unui ciclu complet de incarcare a bateriei.
2. Pentru incarcarea bateriei puteti folosi incarcatoare 5V/1A sau 5V/2A; voltaje mai mari pot duce la defectarea produsului.
3. Daca au trecut mai mult de 3 luni de la ultima utilizare a mouse-ului va rugam sa il incarcati inainte de folosire.
4. Daca nu folositi mouse-ul pentru o perioada mai lunga de timp recomandam rularea unui ciclu complet de incarcare a bateriei o data la 3 luni pentru conservarea acesteia.

EN

1. Before the first use, we recommend running a complete battery charge cycle.
2. You can use 5V / 1A or 5V / 2A chargers to charge the battery; higher voltages can damage the product.
3. If more than 3 months have passed since the last use of the mouse, please charge the battery before use.
4. If you do not use the mouse for an extended time, we recommend running a complete charge cycle of the battery every 3 months to preserve it.

Atasarea gripurilor

Button and side grips

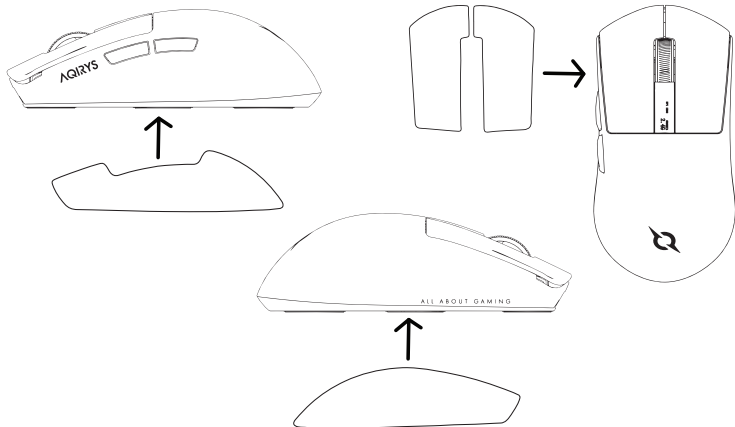

Inlocuirea patinelor

Skates replacement

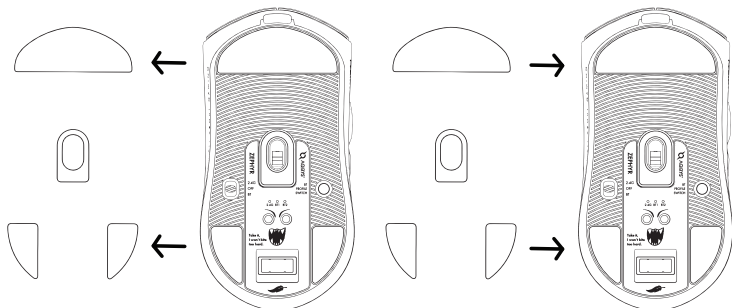

Atentionari**Warnings****RO**

1. Asigurati-va ca mouse-ul este utilizat in medii cu temperaturi normale si evitati expunerea directa la razele solare.
2. Nu expuneti mouse-ul la foc sau la obiecte fierbinti.
3. Mentineti mouse-ul uscat si evitati expunerea la medii umede. Nu scufundati mouse-ul in lichid.
4. Folositi doar cablul USB furnizat in pachet pentru incarcare. Nu incercati alte metode de incarcare.
5. Nu dezasamblati, reparati sau modificati mouse-ul.
6. In cazul deteriorarilor fizice, cum ar fi indoirea, deformarea sau coroziunea, contactati service-ul autorizat.
7. Daca intampinati alte probleme, cum ar fi degajarea unui miros anormal, o temperatura foarte ridicata in timpul utilizarii sau schimbari anormale de culoare sau forma, opriti imediat utilizarea mouse-ului si contactati service-ul autorizat.
8. Acest produs nu este o jucarie. Copiii cu varsta mai mica de 14 ani pot utiliza produsul sub supravegherea parintilor.

EN

1. Make sure the mouse is used in environments with normal temperatures and avoid direct exposure to sunlight.
2. Do not expose the mouse to fire or hot objects.
3. Keep the mouse dry and avoid exposure to humid environments. Do not submerge the mouse in liquid.
4. Use only the USB cable provided in the package for charging. Do not attempt other charging methods.
5. Do not disassemble, repair, or modify the mouse.
6. In case of physical damage, such as bending, deformation, or corrosion, contact the authorized service center.
7. If you encounter other issues, such as unusual odors, very high temperatures during use, or abnormal changes in color or shape, immediately stop using the mouse and contact the authorized service center.
8. This product is not a toy. Children under the age of 14 should use the product under parental supervision.

REGLEMENTARI**REGULATORY**

- Unauthorized repairs or disassembly of the product will void the warranty and may cause its damage.
- This product is safe and complies to EU requirements. (compliant with directive EMC (2014/30/EU))
- This product is manufactured conforming with the European RoHS standard. (compliant with directive RoHS 2.0 (2015/863/EU))
- Using the WEEE symbol (the crossed-out bin) indicates that the electrical and electronic equipment inside the package can be recycled. When recycling waste properly, you protect the environment and people health. Segregated household waste collection, aids recycle materials and components used for the production of this device. For detailed information about recycling, please contact your retailer or a local authority.
- The batteries must not be disposed of with your other household waste; treat them in compliance with the local regulations or contact your local city office, your household waste disposal service, or the shop where you purchased the product.
- Frequency bands and Powers (Headset and Transceiver)
 - a. Frequency band(s) in which the radio equipment operates:
 - WiFi: 2402 – 2480 MHz
 - b. Maximum radio-frequency power transmitted in the frequency band(s) in which the radio equipment operates:
 - GFSK, PI/4 DQPSK, 8DPSK: 10 dBm
- Reparațiile neautorizate sau dezasambarea produsului duc la anularea garanției și pot cauza deteriorarea lui.
- Produsul este unul sigur, conform cu cerințele UE. (respecta directiva EMC (2014/30/EU))
- Acest produs este fabricat în concordanță cu standardul european RoHS. (respecta directiva RoHS 2.0 (2015/863/EU))
- Utilizarea simbolului WEEE (pubea tăiată cu un X) indică faptul că echipamentele electrice și electronice din interiorul ambalajului pot fi reciclate. Când reciclați deseurile în mod corespunzător protejați mediul înconjurător. Colectarea selectivă ajută la reciclarea materialelor și componentelor folosite la fabricarea acestui echipament. Pentru informații detaliate privind reciclarea, vă rugăm să contactați vânzătorul sau autoritățile locale.
- Bateriile nu trebuie aruncate împreună cu celelalte deseuri menajere; tratați-le în conformitate cu reglementările locale sau contactați biroul local al orașului, serviciul de eliminare a deșeurilor menajere sau magazinul de unde ați achiziționat produsul.
- Les réparations non autorisées ou le désassemblage du produit portent à l'annulation de la garantie et peuvent causer son endommagement.
- Le produit est sûr, conformément aux exigences de l'UE. (respecte la directive EMC (2014/30 / UE))
- Ce produit est fabriqué conformément à la norme européenne RoHS. (respecte la directive RoHS 2.0 (2015/863/EU))
- L'utilisation du symbole DEEE (poubelle barrée d'une croix) indique que les équipements électriques et électroniques de l'intérieur de l'emballage peuvent être recyclés. Lorsque vous recyclez correctement les déchets, vous protégez l'environnement. La collecte sélective aide au recyclage des matériaux et des composants utilisés à la fabrication de cet équipement. Pour obtenir des informations détaillées sur le recyclage, veuillez contacter le vendeur ou les autorités locales.
- Les piles ne doivent pas être jetées avec les autres déchets ménagers ; traitez-les conformément aux réglementations locales ou contactez votre mairie, votre service d'élimination des déchets ménagers ou le magasin où vous avez acheté le produit.
- Nicht autorisierte Reparaturen oder Demontagen des Produkts führen zur Löschung der Garantie und möglicherweise zur Beschädigung des Produktes.
- Das Produkt ist nach den Anforderungen der EU sicher. (EMV Verordnung (2014/30/UE))
- Dieses Produkt wird gemäß der europäischen RoHS-Norm hergestellt. (RoHS Verordnung 2.0 (2015/863/EU))
- Die Verwendung des WEEE-Symbols (mit einem X durchgestrichene Tonne) zeigt an, dass die elektrischen und elektronischen Geräte in der Verpackung recycelt werden können. Wenn Sie Abfälle ordnungsgemäß recyceln, tragen Sie zum Umweltschutz bei. Die Abfalltrennung hilft beim Recycling von Materialien und Bauteilen, die bei der Herstellung dieser Geräte verwendet werden. Ausführliche Informationen zum Recycling erhalten Sie von Ihrem Händler oder den örtlichen Behörden.
- Die Batterien dürfen nicht mit dem Hausmüll entsorgt werden, sondern müssen gemäß den örtlichen Vorschriften behandelt werden. Wenden Sie sich an Ihre Stadtverwaltung, Ihren Hausmüllentsorgungsdienst oder an das Geschäft, in dem Sie das Produkt gekauft haben.
- Le riparazioni non autorizzate o lo smontaggio del prodotto portano all'annullamento della garanzia e possono causare il suo danneggiamento
- Il prodotto è sicuro, in conformità ai requisiti dell'UE (rispetta la direttiva EMC (2014/30/UE))
- Questo prodotto è fabbricato in conformità alla norma europea RoHS. (rispetta la direttiva RoHS 2.0 (2015/863 / EU))
- L'uso del simbolo WEEE (cestino tagliato da una croce) indica che le apparecchiature elettriche ed elettroniche trovate all'interno della confezione possono essere riciclate. Quando riciclate i rifiuti in maniera adeguata, proteggete l'ambiente. La raccolta selettiva aiuta a riciclare i materiali e i componenti utilizzati per la fabbricazione di questa attrezzatura. Per informazioni dettagliate sul riciclaggio, contattate il venditore o le autorità locali.
- Le batterie non devono essere smaltite insieme agli altri rifiuti domestici; trattatele in conformità alle normative locali o contattate l'ufficio comunale, il servizio di smaltimento dei rifiuti domestici o il negozio dove avete acquistato il prodotto.
- Neoprávňné opravy alebo demontáž výrobku vedú ke zrušeniu záruky a môžu spôsobiť jeho poškodenie.
- Jedná sa o bezpečný výrobok v súlade s požiadavkami EÚ. (rešpektuje smernicu o EMC (2014/30/EU))
- Tento produkt je vyroben v súlade s evropskou normou RoHS. (je v súlade so smernicou RoHS 2.0 (2015/863/EU))
- Použití symbolu WEEE (odpadkový koš, který je přeškrtnutý s X) naznačuje, že elektrická a elektronická zařízení z vnitřku balení jsou vhodná k recyklaci. Pokud řádně recyklujete odpady, chráníte životní prostředí. Selektivní sběr pomáhá recyklovat materiály a komponenty používané při výrobě tohoto zařízení. Za podrobné informace o recyklaci, kontaktujte prosím prodejce nebo místní úřady.
- Baterie se nesmí likvidovat společně s ostatním domovním odpadem; nakládejte s nimi v souladu s místními předpisy nebo se obraťte na místní obecní úřad, službu likvidace domovního odpadu nebo na obchod, kde jste výrobek zakoupili.



REGLEMENTARI

REGULATORY

- Neoprávnéné opravy alebo demontáž výrobku vedú k zrušeniu záruky a môžu spôsobiť jeho poškodenie.
- Jedná sa o bezpečný výrobok v súlade s požiadavkami EÚ. (Rešpektuje smernicu o EMC (2014/30/EU))
- Tento produkt je vyrobený v súlade s európskou normou RoHS. (splňa smernicu RoHS 2.0 (2015/863 / EU))
- Použitie symbolu WEEE (odpadkový kôš, ktorý je preškrtnutý s X) naznačuje, že elektrické a elektronické zariadenia z vnútra balenia sú vhodné na recykláciu. Ak riadne recyklujete odpad, chránite životné prostredie. Selektívny zber pomáha recyklovať materiály a komponenty používané pri výrobe tohto zariadenia. Za detailné informácie o recyklácii, kontaktujte prosím predajcu alebo miestne úrady.
- Batérie sa nesmú likvidovať spolu s ostatným domovým odpadom; zaobchádzajte s nimi v súlade s miestnymi predpismi alebo sa obráťte na miestny mestský úrad, službu likvidácie domového odpadu alebo obchod, v ktorom ste výrobok zakúpili.
- Neovláčené opravy alebo tvarenie výrobku vedú k anulovaniu garancie a môžu viesť do oštiepenia ureada.
- Proizvod jeste bezbedan, u skladu sa zahtevima EU. (poštuj direktivu EMC (2014/30/EU).
- Ovaj proizvod proizveden je u skladu sa evropskim standardom ROHS (odnosno direktiva ROHS 2.0. (2015/863/EU).
- Uputreba simbola WEEE (kanta isečena sa X) pokazuje činjenicu da sve električne i elektrotehničke opreme iz ambalaže mogu biti reciklirani. Kada vršite reciklažu otpada na odgovarajući način štite životnu sredinu. Selektivna kolekcija pomaže u reciklažu materijala i komponenta upotrebljenih u proizvodnji opreme. Za detaljne informacije u odnosu na reciklažu, molimo vas da stupite u kontaktu sa vašim proizvođačem ili lokalnim vlastima.
- Baterije se ne smeju odlagati sa ostalim kućnim otpadom; postupaite sa njima u skladu sa lokalnim propisima ili se obratite lokalnoj gradskoj kancelariji, službi za odlaganje kućnog otpada ili prodavnici u kojoj ste kupili proizvod.
- Μη εξουσιοδοτημένες επιδιορθώσεις ή αποσυναρμολόγηση του προϊόντος επιφέρουν ακύρωση της εγγύησης και μπορούν να προκαλέσουν την αλλοίωση του.
- Το προϊόν είναι ασφαλέ, σε συμμόρφωση με τις απαιτήσεις της Ε.Ε. (συγκεκριμένα την οδηγία EMC (2014/30/EU)
- Αυτό το προϊόν κατασκευάζεται σύμφωνα με το ευρωπαϊκό πρότυπο RoHS. (συγκεκριμένα την οδηγία RoHS 2.0 (2015/863/EU).
- Η χρήση του συμβόλου WEEE (διαγραφμένο κάδος απορριμάτων με ένα X) υποδεικνύει πως ο ηλεκτρικός και ηλεκτρονικός εξοπλισμός του εσωτερικού του αμπαλαζή μπορούν να ανακυκλωθούν. Όταν ανακυκλώνεται τα αποβλήτα με αποδοτικό τρόπο προστατεύεται τον περιβάλλον. Η επλεκτική συλλογή βοηθά στην ανακύκλωση των υλικών και εξαρτημάτων που χρησιμοποιούνται στην παραγωγή αυτού του εξοπλισμού. Για λεπτομερείς πληροφορίες σχετικά με την ανακύκλωση, παρακαλούμε να επικοινωνήσετε με τον πωλητή ή τις τοπικές αρχές.
- Οι μπαταρίες δεν πρέπει να απορριπτονται μαζί με τα υπόλοιπα οικιακά απορρίματα. Αντιμετωπίστε τις σύμφωνα με τους τοπικούς κανονισμούς ή επικοινωνήστε με το τοπικό δημόσιο γραφείο, την υπηρεσία απόρριψης οικιακών απορριμάτων ή το κατάστημα από το οποίο αγοράσατε το προϊόν.
- Неотризираните ремонтни работи или разглобяването на продукта водят до нищожество на гарацията и могат да доведат до неговата повреда.
- Продуктът е само една бройка, в съответствие с изискванията на ЕС. (Спазва разпореденията на Директивата EMC (2014/30/EC))
- Този продукт е произведен в съответствие с европейския стандарт RoHS. (Съответстваща Директива RoHS 2.0 (2015/863/EC))
- Отбелязаното на символа WEEE (зачеркната с X кофа за отпадъци) посочва факта, че електрическите и електронните устройства в опаковката могат да се рециклират. При надлежно рециклиране, опазвате околната среда. Разделното събиране на отпадъците помага за рециклирането на употребяваните материали и съставки за изработване на това устройство. За подробни информации относно рециклирането, молим Ви да се свържете с продавача на устройството или местните власти.
- Батериите не трябва да се извървят заедно с другите битови отпадъци; третирайте ги в съответствие с местните разпоредби или се обърнете към местната общинска администрация, службата за извървяне на битови отпадъци или към магазина, в който сте закупили продукта.
- Nieautoryzowane naprawy lub demontaż produktu spowodują utratę gwarancji i mogą spowodować jego uszkodzenie.
- Produkt bezpieczny, zgodny z wymogami UE. (przestrzega dyrektywy EMC (2014/30 / UE))
- Ten produkt został wyprodukowany zgodnie z europejską normą RoHS. (odpowiednio dyrektywę RoHS 2.0 (2015/863 / UE)
- Użycie symbolu WEEE (kosz na śmieci z X) oznacza, że sprzęt elektryczny i elektroniczny wewnątrz opakowania można poddać recyklingowi. Poprzez prawidłowy recykling odpadów chronisz środowisko. Selektywna zbiórka pomaga w recyklingu materiałów i komponentów użytych do produkcji tego sprzętu. Aby uzyskać szczegółowe informacje dotyczące recyklingu, skontaktuj się ze sprzedawcą lub lokalnymi władzami.
- Baterie nie mogą być wyrzucane z innymi odpadami domowymi; należy je traktować zgodnie z lokalnymi przepisami lub skontaktować się z lokalnym urzędem miasta, służbą utylizacji odpadów domowych lub sklepem, w którym zakupiono produkt.
- A termék nem szakszerű javítása vagy a termék alkatrészekre való bontása a garancia eltérését jelenti és ugyanakkor a termék sérülését is előidézheti.
- A termék biztonságos, gyártása EU-s normáknak megfelelő. (EMC/2014/30/EU)
- A termék gyártása az európai RoHS standard normatíváknak megfelelő (RoHS 2.0 (2015/863/EU)
- A WEEE szimbólum (áthúzott kuka szimbólum) jelzi, hogy a csomagban található elektromos és elektronikus alkatrészek újrahasznosíthatók. A hulladék megfelelő újrahasznosításával védi környezetet. A selektív hulladékgyűjtéssel hozzájárul ezen termék gyártásához használt anyagok és alkatrészek újrahasznosításához. Bővebb tájékoztatásért kérjük igényelje a részleteket a forgalmazóval vagy a helyhatósági szervek képviselőitől.
- Az akkumulátorokat nem szabad a többi háztartási hulladékkal együtt ártalmatlanítani; kezelje azokat a helyi előírásoknak megfelelően, vagy forduljon a helyi városi hivatalhoz, a háztartási hulladékezelőhöz vagy ahhoz az üzlethez, ahol a terméket vásárolta.



SUPPORT

SUPPORT

- RO** Daca intampinati erori sau orice alte probleme in utilizarea produsului nu ezitati sa ne contactati.
- EN** If you encounter errors or any other problems with the product don't hesitate to contact us.



support@aqirys.com

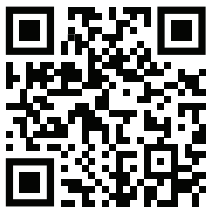

SCAN ME
(product page)

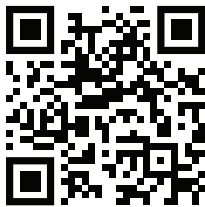

SCAN ME
(Follow us)

© AQIRYS®. All rights reserved. AQIRYS® name and logo and all other related products, service names, and design marks are trademarks or registered trademarks of PC-coolers SRL. All other brand names and trademarks are the property of their respective owners. Specifications and design are subject to change without notice due to product improvements.

Ovaj dokument je originalno proizveden i objavljen od strane proizvođača, brenda AQIRYS, i preuzet je sa njihove zvanične stranice. S obzirom na ovu činjenicu, Tehnoteka ističe da ne preuzima odgovornost za tačnost, celovitost ili pouzdanost informacija, podataka, mišljenja, saveta ili izjava sadržanih u ovom dokumentu.

Napominjemo da Tehnoteka nema ovlašćenje da izvrši bilo kakve izmene ili dopune na ovom dokumentu, stoga nismo odgovorni za eventualne greške, propuste ili netačnosti koje se mogu naći unutar njega. Tehnoteka ne odgovara za štetu nanесenu korisnicima pri upotrebi netačnih podataka. Ukoliko imate dodatna pitanja o proizvodu, ljubazno vas molimo da kontaktirate direktno proizvođača kako biste dobili sve detaljne informacije.

Za najnovije informacije o ceni, dostupnim akcijama i tehničkim karakteristikama proizvoda koji se pominje u ovom dokumentu, molimo posetite našu stranicu klikom na sledeći link:

<https://tehnoteka.rs/p/aqirys-bezicni-mis-zephyr-white-akcija-cena/>