

Uputstvo za upotrebu (EN)

ENERGY SISTEM slušalice Style 4 Ultra Space crne

ENERGY  SISTEM



Tehnoteka je online destinacija za upoređivanje cena i karakteristika bele tehnike, potrošačke elektronike i IT uređaja kod trgovinskih lanaca i internet prodavnica u Srbiji. Naša stranica vam omogućava da istražite najnovije informacije, detaljne karakteristike i konkurentne cene proizvoda.

Posetite nas i uživajte u ekskluzivnom iskustvu pametne kupovine klikom na link:

<https://tehnoteka.rs/p/energy-sistem-slusalice-style-4-ultra-space-crne-akcija-cena/>

ENGLISH

| | |
|---|----|
| Introduction | 4 |
| Care and maintenance | 4 |
| Warning | 4 |
| Hearing protection | 4 |
| Safety | 4 |
| Technical specifications | 5 |
| Audio | 5 |
| Connectivity | 5 |
| Microphone | 5 |
| Battery | 5 |
| Product content | 6 |
| General overview | 6 |
| Switching on and off the device | 7 |
| Bluetooth® pairing | 7 |
| ESmart Connect app | 7 |
| Setting up your account | 7 |
| Pairing the earphones | 9 |
| Manual pairing (alternative method) | 12 |
| Customising the product with ESmart Connect App | 14 |
| Equalizer | 14 |
| Have you lost your device? (Find my earbuds) | 18 |
| Custom control | 19 |
| Proximity sensor (exclusive to Earphones Style 4 Ultra) | 20 |
| Renaming the device | 21 |
| Default settings | 23 |
| Play/Pause | 23 |
| Volume +/Volume - | 23 |
| Skipping to the next/previous track | 23 |
| Call control | 23 |
| Answering/Ending a call | 23 |
| Using the Voice Assistant feature | 23 |
| Charging the battery | 23 |
| Earphones | 23 |
| Charging case | 23 |
| Wireless charging case | 23 |
| Restoring default settings | 24 |
| FAQ / Troubleshooting | 24 |
| I can't link the earphones to the ESmart Connect app. | 24 |
| Warranty | 24 |

ENERGY♥SYSTEM



style4 ultra

Manual de usuario / User manual
Manual de l'utilisateur / Manual do usuário

Introduction

Thank you for trusting our company and buying the new *Earphones True Wireless Style 4 Ultra*. We hope you enjoy the product.

Care and maintenance

- Do not expose your *Earphones True Wireless Style 4 Ultra* to impacts, dust, humidity or high temperatures.
- Use neither corrosive nor abrasive cleaning products.
- Do not disassemble the device. All repair works should be carried out exclusively by qualified staff of Energy Sistem Technology, S.A.
- Make sure your *Earphones True Wireless Style 4 Ultra* are off when you are not using them. Do not store them with an empty battery for long periods of time.
- You can clean the earbuds' external surface and charging connectors with a clean cloth and hand sanitiser. Do not use these products to clean the ear tips or the internal mesh of the earphones. Avoid getting the charging ports and connectors wet.

Note: After every workout session, we recommend thoroughly drying the earphones before putting them back in the case.

Warning

Hearing protection

Listening to loud music can cause irreversible hearing loss. To avoid hearing damage, we recommend the following guidelines:

- Do not listen to loud music for long periods of time.
- Turn the volume down on the source device before using the earphones, then gradually increase the volume to a safe volume level.

Safety

For safety reasons and to avoid possible accidents, we recommend the following safety measures:

- Do not use the earphones while driving or carrying out any other activity that requires special attention.
- Keep the product, packaging and accessories out of the reach of children and pets to avoid accidents and choking hazard.

Technical specifications

Audio

- Frequency response: 20 Hz ~ 20 kHz
- Driver diameter: 10 mm
- Earbud design
- Type: dynamic

Connectivity

- Bluetooth® 5.3 (class 2) wireless technology.
- Frequency band: 2.4 GHz
- Maximum output power: < 20.00 dBm
- Compatible Bluetooth profiles: HSP / HFP / A2DP / AVRCP
- Compatible with SBC codecs
- Up to 20 m distance range
- True Wireless function with auto-pairing
- Hands-free function
- Voice assistant compatible with Google/Siri

Microphone

- Type: built-in microphone
- Sensitivity: -42 dB ± 3 dB (@1 kHz)
- Frequency range: 100 Hz ~ 10 kHz

Battery

Earbud:

- Capacity: 30 mAh / 3.7 V
 - Type: lithium-polymer battery
 - Battery life at medium volume: 5 hours
 - Charging time: 1.5 hours
 - Charging method: charging case
- This value is approximate. The battery life depends on the selected volume and type of music.

Charging case:

- Capacity: 400 mAh / 3.7 V
- Type: lithium-polymer battery
- Extra battery life: 20 hours
- Charging time (cable): 1.5 hours
- Charging time (charging pad): 4 hours
- Charging method: USB Type-C and Qi compatible wireless charging

Charging pad:

- Power: 10 W
- Quick charge

Other features:

- Proximity sensor to control music playback
- ESmart Connect App compatible

Product content

- Earphones True Wireless Style 4 Ultra
- Wireless charging case
- Wireless charger
- USB Type-C cable
- Quick guide

General overview

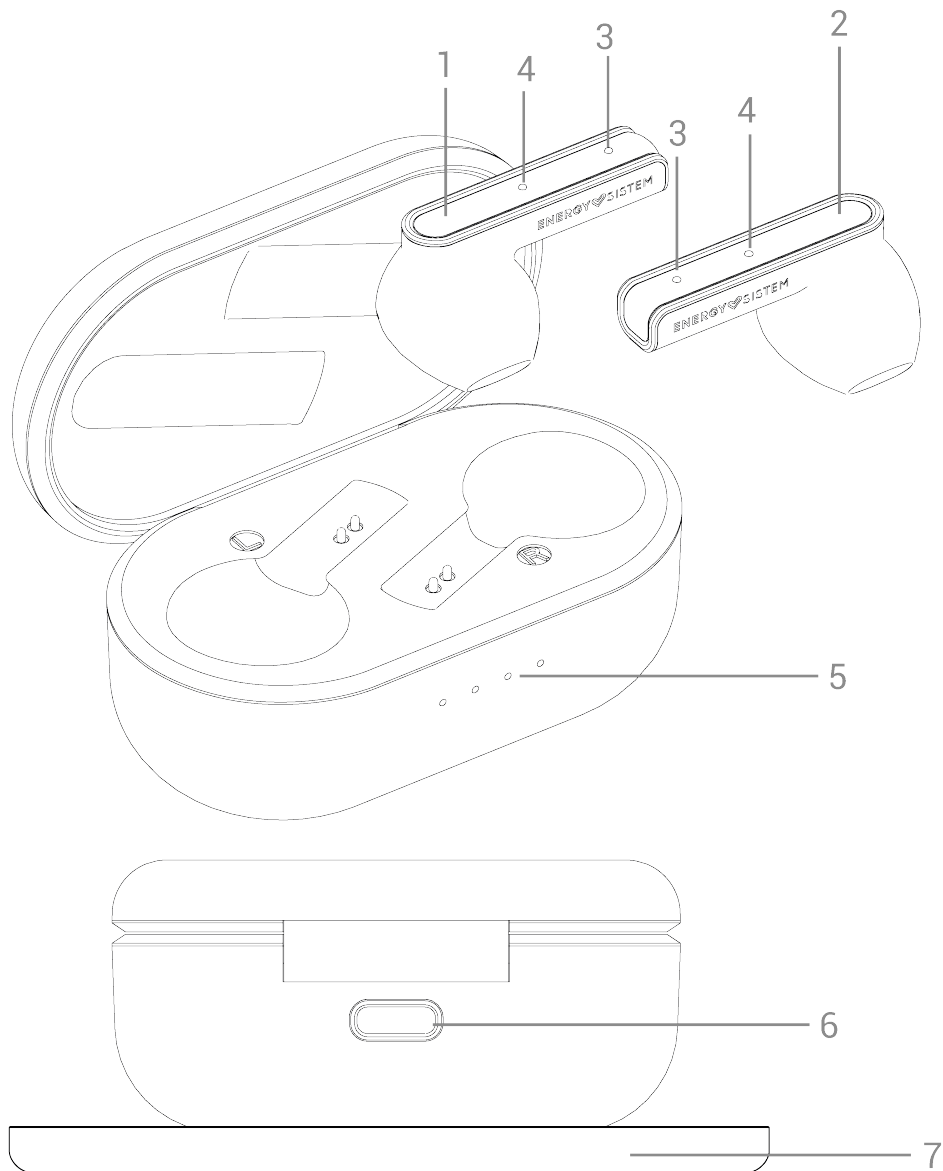

1. Left multifunction button
2. Right multifunction button
3. Microphone
4. Status LED
5. Charging indicator (charging case)
6. USB Type-C charging port
7. Qi charging pad

Switching on and off the device

To switch on your *Earphones True Wireless Style 4 Ultra*, simply take them out of the charging case or tap and hold the *Left and Right multifunction buttons (1 and 2)* for 10 seconds. You will hear a confirmation sound. Both earbuds sync automatically.

To switch off your *Earphones True Wireless Style 4 Ultra*, put them back in the charging case or tap and hold the *Left and Right multifunction buttons (1 and 2)* for 10 seconds.

Bluetooth® pairing

Switch on your *Earphones True Wireless Style 4 Ultra*. Both earbuds sync automatically. Select *Earphones True Wireless Style 4 Ultra* from the list of Bluetooth devices on your smartphone or Bluetooth music player and press "connect". Both earbuds will pair with it immediately and without codes. You will hear a confirmation sound when the devices are paired.

If you previously paired the earbuds with a device, there is no need to repeat the pairing process. Just enable Bluetooth mode on your music player and switch on your *Earphones True Wireless Style 4 Ultra*. They will sync with it automatically.

ESmart Connect app

Before getting started you will need to download the *ESmart Connect* app to your Android device from Google Play, or from the App Store for iOS. This will let you set up and manage your *Earphones True Wireless Style 4*.

NOTE: If the app does not appear in your Play Store, you will have to download it directly using this link [here](#) .



ESmart Connect
Energy Sistem



Setting up your account

- 1) After installing and opening the app, tap to accept the "User Agreement and Privacy Policy".
- 2) Go to the next page, tap on Sign Up, and enter your phone number or email to register and get the verification code.
- 3) Enter the verification code and set the password to register and log in.

12:45



Log In

Sign Up

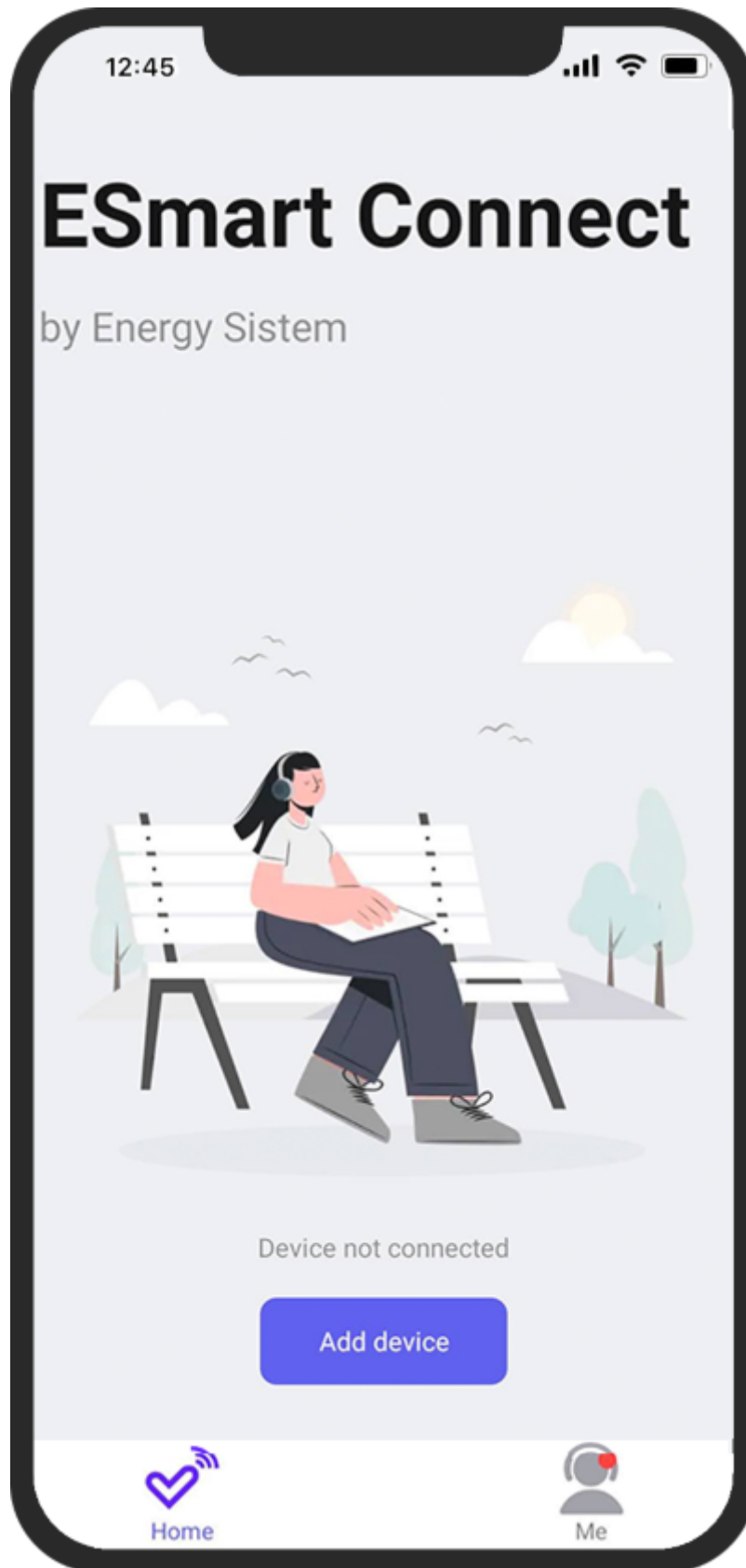

In the user profile, you can change your profile picture, nick and time zone (the app automatically selects your device's time zone).

You can also manage your configured devices, receive app notifications, see the FAQs, and make comments or suggestions for our customer service team.

Pairing the earphones

Important: Before pairing or connecting the headset to the application, you need to have your phone's GPS enabled.

Note: *For operating system security reasons, the earphones must be connected manually via Bluetooth® connection in the phone's Bluetooth functions menu when using iOS devices. If this is not the case, the earphones will not be able to connect to the app.

Almost all Android devices support "one-click configuration", and will connect to the earphones directly via Bluetooth® connection using ESmart Connect. Otherwise you will need to pair the earphones to your device manually via Settings > Bluetooth.

On the app home screen, tap the "Add device" button to start the automatic search. When your Earphones Style 4 are shown, tap the Add button to download the menu for the model (Earphones Style 4). Tap on the *Done* button when the model interface has finished downloading.

The product interface will appear, showing a pop-up window to pair the earphones with the phone.

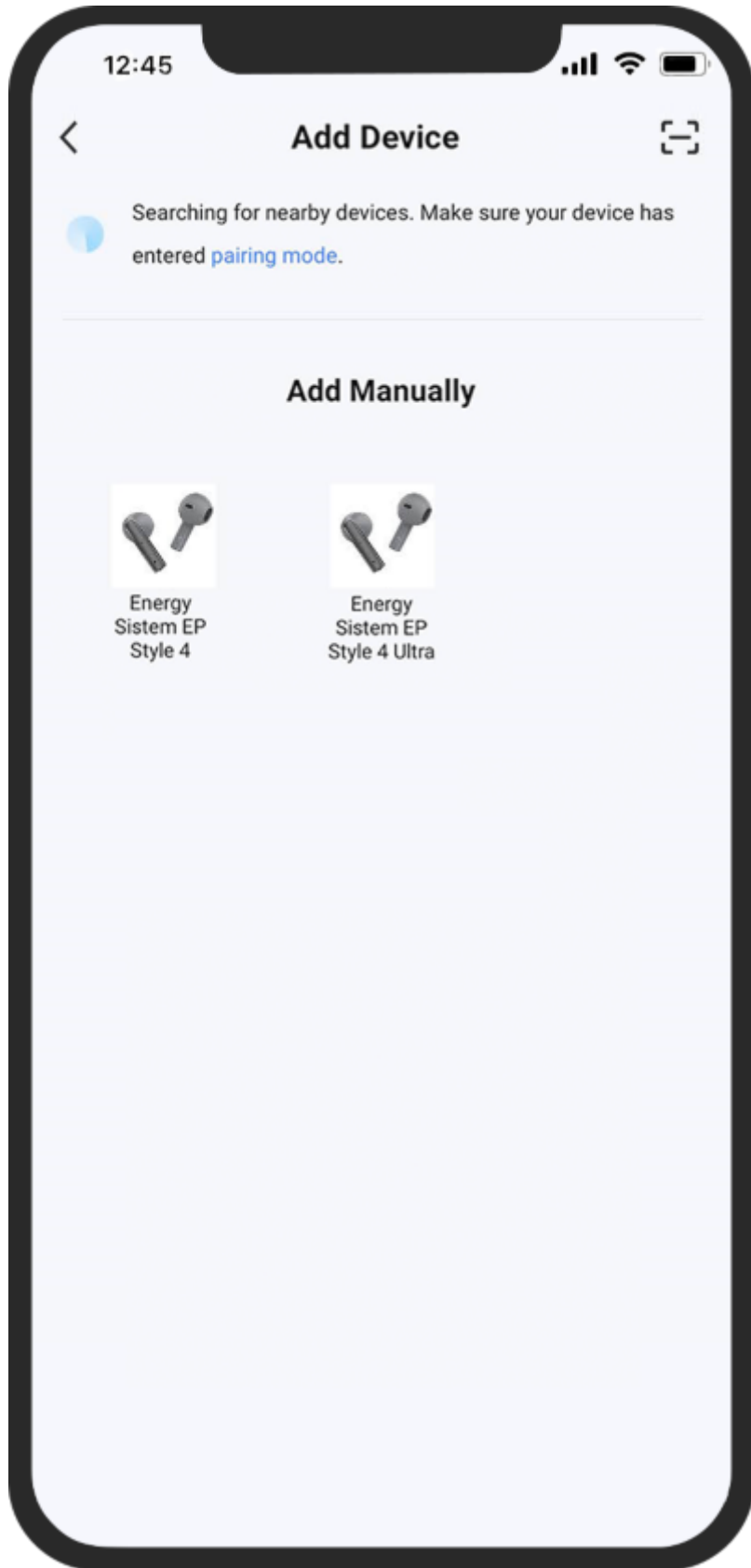

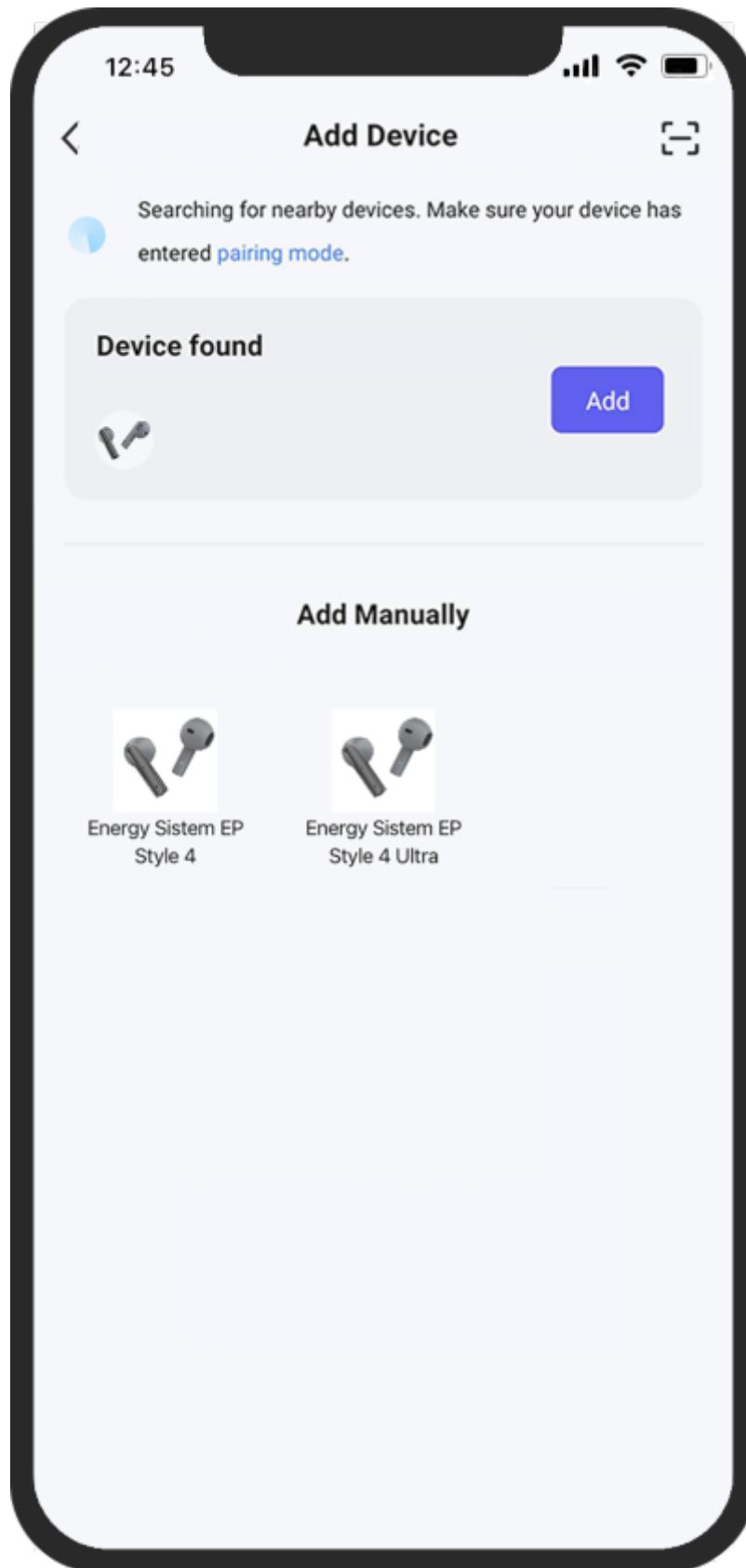

Manual pairing (alternative method)

There is an alternative method for manually pairing your earphones. To do so, select "Add" and follow the app's instructions for manual pairing.

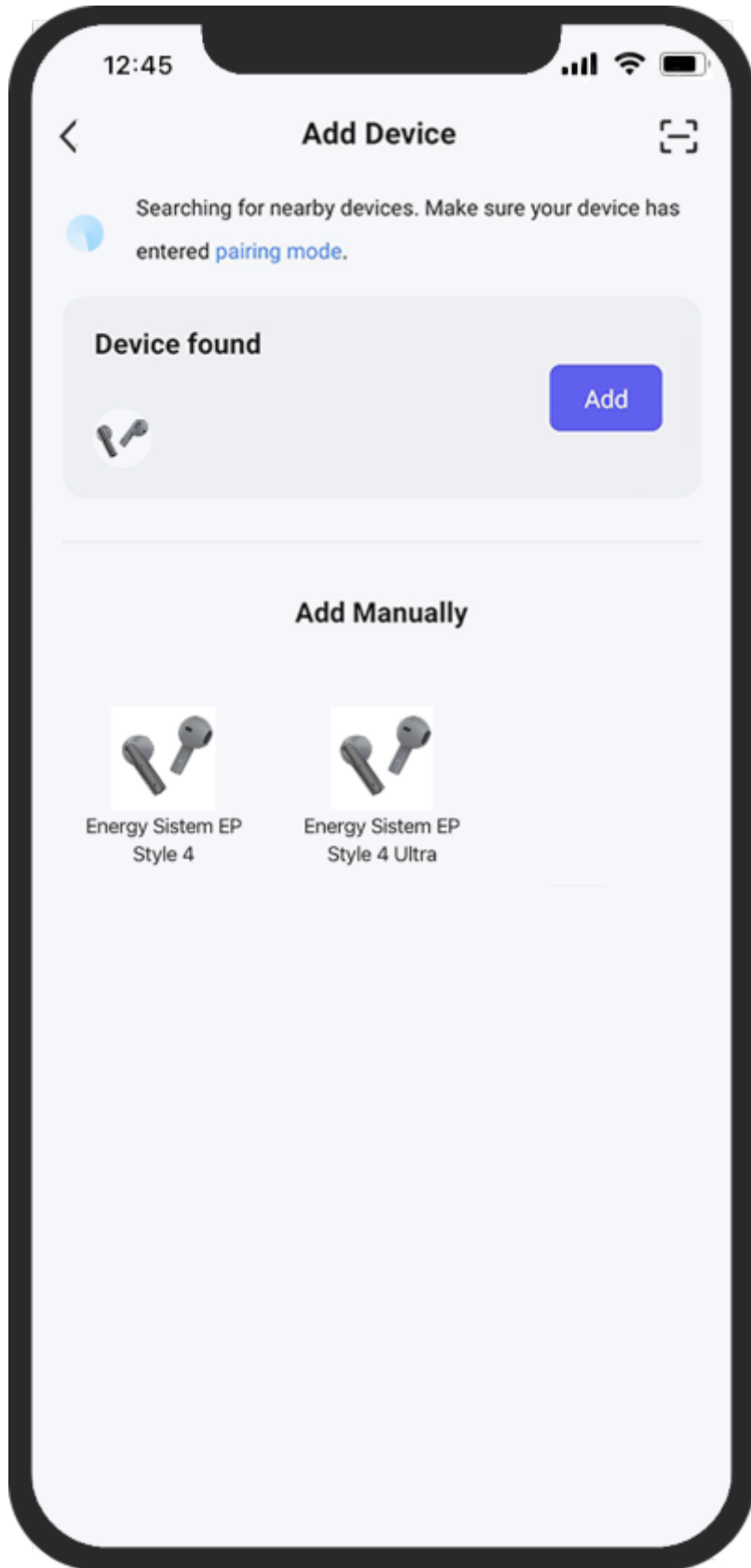

Finally, both automatic and manual pairing add your earphones to the application.

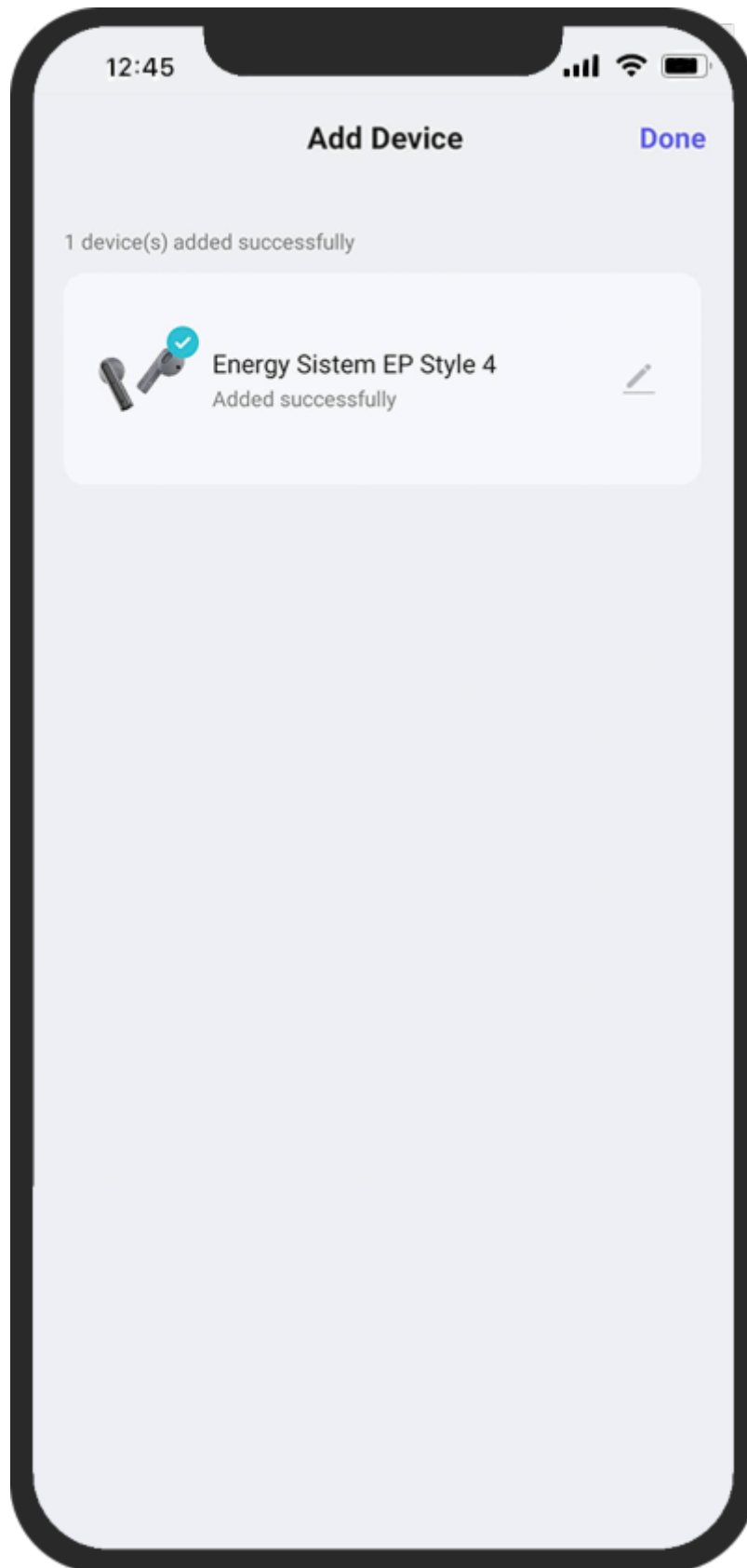

Customising the product with ESmart Connect App

Equalizer

The equalizer can be enabled or disabled from the home screen.

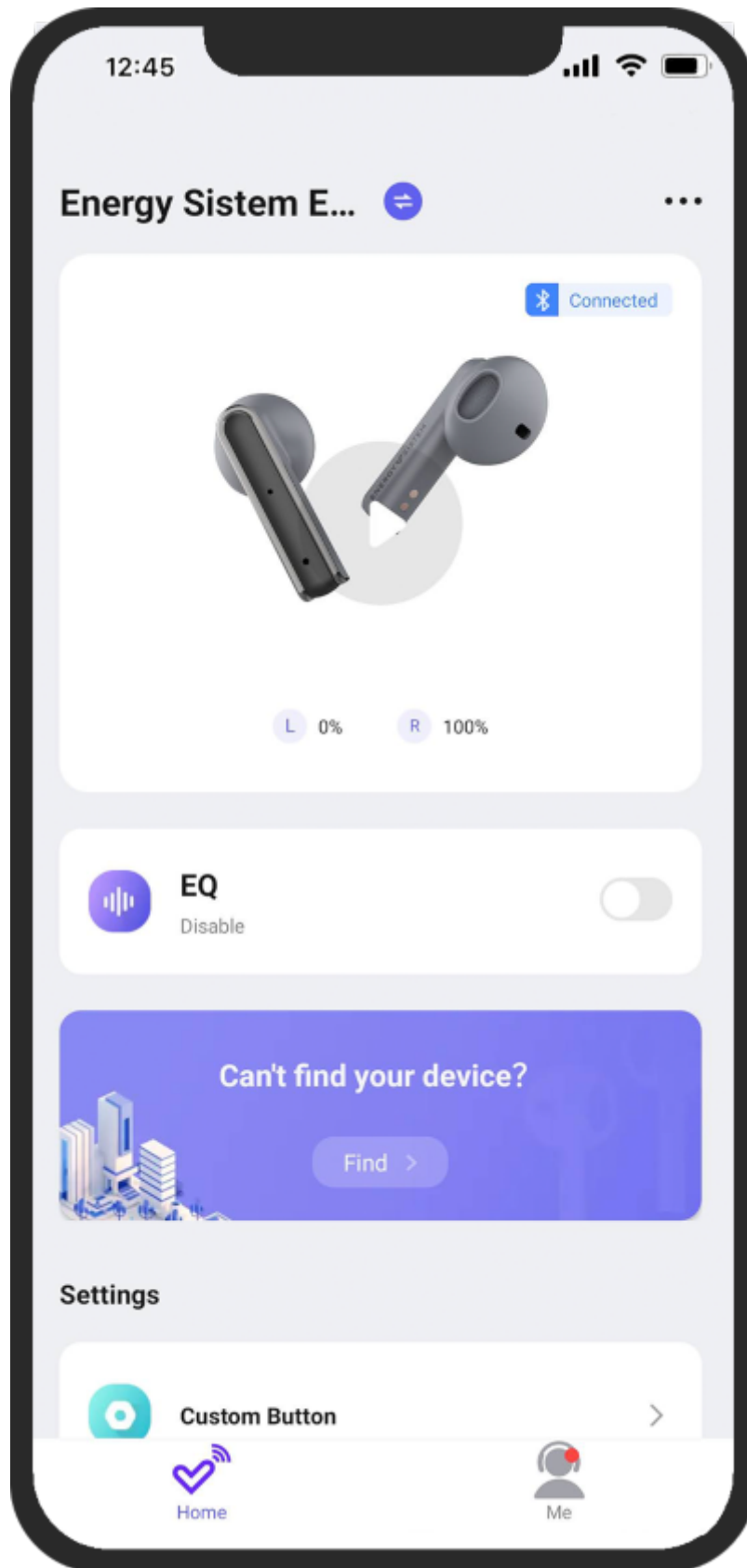

Enter the equalizer to select one of the 5 preset modes we have prepared exclusively for your device.

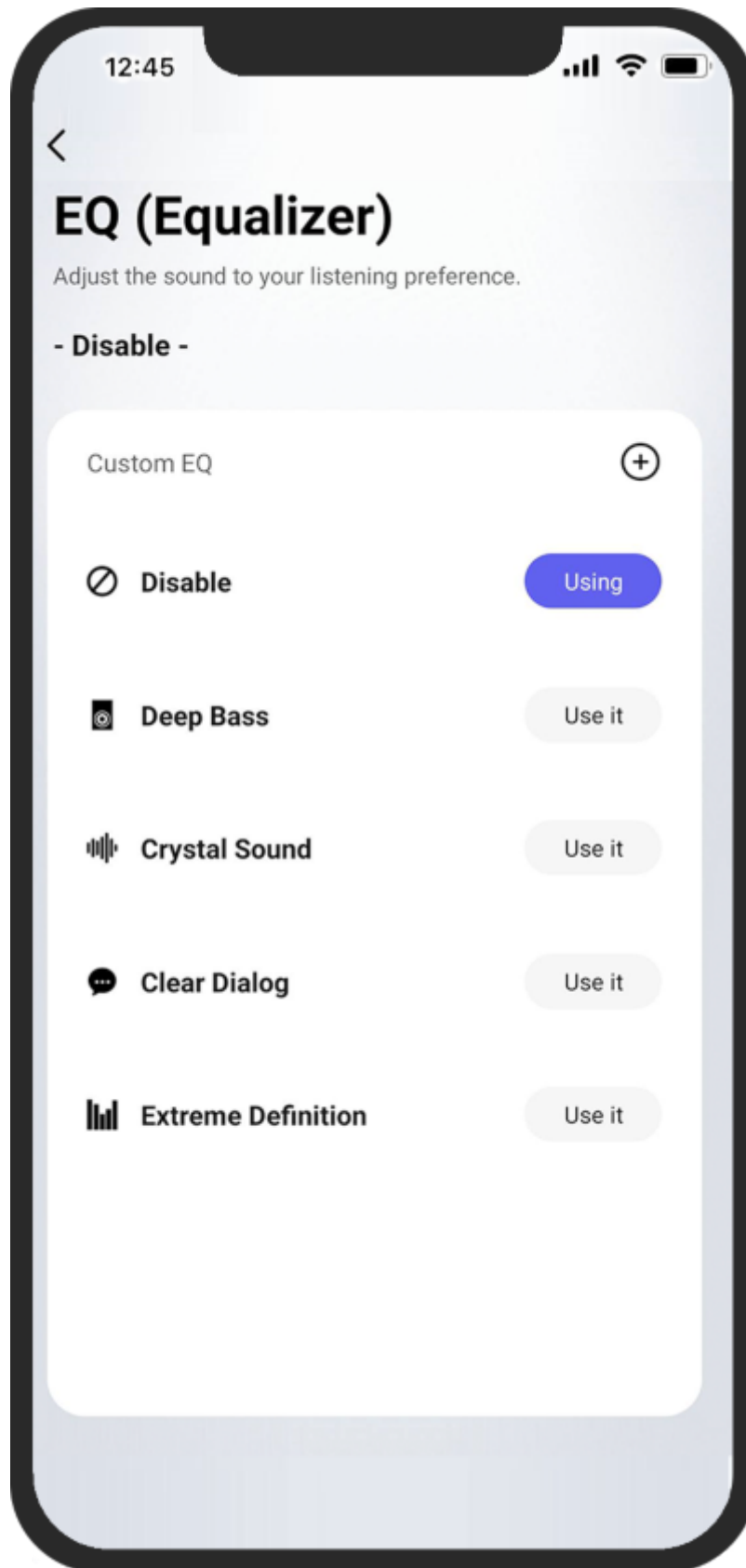

Tapping "+" will take you to a 10-octave band equalizer where you can adjust equalization per band, configuring it to your liking within a range of 24 dB.

Be sure to then tap Save and create a new preset in the list with your chosen name.



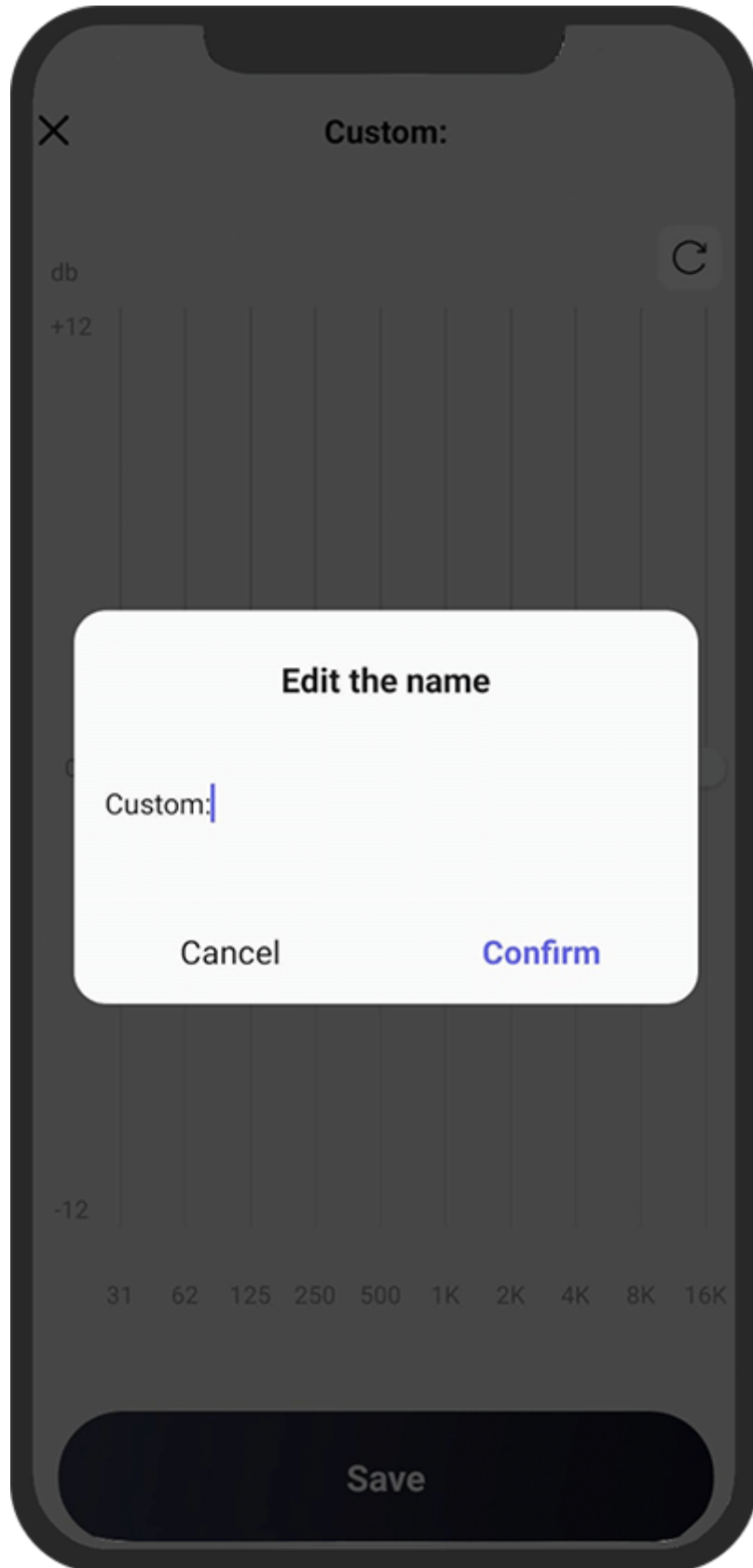

Have you lost your device? (Find my earbuds)

Go to the "Can't find your device?" section to see where your earphones were last connected to your mobile device.

If you cannot find your earphones and they are paired via Bluetooth® connection, tap the "Click to play" button to have them beep at full volume.

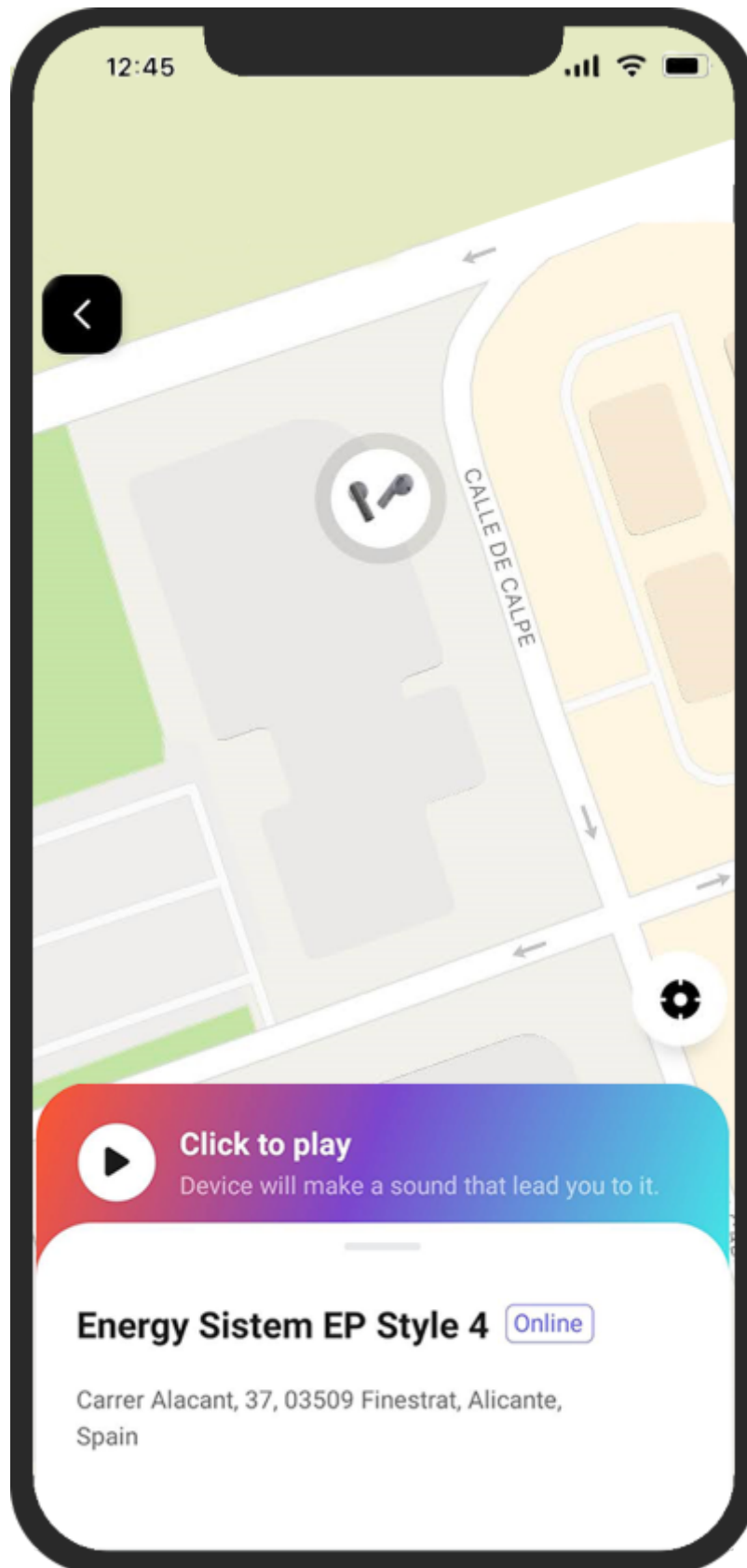

Custom control

The ESmart Connect app lets you customise the functions of your earphones' touch controls. First enter the Custom Control section in the main menu.

Here you can choose the function you want the device to perform when holding down the touch buttons or tapping them 1, 2 or 3 times. You can also choose a range of functions for the left or right earbud.

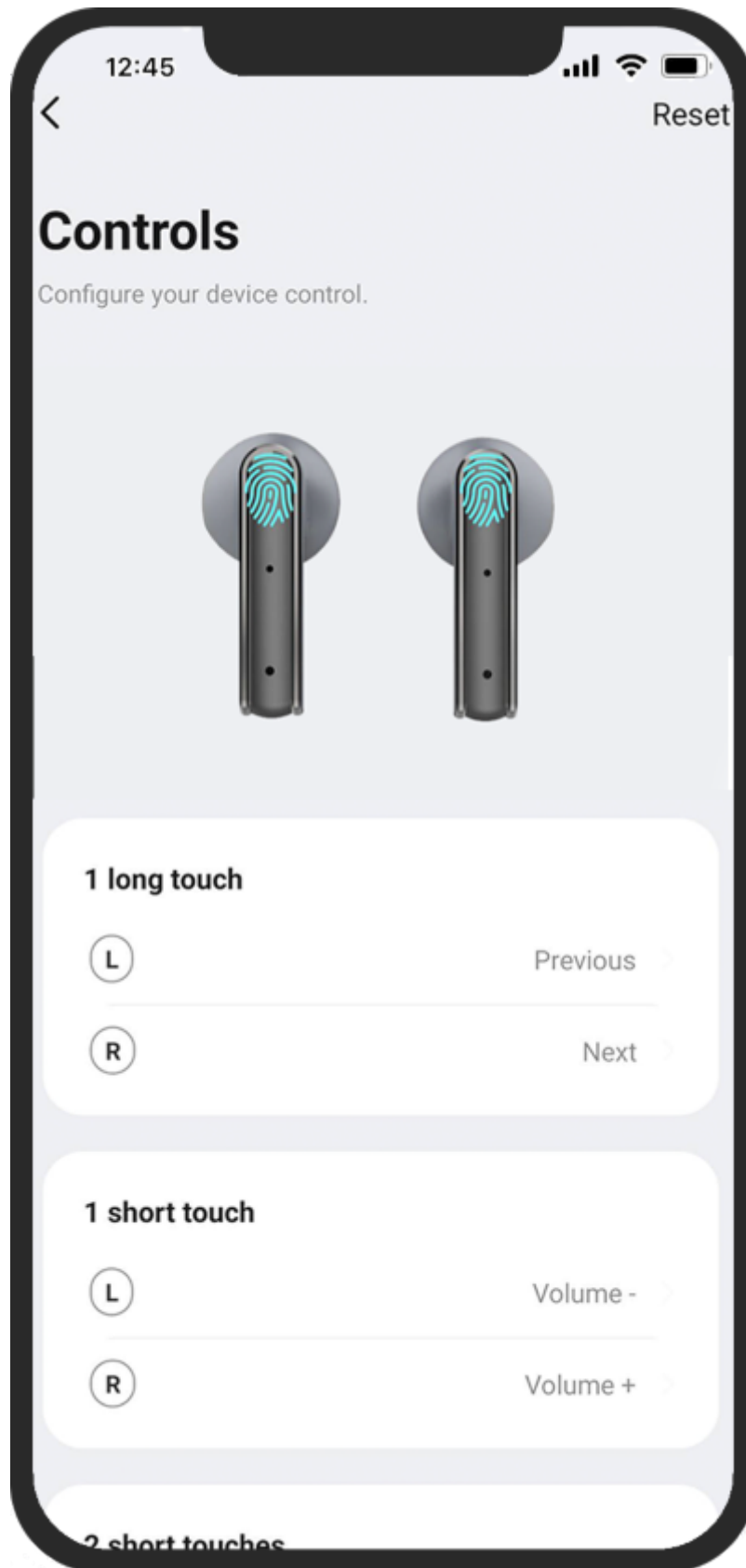

Proximity sensor (exclusive to Earphones Style 4 Ultra)

Earphones Style 4 Ultra have a built-in proximity sensor or Play/Pause sensor that pauses the music when you remove the earbud, and resumes it when you put it back in.

This function can be enabled and disabled using the switch in the app's main menu.

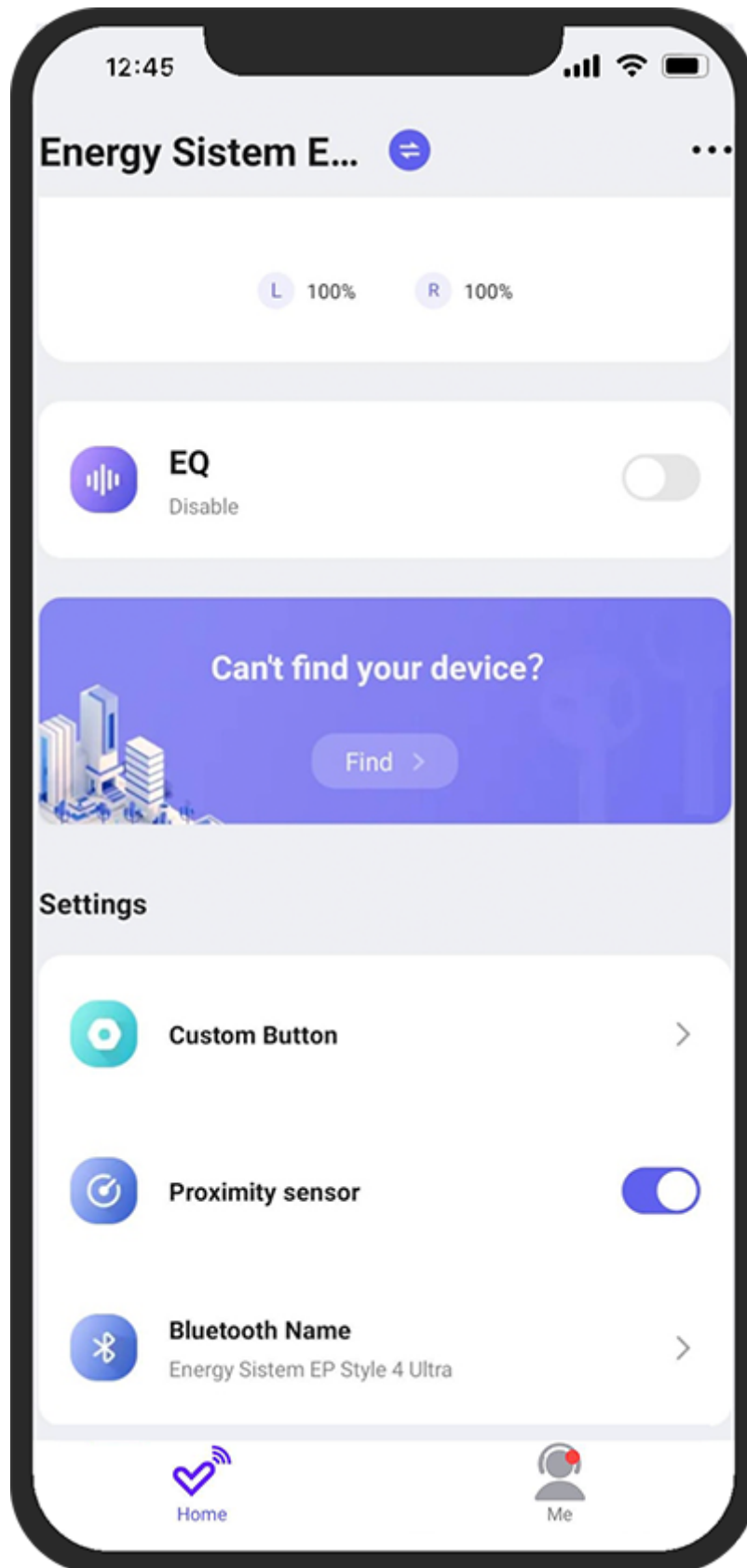

Renaming the device

You can change your device's Bluetooth name in the "Bluetooth Name" section in the main menu. Bluetooth name is limited to 28 characters.

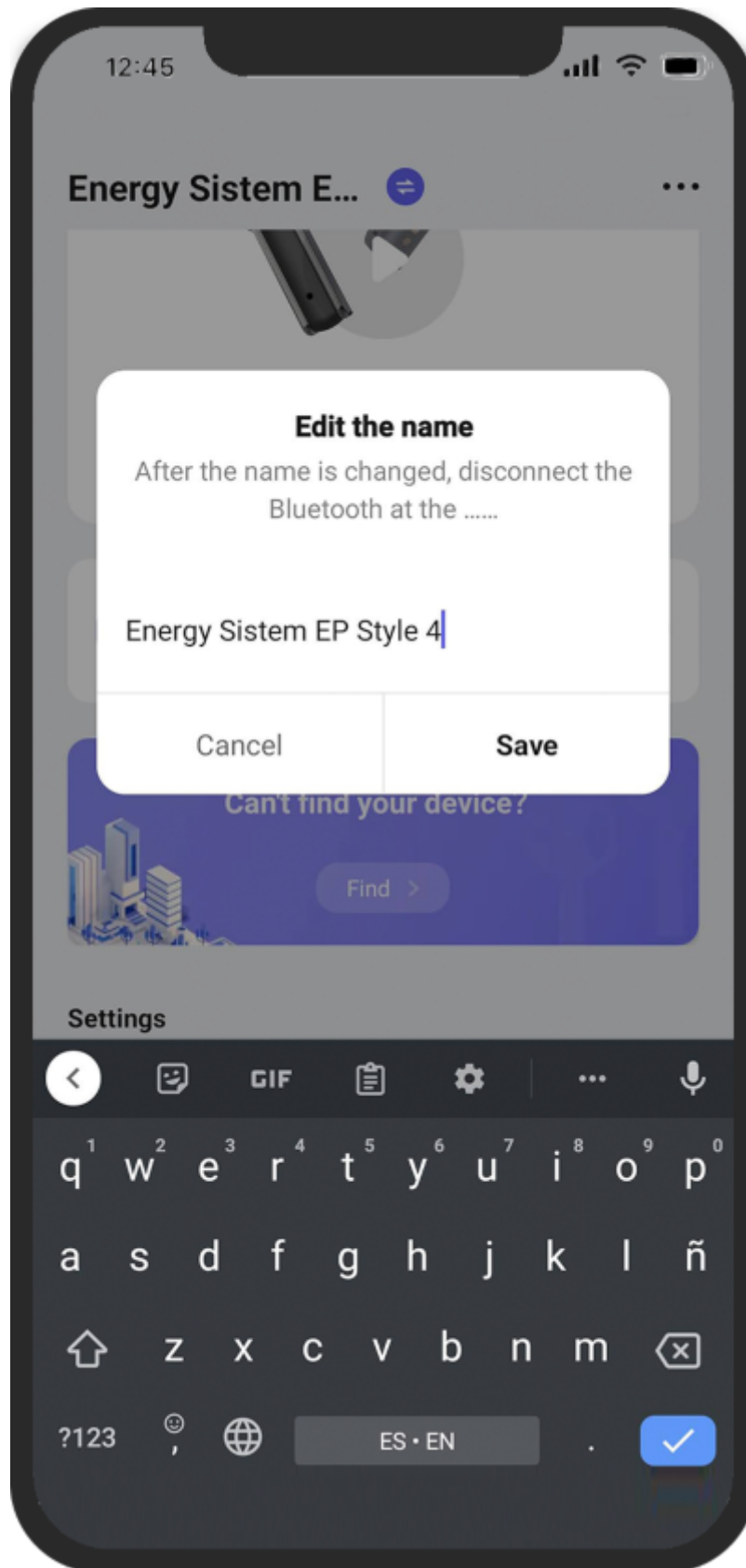

NOTE All changes made to the earphones via the app are saved in their Bluetooth chip, meaning your device will keep its configuration should you later connect it to another device that does not support the ESmart Connect app.

Default settings

The settings below can be adjusted via the ESmart Connect App.

Play/Pause

Tap the *Left multifunction button (1)* twice in a row to resume playback or pause the music.

Volume +/Volume -

Tap the *Right or Left multifunction button (2 or 1)* to turn the volume up or down.

Skipping to the next/previous track

Tap and hold the *Right or Left multifunction button (2 or 1)* for 2 seconds to skip to the next or previous track during music playback.

Call control

You can control calls from the earphones themselves once your *Earphones True Wireless Style 4 Ultra* are paired with your smartphone.

Answering/Ending a call

To answer a call or hang up, tap the *Left (1) or Right (2) multifunction button* twice.

Tap and hold for 2 seconds to decline the incoming call.

Using the Voice Assistant feature

You can interact with your smartphone's voice assistant using your *Earphones True Wireless Style 4 Ultra*. To do so, tap the *Left multifunction button (1)* three times in a row. You can give the voice command after hearing the confirmation sound.

Important note All these functions can be changed via the ESmart Connect app.

Charging the battery

Earphones

When the battery level of the *Earphones True Wireless Style 4 Ultra* is below 2%, you will hear a low battery warning sound. To charge the earphones' battery, put the earbuds back in the charging case. The *Charging indicator (charging case) (5)* flashes white and switches off once the charging process is complete.

Charging case

When the battery level of the charging case is below 10%, the *Charging indicator (charging case) (5)* starts flashing. Plug the USB Type-C end of the provided cable into the *USB Type-C charging port (6)*, and the other end into a 5 V USB charging device. The *Charging indicator (charging case) (5)* lights up white as the battery charges. Once the charging process is complete, all LEDs will light up white.

Caution: Do not charge your headphones with fast charging adapters or dedicated laptop charging adapters, Because their output voltage exceeds 5V and the device may become unusable.

Wireless charging case

The battery can be charged using the wireless charging pad. Simply plug the USB Type-C end of the adapter (included with the product) in the *Qi charging pad (7)*, and place your *Earphones True Wireless Style 4 Ultra* in the Qi cradle to start charging.

The charging LED will turn from red to blue and will keep on flashing while charging is in progress. It will turn red when charging is complete.

Important: We recommend not leaving neither your *Earphones True Wireless Style 4 Ultra* nor your charging case unused for long periods of time with an empty battery. We recommend charging the battery at least once a month.

Caution: Do not charge your headphones with dedicated laptop charging adapters, Because its output voltage exceeds 5V and the device may become unusable.

Restoring default settings

Follow the steps below to restore the earphones to default and reset their configuration:

- 1- Open the charging case lid or remove the earphones from the case, making sure they are not connected to the smartphone or any other Bluetooth device.
- 2- Tap the touch button in the earbuds 10 times in a row, both at the same time.
- 3- You can reconnect them to your Bluetooth device and use them as normally.

FAQ / Troubleshooting

I can't link the earphones to the ESmart Connect app.

Press 5 times in a row on the touch button of the right or left earphone. You will hear a "beep". Close and reopen the app.

Warranty

Find the full warranty terms and conditions at:

<https://www.energysistem.com/terms-warranty>

Ovaj dokument je originalno proizveden i objavljen od strane proizvođača, brenda Energy Sistem, i preuzet je sa njihove zvanične stranice. S obzirom na ovu činjenicu, Tehnoteka ističe da ne preuzima odgovornost za tačnost, celovitost ili pouzdanost informacija, podataka, mišljenja, saveta ili izjava sadržanih u ovom dokumentu.

Napominjemo da Tehnoteka nema ovlašćenje da izvrši bilo kakve izmene ili dopune na ovom dokumentu, stoga nismo odgovorni za eventualne greške, propuste ili netačnosti koje se mogu naći unutar njega. Tehnoteka ne odgovara za štetu nanесenu korisnicima pri upotrebi netačnih podataka. Ukoliko imate dodatna pitanja o proizvodu, ljubazno vas molimo da kontaktirate direktno proizvođača kako biste dobili sve detaljne informacije.

Za najnovije informacije o ceni, dostupnim akcijama i tehničkim karakteristikama proizvoda koji se pominje u ovom dokumentu, molimo posetite našu stranicu klikom na sledeći link:

<https://tehnoteka.rs/p/energy-sistem-slusalice-style-4-ultra-space-crne-akcija-cena/>