

Uputstvo za upotrebu (EN)

XIAOMI Watch S1 Active Moon White pametni sat



Tehnoteka je online destinacija za upoređivanje cena i karakteristika bele tehnike, potrošačke elektronike i IT uređaja kod trgovinskih lanaca i internet prodavnica u Srbiji. Naša stranica vam omogućava da istražite najnovije informacije, detaljne karakteristike i konkurentne cene proizvoda.

Posetite nas i uživajte u ekskluzivnom iskustvu pametne kupovine klikom na link:

<https://tehnoteka.rs/p/xiaomi-watch-s1-active-moon-white-pametni-sat-akcija-cena/>

XIAOMI Watch S1 Active User Manual



Product Overview

Read this manual carefully before use, and retain it for future reference.

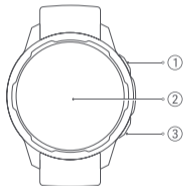

Watch

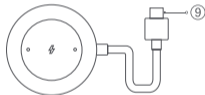
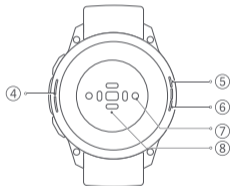

Charging Cable

- ① Power Button
- ② Display
- ③ Shortcut Button
- ④ Speaker
- ⑤ Microphone
- ⑥ Barometric Pressure Sensor
- ⑦ Contact Point
- ⑧ Heart Rate Sensor Area
- ⑨ USB Connector

Note: Illustrations of product, accessories, and user interface in the user manual are for reference purposes only. Actual product and functions may vary due to product enhancements.

Connecting the Watch

Download and install the app to better manage your watch, and log in to your Xiaomi account for more services.

1. Press and hold the power button to turn on the watch.
2. Use your phone to scan the QR code on the screen to download and install the app. You can also download and install the app from the app stores, or scan the QR code listed here.

Note: The operations described here might slightly differ from the app due to its update, please follow the on-screen instructions.

3. Open the app, and log in to your Xiaomi account. Select the watch to be added and follow the instructions to pair it with your phone.

Notes:

- Make sure the Bluetooth on your phone is enabled and the watch is well connected with your phone.
- During pairing, make sure the identical pairing code is displayed on both the phone and the watch.
- If the pairing code appears on the watch but not on the phone, please check whether there is a pairing request in the notifications of the phone.



Scan the QR code, and download the proper app version according to your phone's system.

How to Use

- ① Press and hold the home screen: Switch the watch face.
- ② Swipe up: Open the control panel when on the home screen.
- ③ Swipe down: View notifications when on the home screen.
- ④ Swipe left/right: Switch widget when on the home screen.
- ⑤ Swipe right: Go back when on a page other than the home screen.

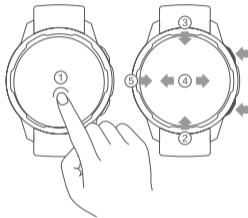

Power Button

- Press and hold for about 3 seconds: Turn on the watch. When the watch is on, the screen will show the options to turn off, restart and restore to the factory settings.
- Press and hold for about 15 seconds: Force restart.
- Press when on the home screen: Enter the function list.
- Press when on other pages: Go back to the home screen.

Shortcut Button

- Press when on the home screen: Enter the shortcut function (workout list by default).

Charging the Watch

1. Place the watch on the charging cable. Make sure the contact points both on the back of the watch and the charging cable are making contact with each other.
2. Connect the USB connector of the charging cable to a standard adapter purchased from a qualified manufacturer at an output voltage of 5 V or higher.
3. The screen of the watch will light up and show the charging icon.

Notes:

- If the watch is unable to turn on after it has not been used for a while, it needs to be charged for about 1 minute before the charging icon is displayed.
- Wipe the watch's contact points clean before charging so as to avoid residual sweat or moisture.

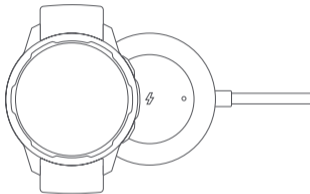

Functions

For more detailed information about the watch, please connect to the app and view the instructions.

Safety Precautions

- Comfortably tighten the watch around your wrist about one-finger width away from your wrist bone. Wearing the straps too loosely may impact the data collection by the heart rate sensor.
- When using the watch to measure your heart rate, please hold your wrist still.
- The watch has a water resistance rating of 5ATM (50 meters in depth). It can be worn in the swimming pool, while swimming near the shore, or during other shallow-water activities. However, it cannot be used in hot showers, sauna, or diving. Furthermore, remember to avoid the watch being directly impacted by swift currents during water sports. The water-resistant function is not permanent and may decline over time.
- The screen of the watch does not support underwater operations. When the watch comes into contact with water, use a soft cloth to wipe away excess water from its surface before use.
- During daily use, avoid wearing the watch too tightly. Keep its contact area dry and regularly clean the strap with water. Immediately stop using the watch and seek medical assistance if the contact area on your skin shows signs of redness or swelling. Due to friction, wearing the watch for a long time during high-intensity exercise may cause skin irritation. If this is the case, please stop wearing the watch.
- Use the included charging cable to charge the watch. Only use a certified power adapter supplied by qualified manufacturers.
- Make sure the power adapter, the charging cable, and the watch are in a dry environment while charging. Do not touch them with wet hands and do not expose them to rain or other liquids.
- When the magnetic charging cable is connected to the power, make sure the conductive substances are not absorbed on it. Otherwise, it may cause a short circuit.
- Please use the watch within a temperature range of -10°C to 45°C. When the ambient temperature is too high or too low, the watch may malfunction.

- This watch is equipped with a built-in battery that cannot be removed. Do not disassemble the watch. Do not expose batteries or battery packs to sunlight, fire, or environments where the ambient temperature is extreme heat. There is a risk of explosion if the battery is incorrectly installed, therefore only use and replace with the same or an equivalent type of battery. Do not dispose of used batteries with household waste. Dispose of this watch and used batteries as per local laws and regulations.
- Do not disassemble, strike or crush the battery. Stop using the battery immediately if there is any swelling or fluid leakage.
- Never throw the watch or its battery into the fire so as to avoid an explosion.
- This watch is not a medical device, any data or information provided by the watch should not be used as a basis for diagnosis, treatment, and prevention of diseases.
- The watch and its accessories may contain small parts. To avoid choking or other hazards to children, or damage caused by children, keep the watch and its accessories out of the reach of children.
- The watch is not a toy. Keep it out of reach of children.

Specifications

Product: Smart Watch

Model: M2116W1

Device Type: 2.4 GHz Wi-Fi Network/Bluetooth Device

Wireless Connectivity: Wi-Fi IEEE 802.11 b/g/n 2.4 GHz, **Bluetooth®** 5.2

Battery Capacity: 470 mAh

Input Voltage: DC 5.0 V

Input Current: 500 mA Max.

Compatible with: This watch only supports certain Android or iOS systems. For detailed information, please check this watch's product page on www.mi.com or consult sales/customer service staff before purchasing.

Regulatory Compliance Information

WEEE Information



All products bearing this symbol are waste electrical and electronic equipment which should not be mixed with unsorted household waste. Instead, you should protect human health and the environment by handing over your waste equipment to a designated collection point for the recycling of waste electrical and electronic equipment, appointed by the government or local authorities. Correct disposal and recycling will help prevent potential negative consequences to the environment and human health. Please contact the installer or local authorities for more information about the location as well as terms and conditions of such collection points.

EU Declaration of Conformity



Hereby, 70mai Co., Ltd. declares that the radio equipment type M2116W1 is in compliance with Directive 2014/53/EU. The full text of the EU declaration of conformity is available at the following internet address: <http://www.mi.com/global/service/support/declaration.html>



Hereby, 70mai Co.,Ltd. declares that the radio equipment type M2116W1 is in compliance with Radio Equipment Regulations 2017. The full text of the UKCA declaration of conformity is available at the following internet address: <https://www.mi.com/uk/service/support/declaration.html>

Bluetooth/Wi-Fi Operation Frequency: 2400–2483.5 MHz

GPS/GLONASS/BDS/GALILEO Operation Frequency: 1559–1610 MHz

NFC Operating Frequency: 13.56 MHz

Bluetooth Maximum Output: < 13 dBm

Wi-Fi Maximum Output: < 20 dBm

Maximum Output Power: 24.94 dBuA/m@3m

Safety Information

Cautions

- Disposal of a battery into fire or a hot oven, or mechanically crushing or cutting of a battery, that can result in an explosion.
- Leaving a battery in an extremely high temperature surrounding environment that can result in an explosion or the leakage of flammable liquid or gas.
- A battery subjected to extremely low air pressure that may result in an explosion or the leakage of flammable liquid or gas.
- This device is equipped with a built-in battery that cannot be removed or replaced. Do not disassemble or modify the battery by yourself.
- Replacement of a battery with an incorrect type can defeat a safeguard (for example, in the case of some lithium battery types).

Battery Safety

Battery abuse or mishandling can cause overheating, liquid leakage, or an explosion. To avoid possible injury, do the following:

- Do not open, disassemble, or service any battery.
- Do not attempt to replace the internal rechargeable lithium batteries.
- Do not crush or puncture the battery.
- Do not short-circuit the battery, or expose it to water or other liquids.
- Keep the battery away from children.
- Keep the battery away from fire.
- Do not leave the battery in an extremely high-temperature environment or an extremely low air pressure environment.
- Stop using the battery if it is damaged, or if you notice any discharge or the buildup of foreign materials on the battery leads.
- Do not put the battery in trash that is disposed of in landfills. When disposing of the battery, comply with local laws or regulations.

This equipment has been tested and meets applicable limits for radio frequency (RF) exposure.

Specific Absorption Rate (SAR) refers to the rate at which the body absorbs RF energy. SAR limits depend on whether this equipment is used against the head or on the wrist. The SAR limit is 2.0 watts per kilogram averaged over 10 grams of tissue for use against the head and 4.0 watts per kilogram averaged over 10 grams of tissue for use on the wrist.

During testing, this equipment radios are set to their highest transmission levels and placed in positions that simulate use next to the mouth, with 5 mm separation, and on the wrist, with no separation.

When placing this equipment near your mouth, keep at least 5 mm of separation to ensure exposure levels remain at or below the as-tested levels.

After testing, the highest SAR values are as follows:

Next to the mouth: 0.153 W/kg

Wrist: 0.214 W/kg

For regulatory information, product certification, and compliance logos related to the Xiaomi Watch S1 Active, please go to **Settings > About watch > Regulatory**.

The Bluetooth® word mark and logos are registered trademarks owned by Bluetooth SIG, Inc. and any use of such marks by Xiaomi Inc. is under license. Other trademarks and trade names are those of their respective owners.

For the information not covered in this user manual, please go to www.mi.com



**Complies with
IMDA Standards
DB106135**

Ovaj dokument je originalno proizveden i objavljen od strane proizvođača, brenda Xiaomi, i preuzet je sa njihove zvanične stranice. S obzirom na ovu činjenicu, Tehnoteka ističe da ne preuzima odgovornost za tačnost, celovitost ili pouzdanost informacija, podataka, mišljenja, saveta ili izjava sadržanih u ovom dokumentu.

Napominjemo da Tehnoteka nema ovlašćenje da izvrši bilo kakve izmene ili dopune na ovom dokumentu, stoga nismo odgovorni za eventualne greške, propuste ili netačnosti koje se mogu naći unutar njega. Tehnoteka ne odgovara za štetu nanесenu korisnicima pri upotrebi netačnih podataka. Ukoliko imate dodatna pitanja o proizvodu, ljubazno vas molimo da kontaktirate direktno proizvođača kako biste dobili sve detaljne informacije.

Za najnovije informacije o ceni, dostupnim akcijama i tehničkim karakteristikama proizvoda koji se pominje u ovom dokumentu, molimo posetite našu stranicu klikom na sledeći link:

<https://tehnoteka.rs/p/xiaomi-watch-s1-active-moon-white-pametni-sat-akcija-cena/>