

Uputstvo za upotrebu (EN)

SENCOR paročistač SSC 3001YL

SENCOR



Tehnoteka je online destinacija za upoređivanje cena i karakteristika bele tehnike, potrošačke elektronike i IT uređaja kod trgovinskih lanaca i internet prodavnica u Srbiji. Naša stranica vam omogućava da istražite najnovije informacije, detaljne karakteristike i konkurentne cene proizvoda.

Posetite nas i uživajte u ekskluzivnom iskustvu pametne kupovine klikom na link:

<https://tehnoteka.rs/p/sencor-parocistac-ssc-3001yl-akcija-cena/>

Steam Cleaner

User's manual

EN



SENCOR[®]

SSC 3001YL

Translation of the original manual

Prior to using this appliance, please read the user's manual thoroughly, even in cases, when one has already familiarised themselves with previous use of similar types of appliances. Only use the appliance in the manner described in this user's manual. Keep this user's manual in a safe place where it can be easily retrieved for future use.

We recommend saving the original cardboard box, packaging material, purchase receipt and responsibility statement of the vendor or warranty card for at least the duration of the legal liability for unsatisfactory performance or quality. In the event of transportation, we recommend that you pack the appliance in the original box from the manufacturer.

EN-1

CONTENTS

IMPORTANT SAFETY INSTRUCTIONS.....	3
DESCRIPTION OF THE STEAM CLEANER.....	6
OVERVIEW OF THE ACCESSORIES AND THEIR PURPOSE OF USE.....	7
ATTACHING AND REMOVING ACCESSORIES	7
FILLING THE WATER TANK.....	9
BEFORE FIRST USE.....	9
USING THE STEAM CLEANER	10
PROBLEMS AND TROUBLESHOOTING	11
MAINTENANCE AND CLEANING.....	11
STORAGE.....	12
TECHNICAL SPECIFICATIONS.....	12
INSTRUCTIONS AND INFORMATION REGARDING THE DISPOSAL OF USED PACKAGING MATERIALS	12
DISPOSAL OF USED ELECTRICAL AND ELECTRONIC APPLIANCES.....	12

IMPORTANT SAFETY INSTRUCTIONS

READ CAREFULLY AND STORE FOR FUTURE USE.

- This appliance may be used by persons with physical, sensory or mental impairments or by persons with insufficient experience and knowledge, if they are properly supervised or have been informed about how to use the appliance in a safe manner and understand the potential dangers.
- Children must not play with the appliance.
- In the event that the power cord is damaged, have it repaired at a professional service centre to prevent causing a dangerous situation. It is forbidden to use the appliance if it has a damaged power cord.
- Always disconnect the power adapter from the power socket before cleaning or performing maintenance on the appliance.
- Use the appliance only with the original power adapter and accessories that came with it.



WARNING:

Hot steam. Danger of scalding.

- Do not point the sprayer at equipment containing electrical components such as, for example the inside of an oven.
- The dirty water tank drain valve must not be open when the appliance is being used.

- Always turn off the appliance when you have finished using it, when leaving it without supervision, prior to cleaning and before connecting it to a power socket by means of the power adapter.
 - When the appliance is connected to the mains power supply via the adapter, it must not be left without supervision.
 - Do not use the appliance if it is leaking, if it has fallen or if it is showing visible signs of damage.
 - Keep the appliance out of children's reach when it is in operation, when pressurised with steam, when connected to a power socket or while it is cooling down.
- Always disconnect the power plug from the power socket before cleaning or performing maintenance on the appliance.
 - When using the appliance, steam must not be directed at other people, animals or equipment containing electrical components such as, for example, baking ovens.

**Attention:**

The water tank is pressurised with hot water, therefore do not open the filling opening or even attempt to loosen the safety valve.

- Fill the water tank according to the instructions contained in chapter Filling the water tank. Do not overfill the water tank.
- Do not leave the appliance without supervision when it is connected to a power socket.
- It is forbidden to open the filling opening on the water tank when using the appliance.
- Before connecting the appliance to a power socket, check that the voltage on its rating label matches the electrical voltage in the power socket.
- Connect the appliance only to a grounded power socket.
- This appliance is designed for household use. Do not use it for commercial purposes, in industrial surroundings or outdoors.
- This appliance serves to clean floor areas, fittings, wash basins, tiles and paving, windows, mirrors, range hoods, cooktops, oven doors, grills, countertops, upholstered furniture, clothing, toys, etc.
- Do not use the appliance to clean leather materials, vinyl floors, floor areas without thoroughly sealed joints, floors or furniture treated with wax, synthetic fabrics, products from softened plastics, frozen glass or glass that is cooled to a low temperature, velvet or suede fabrics or other materials that could be damaged by the effect of hot steam.
- Do not use the appliance for a purpose other than that for which it is designed.
- Pay increased attention to avoid scalding by the hot steam when operating the appliance.

Steam Cleaner

SSC 3001YL

EN

- Do not place the appliance on an electric or gas stove or in its vicinity, on the edge of a table or on an unstable surface. Only place the appliance on an even, dry and stable surface.
- Fill the water tank only with tap water or distilled water when the tap water is too hard and causes mineral deposits to form. Before filling the water tank, make sure that the appliance is turned off and disconnected from the power socket.
- Never add descaling agents, fragrant oils, detergents, alcohol, etc. to the water tank. Otherwise this could result in damage to the appliance or injury.
- Before attaching, removing or changing accessories check that the appliance is turned off and disconnected from the power socket.
- Do not use the appliance in areas where there are fumes from oil paint thinners or chemicals used for treating clothing against moths or other explosive or toxic fumes.
- When using the appliance, do not touch the parts that are hot. Otherwise, this could cause burns.
- When using the appliance, do not turn it upside down, do not block the steam exit holes nor insert any items into them.
- After use and before cleaning the appliance, always turn it off and disconnect the power cord from the power socket.
- Allow the appliance to fully cool down before cleaning or storing it.
- Do not let the power cord touch hot surfaces or sharp objects. Position the power cord so that it will not be tripped over.
- To prevent potential injury by electric shock, do not submerge this appliance or its power cord in water or any other liquid or rinse it under running water.
- Do not disconnect the appliance from the power socket by pulling on the power cord. This could damage the power cord or the power socket. Disconnect the cord from the power socket by gently pulling on the plug of the power cord.
- Do not use the appliance if it has damaged power cord. If the power cord is damaged, have it replaced at a professional service centre.
- To avoid a hazardous situation arising, do not repair the device yourself or modify it in any way. Have all repairs or adjustments performed at an authorised service centre. By tampering with the appliance, you risk voiding your legal rights arising from unsatisfactory performance or quality warranty.

Steam Cleaner

SSC 3001YL

DESCRIPTION OF THE STEAM CLEANER

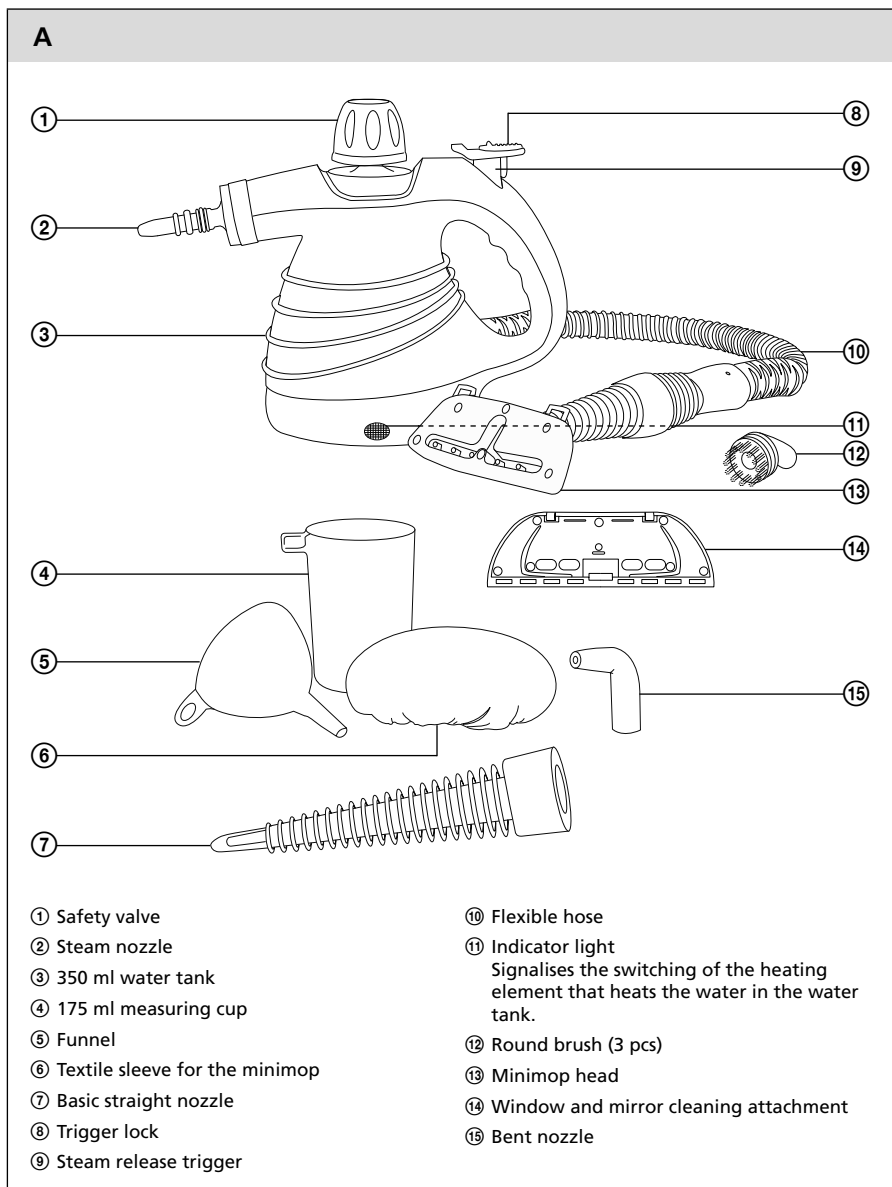

OVERVIEW OF THE ACCESSORIES AND THEIR PURPOSE OF USE

Type of accessory	Purpose of use
Basic straight nozzle A⑦	Serves to clean: <ul style="list-style-type: none"> - tiles, paving and other hard floor surfaces with fixed joints; - water taps and sanitary equipment; - toys, tables and other workbenches; - hard to reach places.
Flexible hose A⑩	Used for cleaning hard to reach places.
Minimop with a textile sleeve A⑬ a A⑥	Used for steaming clothing and cleaning clothing, upholstered furniture, drapes, bed linen, etc.
Bent nozzle A⑮	Serves to clean: <ul style="list-style-type: none"> - water taps and sanitary equipment; - toys, tables and other workbenches; - hard to reach places.
Window and mirror cleaning attachment A⑭	Serves to clean windows, mirrors and walls of shower cabinets.
Round brush A⑫	Serves to clean: <ul style="list-style-type: none"> - stoves, grills and grilling accessories; - tiles, paving and other hard floor surfaces with fixed joints; - water taps and sanitary equipment; - toys, tables and other workbenches.

Do not use the steam cleaner to clean:

- synthetic fabrics, velvet or suede fabrics or other textile materials that could be damaged by the effect of hot steam.
- waxed furniture or floor areas. The effect of hot steam may result in a loss of gloss.
- frozen glass or glass that is subjected to a low ambient temperature, otherwise it may be damaged or crack.
- wooden surfaces without a paint coat.

ATTACHING AND REMOVING ACCESSORIES

- The round brush A⑫ and the bent nozzle A⑮ can be attached to the nozzle of the steam cleaner A②, the basic straight nozzle A⑦ or the flexible hose A⑩. In the event that an even greater reach is required to the flexible hose A⑩ it is possible to attach the basic straight nozzle A⑦ and then attach the brush A⑫ or the bent nozzle A⑮ on to it.
- The minimop A⑬ can be attached to the nozzle of the steam cleaner A② or to the flexible hose A⑩.

Attaching and removing the flexible hose

- On to the nozzle of the steam cleaner A② attach the flexible hose A⑩ so that the symbol "I" marked on the hose connector A⑩ is aligned with the same symbol on the steam cleaner. Rotate the hose connector A⑩ by 90° anticlockwise. Now the "I" symbol marked on the hose connector A⑩ will be aligned with symbol "II" on the steam cleaner.
- Remove the flexible hose A⑩ in the reverse sequence.

Attaching and removing the basic straight nozzle

- On to the nozzle of the steam cleaner A② attach the basic straight nozzle A⑦ so that the symbol "I" marked on the nozzle connector A⑦ is aligned with the same symbol on the steam cleaner. Rotate the nozzle A⑦ by 90° anticlockwise. Now the "I" symbol marked on the nozzle connector A⑦ will be aligned with symbol "II" on the steam cleaner.
- It is also possible to connect the basic straight nozzle A⑦ to the flexible hose A⑩, by seating the nozzle connector A⑦ on to the nozzle of the flexible hose A⑩ and turnig nozzle A⑦ 90° anticlockwise. This will firmly connect these two parts.
- Remove the basic straight nozzle A⑦ in reverse sequence.

Attaching and removing the round brush and bent nozzle

- You can seat the round brush A⑫ and the bent nozzle A⑮ on to the nozzle of the steam cleaner A②, the basic straight nozzle A⑦ or the flexible hose A⑩. Accessories need to be properly attached so that they do not come loose during use.
- Remove the brush A⑫ and nozzle A⑮ in reverse sequence.

Attaching and removing the minimop and textile sleeve

- On to the nozzle of the steam cleaner A② attach the minimop A⑬ so that the symbol "I" marked on the minimop A⑬ is aligned with the same symbol on the steam cleaner. Rotate the minimop connector A⑬ by 90° anticlockwise. Now the "I" symbol marked on the minimop connector A⑬ will be aligned with symbol "II" on the steam cleaner.
- You can also use the minimop A⑬ with the flexible hose A⑩. First attach the flexible hose A⑩ onto the steam cleaner according to the instructions contained in subchapter Attaching and removing the flexible hose. Then on to the nozzle of the flexible hose A⑩ attach the minimop A⑬ and turn the minimop connector⑬ by 90° anticlockwise. This will firmly connect these two parts.
- Pull the textile sleeve A⑥ on to the head of the minimop A⑬.
- Remove the minimop A⑬ and the textile sleeve A⑥ in reverse sequence.

**Attention:**

Allow the minimop A⑬ and the textile sleeve A⑥ to fully cool down before removal.

Attaching and removing the window and mirror cleaning attachment

- On to the nozzle of the steam cleaner A② or the flexible hose A⑩ attach the minimop A⑬ (without the textile sleeve A⑥) according to the instructions contained in subchapter Attaching and removing the minimop and textile sleeve.
- To the head of the minimop A⑬ connect the window and mirror cleaning attachment A⑭ so that both tabs at the bottom of the attachment A⑭ slide into the holes in the bottom part of the minimop head A⑬. Then push the attachment A⑭ against the head of the minimop A⑬, until the tab in the top part of the attachment A⑭ attaches to the top edge of the minimop head A⑬.
- When removing the attachment A⑭, first release the tab in the top part of the attachment A⑭ by lifting it up. Then tilt the attachment A⑭ away from the minimop head A⑬ and slide the tabs in the bottom part of attachment A⑭ out of the openings in the bottom part of the minimop A⑬.

FILLING THE WATER TANK

1. Filling the water tank before use

- Make sure that the steam cleaner is turned off and disconnected from the power socket.
- Unscrew the safety valve A① anticlockwise out of the steam cleaner.
- Fill the measuring cup A④ with clean water up to the 175 ml mark. Place the funnel A⑤ into the filling opening and hold it there. Pour the water from the measuring cup A④ into the water tank A③. You may add another 75 ml of water into the water tank A③. This will utilise the maximum capacity of the water tank A③, i.e. 250 ml of water. Do not overfill the water tank A③ with more water, otherwise steam will not be able to form inside it and the steam cleaner will not work correctly.
- Again, close the filling opening with the safety valve A①. Firmly tighten the safety valve A① by turning it clockwise.



Attention:

Always fill the water tank A① only with clean tap water or distilled water when the tap water is hard or very hard. Never add descaling agents, fragrant oils, detergents, alcohol, etc. to the water tank A①. Otherwise this could result in damage to the steam cleaner or injury.

2. Refilling the water tank

- Turn off the steam cleaner and disconnect it from the power socket. Release the trigger lock A⑧ by sliding it towards the open padlock symbol and press the steam release trigger A⑨. Hold down the trigger A⑨ until all steam is released from the water tank A③.
- Turn the safety valve A① anticlockwise until it is partially released. In this phase, do not fully screw out the safety valve A①. In this way, you will ensure the gradual release of residual steam. Wait approximately 5 minutes for the remaining water in the water tank A③ to cool down and then you can screw out the safety valve A① and take it off the filling opening.
- Pour the remaining water out of the water tank A③ and allow the steam cleaner to cool down for approximately 10 minutes. Add water to the water tank A③ according to the instructions contained in the previous subchapter. Take care not to overfill it. There should not be more than 250 ml of water in the water tank A③.
- Screw the valve A① back on to the filling opening and tighten it firmly in the clockwise direction. Then you can continue using the steam cleaner.



Note:

In the event that the steam cleaner is pressurised with a larger amount of steam, the valve mechanism will not enable the safety valve A① to be screwed out. The safety valve A① will keep slipping and it will not be possible to release it. In such a case, first release all the steam and then try again to release the safety valve A①. Wait approximately 5 minutes for the remaining water in the water tank A③ to cool down before fully screwing out the safety valve A①.

BEFORE FIRST USE

- Make sure that the steam cleaner is turned off and disconnected from the power socket.
- Wipe the outer surface of the steam cleaner and its accessories with a clean lightly dampened cloth and then thoroughly wipe everything dry.

USING THE STEAM CLEANER

- The steam cleaner generates hot steam which quickly and effectively removes grease, accumulated dirt and grime without using any chemical agents.
- We recommend always testing the effects of the steam on a smaller area. After cleaning, allow the test surface to dry completely so that you can observe whether the surface of the cleaned area does not become damaged, discoloured, etc.
- Make sure that the accessories that you wish to use are attached to the steam cleaner and that the water tank A③ is filled with water.
- Connect the steam cleaner to a power socket. When it is connected to a power socket, the indicator A⑩ will be lit indicating that water in the water tank A③ is being heated.



Attention:

Before connecting the steam cleaner to a power socket, first check that the trigger lock A⑧ is not released so that trigger A⑨ cannot be accidentally pressed.

- It takes approximately 2.5 minutes for the water to heat up. Then the indicator A⑩ will turn off. This signals that the water has been heated to the operating temperature and that the steam cleaner is ready for use.



Note:

The indicator A⑩ regularly turns on and off during operation which signals that water temperature is being maintained.

- Steam will be released when the trigger lock A⑧ is released and the trigger A⑨ is pressed. If you wish to stop the steam flow, release the trigger A⑨. The trigger lock A⑧ will return to the initial position. This means that the trigger A⑨ is secured against being accidentally pressed.
- When you have finished using the steam cleaner, turn it off and disconnect it from the power socket. Release the remaining steam and allow the steam cleaner to cool down. When it has cooled down, screw out the safety valve A①, and remove the remaining water from the water tank A③ and clean the steam cleaner according to the instructions contained in the chapter Maintenance and cleaning.

Instructions for cleaning clothing

- To clean clothing, use the minimop head A⑬ with the textile sleeve A⑥.
- Make sure that the material from which the clothing is made is suitable for cleaning with hot steam. Hang the clothing and ride over it with the minimop head A⑬ with the sleeve A⑥ in the vertical and horizontal direction.

Instructions for cleaning mirrors, windows and other glass surfaces.

- To clean mirrors, windows and other glass surfaces, use the window and mirror cleaning attachment A⑭.
- Ride over the surface of the glass surface or mirror in the horizontal or vertical direction. When cleaning windows, we recommend to release the steam in short bursts.
- Never use the steam cleaner on frozen glass or glass that is subjected to a low ambient temperature, otherwise it may be damaged or crack.

Instructions for cleaning floor surfaces with fixed joints (tiles, etc.)

- To clean floor surfaces, use the flexible hose A⑩ with round brush A⑫ or bent nozzle A⑮.
- Ride over stains and soils that need to be removed with the hot steam. In the case of heavy soiling, apply a larger amount of steam to the respective areas.
- When using the round brush A⑫, do not push too hard on it.
- Do not use the steam cleaner on waxed surfaces. Hot steam may cause the loss of gloss.

Steam Cleaner

SSC 3001YL

EN

PROBLEMS AND TROUBLESHOOTING

Problem	Possible cause	Solution
Low steam pressure.	The water tank A③ is overfilled.	Do not attempt to screw out the safety valve A①. Otherwise scalding could result. Release the trigger lock A⑧, press the trigger A⑨, hold it down and wait a while. When the volume of water in the water tank A③ is reduced, space for the formation of steam will be created and pressure will increase.
Steam pressure falls suddenly.	The water tank A③ is almost empty.	Add water to the water tank A③ according to the instructions contained in chapter Filling the water tank.
Water is being released from the steam cleaner instead of steam.	The water tank A③ is overfilled.	Turn off the steam cleaner and disconnect it from the power socket. Allow it to cool down. Then remove all water from the water tank A③. Fill the water tank A③ with max. 250 ml of water according to the instructions contained in the chapter Filling the water tank.
It is not possible to press the steam release trigger A⑨.	The trigger lock A⑧ is not released.	Slide the trigger lock A⑧ forward towards the open padlock symbol to release it. Hold down the trigger lock A⑧ in this position and press the steam release trigger A⑨.
The safety valve A① cannot be screwed out.	The pressure in the water tank A③ is too high and when opened there would be a risk of scalding.	Release the trigger lock A⑧, press trigger A⑨ and hold it down until all the steam is released from the water tank A③. Then carefully release the safety valve A①. Wait approximately 5 minutes for the water in the water tank A③ to cool down. Then you can completely screw out the safety valve A① and take it off the filling opening.

MAINTENANCE AND CLEANING

Cleaning

- Make sure that the steam cleaner is turned off and disconnected from the power socket. Before cleaning, release the remaining steam and allow the steam cleaner to cool down.
- Slowly screw out the safety valve A① in the anticlockwise direction.
- Pour the unused water out of the water tank A③.
- To prevent the formation of mineral deposits inside the water tank A③, rinse it out with clean water after every use. Do not leave water inside it.
- Remove any accessories that you used from the steam cleaner. Wipe the accessories with a dampened cloth or wash it in warm water using a neutral kitchen detergent. Then rinse under clean running water and thoroughly wipe dry.



Attention:

The accessories are not designed to be washed in a dishwasher.

- You may wash the textile sleeve A⑥ by hand or in a washing machine at a temperature of 40 °C. Do not use bleaches or fabric softeners when washing it.
- Wipe the outer surface of the steam cleaner with a lightly dampened cloth and then wipe dry.
- Never use cleaning agents causing abrasion, petrol, solvents, etc. to clean the steam cleaner and its accessories.
- To prevent potential injury by electric shock, do not submerge the steam cleaner or its power cord in water or any other liquid.

STORAGE

- Store the steam cleaner that has been cleaned according to the provided instructions in a dry, clean place out of the reach of children.

TECHNICAL SPECIFICATIONS

Rated voltage range	220–240 V
Rated frequency	50/60 Hz
Rated power	900–1050 W
Protection level against harmful ingress of water	IPX4

Explanation of technical terminology

The protection level against harmful ingress of water IPX4 means that the appliance is protected against splashing water.

We reserve the right to change text and technical specifications.

INSTRUCTIONS AND INFORMATION REGARDING THE DISPOSAL OF USED PACKAGING MATERIALS

Dispose of used packaging material at a site designated for waste in your municipality.

DISPOSAL OF USED ELECTRICAL AND ELECTRONIC EQUIPMENT

The meaning of the symbol on the product, its accessory or packaging indicates that this product shall not be treated as household waste. Please, dispose of this product at your applicable collection point for the recycling of electrical & electronic equipment waste. Alternatively in some states of the European Union or other European states you may return your products to your local retailer when buying an equivalent new product. The correct disposal of this product will help save valuable natural resources and help in preventing the potential negative impact on the environment and human health, which could be caused as a result of improper liquidation of waste. Please ask your local authorities or the nearest waste collection centre for further details. The improper disposal of this type of waste may fall subject to national regulations for fines.

For business entities in European Union states

If you want to dispose of electric or electronic appliances, ask your retailer or supplier for the necessary information.

Disposal in other countries outside the European Union.

This symbol is valid in the European Union. If you wish to dispose of this product, request the necessary information about the correct disposal method from the local council or from your retailer.



This product meets all the basic requirements of EU directives related to it.

Ovaj dokument je originalno proizveden i objavljen od strane proizvođača, brenda Sencor, i preuzet je sa njihove zvanične stranice. S obzirom na ovu činjenicu, Tehnoteka ističe da ne preuzima odgovornost za tačnost, celovitost ili pouzdanost informacija, podataka, mišljenja, saveta ili izjava sadržanih u ovom dokumentu.

Napominjemo da Tehnoteka nema ovlašćenje da izvrši bilo kakve izmene ili dopune na ovom dokumentu, stoga nismo odgovorni za eventualne greške, propuste ili netačnosti koje se mogu naći unutar njega. Tehnoteka ne odgovara za štetu nanесenu korisnicima pri upotrebi netačnih podataka. Ukoliko imate dodatna pitanja o proizvodu, ljubazno vas molimo da kontaktirate direktno proizvođača kako biste dobili sve detaljne informacije.

Za najnovije informacije o ceni, dostupnim akcijama i tehničkim karakteristikama proizvoda koji se pominje u ovom dokumentu, molimo posetite našu stranicu klikom na sledeći link:

<https://tehnoteka.rs/p/sencor-parocistac-ssc-3001yl-akcija-cena/>