

Uputstvo za upotrebu (EN)

SENCOR cediljka SCJ 1051GR

SENCOR



Tehnoteka je online destinacija za upoređivanje cena i karakteristika bele tehnike, potrošačke elektronike i IT uređaja kod trgovinskih lanaca i internet prodavnica u Srbiji. Naša stranica vam omogućava da istražite najnovije informacije, detaljne karakteristike i konkurentne cene proizvoda.

Posetite nas i uživajte u ekskluzivnom iskustvu pametne kupovine klikom na link:

<https://tehnoteka.rs/p/sencor-cediljka-scj-1051gr-akcija-cena/>

Citrus Juicer

User's manual

EN



SENCOR®

SCJ 1051GR

Prior to using this appliance, please read the user's manual thoroughly, even in cases, when one has already familiarised themselves with previous use of similar types of appliances. Only use the appliance in the manner described in this user's manual. Keep this user's manual in a safe place where it can be easily retrieved for future use.

We recommend saving the original shipping cardboard box, packaging material, receipt and warranty card for the duration of warranty. In the case of transportation, pack the appliance using the original packaging materials only.

TABLE OF CONTENTS

IMPORTANT SAFETY INSTRUCTIONS	3
DESCRIPTION OF THE CITRUS JUICER	6
BEFORE FIRST USE	7
ASSEMBLING AND DISASSEMBLING THE CITRUS JUICER	7
OPERATING THE CITRUS JUICER	7
CLEANING AND MAINTENANCE	8
STORAGE	8
TECHNICAL SPECIFICATIONS	8
INSTRUCTIONS AND INFORMATION REGARDING THE DISPOSAL OF USED PACKAGING MATERIALS ..	9
DISPOSAL OF USED ELECTRICAL AND ELECTRONIC EQUIPMENT	9

IMPORTANT SAFETY INSTRUCTIONS READ CAREFULLY AND STORE FOR FUTURE USE.

- This appliance may be used by children 8 years of age and older and by persons with physical or mental impairments or by inexperienced persons, if they are properly supervised or have been informed about how to use of the product in a safe manner and understand the potential dangers. Children must not play with the appliance. Cleaning and maintenance must not be performed by children unless they are older than 8 years of age and under supervision.
- Keep this appliance and the power cord out of reach of children younger than 8 years of age.
- Before connecting this appliance to the power socket, make sure the voltage stated on the label of the product corresponds to the voltage in your wall socket.
- Never use accessories, which have not been supplied with this appliance or which have not been explicitly recommended by the manufacturer for this appliance.

- This appliance is intended and designed for processing a standard amount of food in the household.
- Do not use the appliance for any other purposes than those intended.
- Do not use the appliance in industrial surroundings or outdoors.
- Only place the appliance on an even, dry and stable surface.
- Do not place the appliance on an electric or gas stove or in its vicinity, do not place it in the vicinity of an open fire or an appliance that is a source of heat.
- Make sure that the appliance is correctly assembled before putting it into operation.
- When operating the appliance, do not place items such as kitchen knives, forks, etc. near the rotating cone or into the strainer.
- Always disconnect the appliance from the power socket if you will not be using it and if you are leaving it without supervision, before assembly, disassembly or cleaning.
- Do not wash the base unit of the appliance under running water or submerge it in water or another liquid.

- Ensure that the power plug contacts do not come into contact with water or moisture.
- Do not place heavy items on the power cord. Make sure the power cord does not hang over the edge of a table or that it does not touch a hot surface.
- Do not disconnect the appliance from the power socket by pulling on the power cord. This could damage the power cord or the power socket. Disconnect the cord from the power socket by gently pulling on the plug of the power cord.
- It is forbidden to use the appliance if it has a damaged power cord or plug. If the power cord is damaged, have it replaced at a professional service centre.
- To avoid the danger of injury by electrical shock, do not repair the appliance yourself or make any adjustments to it. Have all repairs or adjustments of the appliance performed at an authorised service centre. Tampering with the appliance during the warranty period may void the warranty.

DESCRIPTION OF THE CITRUS JUICER

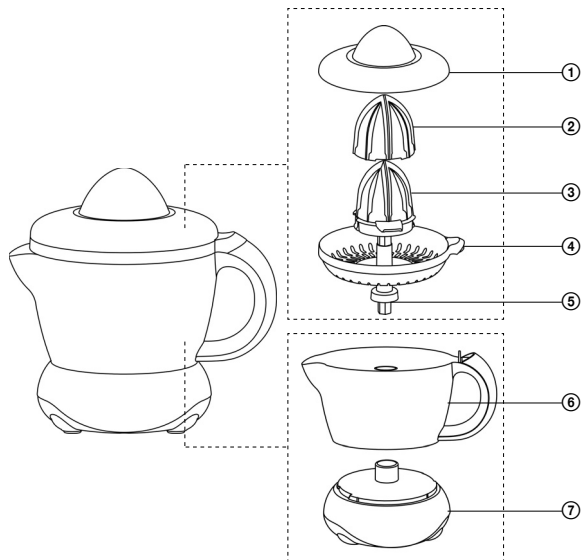
A

- ① Cover
- ② Juicing cone for large citrus fruits
- ③ Juicing cone for small citrus fruits
- ④ Pulp strainer

- ⑤ Motor shaft
- ⑥ Juice collector
- ⑦ Base unit with motor

BEFORE FIRST USE

- 1) Remove packaging materials from the appliance and its accessories. Take the juicing cone A② out of the juicing cone A③.
- 2) Thoroughly wash the cover A①, the juicing cone A② and A③, the strainer A④ and the juice container A⑥ using warm water with kitchen detergent. Then rinse all these parts under clean running water and thoroughly wipe dry with a fine wiping cloth.

ASSEMBLING AND DISASSEMBLING THE CITRUS JUICER

- 1) Place the base unit A⑦ on an even, dry and stable surface. The appliance must be disconnected from the el. power socket during assembly and disassembly.
- 2) Place the juice container A⑥ on to the base unit A⑦ so that the shaft of the motor A⑤ is located in the hole in the middle part of the juice container A⑥.
- 3) Place the strainer A④ into the juice container A⑥.
- 4) If you are going to juice smaller citrus fruits, place the juicing cone A③ on to the motor shaft. If you are going to juice larger citrus fruits, first insert juicing cone A③ into cone A②. Make sure that the cones fit together properly. Place the cone assembled in this way on to the motor shaft.
- 5) If you wish to disassemble the citrus juicer, proceed in the reverse sequence.

OPERATING THE CITRUS JUICER

- 1) Make sure that the citrus juicer is correctly assembled and then connect it to a power socket.
- 2) Slice the citrus fruits that you wish to juice transversely in half.
- 3) Take one half of the citrus fruit and gently push the cut side on to the juicing cone A② or A③. When the citrus fruit is pushed on to the cone, the motor will engage automatically and the cone will begin to rotate. When you release the pressure, the motor will stop. Take the pressed out half of the citrus fruit off the cone and you can continue pressing more fruit.



Tip:

You will extract the most juice from the fruit by pressing it down several times on to the juicing cone for a short time.



Attention:

Do not exert too much pressure on to the juicing cone because this could choke the motor. The maximum continuous operating time is 2 minutes. After 2 minutes of continuous operation leave the appliance to rest for 3 minutes.

- 4) After you finish using the citrus juicer, disconnect the power cord from the power socket.

CLEANING AND MAINTENANCE

- Clean the appliance after every use. Disconnect it from the power socket before cleaning it.
- Grasp the juice container A⑥ by the handle, then turn it anticlockwise to release it and lift it up together with the remaining accessories, which are located inside it. Take it to the sink and disassemble the accessories into their individual parts. Thoroughly wash all these parts using warm water and kitchen detergent. Then rinse them under clean running water and thoroughly wipe dry with a fine wiping cloth.



Note:

We recommend that you wash the accessories immediately after use to prevent the pulp from drying on. It is harder to remove it later.

- For cleaning the base unit A⑦ use a cloth lightly dipped in a weak solution of water and neutral kitchen detergent. Then thoroughly dry the surface of the base unit A⑦.
- Do not use abrasive cleaning products, solvents, thinners, etc. Otherwise the surface may be damaged.

STORAGE

- When not using the appliance, store it in a dry place out of children's reach. You can store the appliance assembled. Cover A① protects accessories that are designed for direct contact with food against dust.

TECHNICAL SPECIFICATIONS

Rated voltage range	230 V
Rated frequency	50 Hz
Rated power input	40 W
Electrical shock protection class	II
Noise level	75 dB(A)

The declared noise emission level of the appliance is 75 dB(A), which represents a level A of acoustic power with respect to a reference acoustic power of 1 pW.

Explanation of technical terminology

Safety class for electrical shock protection:

Class II – Electrical shock protection is provided by double or heavy-duty insulation.

Changes to text and technical parameters are reserved.

INSTRUCTIONS AND INFORMATION REGARDING THE DISPOSAL OF USED PACKAGING MATERIALS

Dispose of used packaging material at a site designated for waste in your municipality.

DISPOSAL OF USED ELECTRICAL AND ELECTRONIC EQUIPMENT

This symbol on products or original documents means that used electric or electronic products must not be added to ordinary municipal waste. For proper disposal, renewal and recycling hand over these appliances to determined collection points. Alternatively, in some European Union states or other European countries you may return your appliances to the local retailer when buying an equivalent new appliance. Correct disposal of this product helps save valuable natural resources and prevents potential negative effects on the environment and human health, which could result from improper waste disposal. Ask your local authorities or collection facility for more details. In accordance with national regulations penalties may be imposed for the incorrect disposal of this type of waste.

For business entities in European Union states

If you want to dispose of electric or electronic appliances, ask your retailer or supplier for the necessary information.

Disposal in other countries outside the European Union.

This symbol is valid in the European Union. If you wish to dispose of this product, request the necessary information about the correct disposal method from the local council or from your retailer.



This appliance meets all the basic requirements of EU directives related to it.

Citrus Juicer

SCJ 1051GR

Ovaj dokument je originalno proizveden i objavljen od strane proizvođača, brenda Sencor, i preuzet je sa njihove zvanične stranice. S obzirom na ovu činjenicu, Tehnoteka ističe da ne preuzima odgovornost za tačnost, celovitost ili pouzdanost informacija, podataka, mišljenja, saveta ili izjava sadržanih u ovom dokumentu.

Napominjemo da Tehnoteka nema ovlašćenje da izvrši bilo kakve izmene ili dopune na ovom dokumentu, stoga nismo odgovorni za eventualne greške, propuste ili netačnosti koje se mogu naći unutar njega. Tehnoteka ne odgovara za štetu nanесenu korisnicima pri upotrebi netačnih podataka. Ukoliko imate dodatna pitanja o proizvodu, ljubazno vas molimo da kontaktirate direktno proizvođača kako biste dobili sve detaljne informacije.

Za najnovije informacije o ceni, dostupnim akcijama i tehničkim karakteristikama proizvoda koji se pominje u ovom dokumentu, molimo posetite našu stranicu klikom na sledeći link:

<https://tehnoteka.rs/p/sencor-cediljka-scj-1051gr-akcija-cena/>