

## Uputstvo za upotrebu (EN)

PHANTEKS kućište P400A

**PHANTEKS**

---



Tehnoteka je online destinacija za upoređivanje cena i karakteristika bele tehnike, potrošačke elektronike i IT uređaja kod trgovinskih lanaca i internet prodavnica u Srbiji. Naša stranica vam omogućava da istražite najnovije informacije, detaljne karakteristike i konkurentne cene proizvoda.

Posetite nas i uživajte u ekskluzivnom iskustvu pametne kupovine klikom na link:

<https://tehnoteka.rs/p/phanteks-kuciste-p400a-akcija-cena/>

CABLE CONNECTION

CONNECT TO D-RGB LIGHTING PRODUCTS (P400A\_D MODEL)

**To DIGITAL-RGB Products**

**To D-RGB Motherboard (optional)**

Compatible with:

MOTHERBOARD D-RGB HEADER

CONNECT TO THE MOTHERBOARD

CONNECT TO RGB LIGHTING PRODUCTS (P400(S) MODELS)

**To RGB Products**

**To RGB Motherboard (optional)\***

Compatible with:

MOTHERBOARD RGB HEADER

\*Motherboard Adapter is sold separately (PH-CB\_RGB4P)

CONNECT TO THE POWER SUPPLY

CONNECT TO THE 3-PIN FANS

To 3-PIN FAN

\*P400S and P400A models only

OPTIONAL UPGRADES

VERTICAL GPU BRACKET (PH-VGPUKT-02)

THE PHANTEKS VERTICAL GPU BRACKET CAN BE EASILY INSTALLED IN THE REAR PCI-SLOT AREA WITHOUT MODIFICATIONS. FOLLOW THE INSTRUCTION THAT COME WITH THE VERTICAL GPU BRACKET.

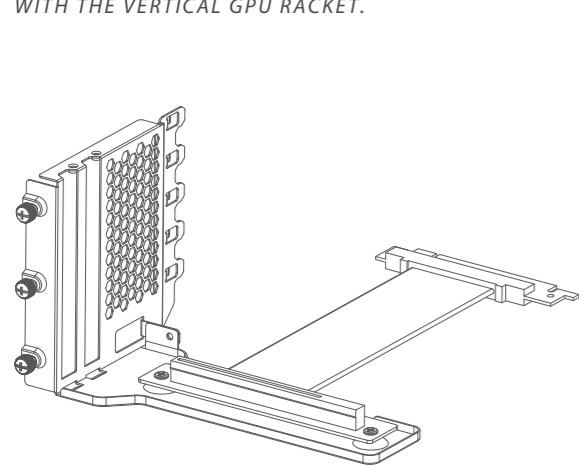

MODULAR HDD BRACKET (PH-HDDKT\_02)

UP TO 4 ADDITIONAL HDD DRIVES CAN BE INSTALLED USING THE MODULAR HDD BRACKET.

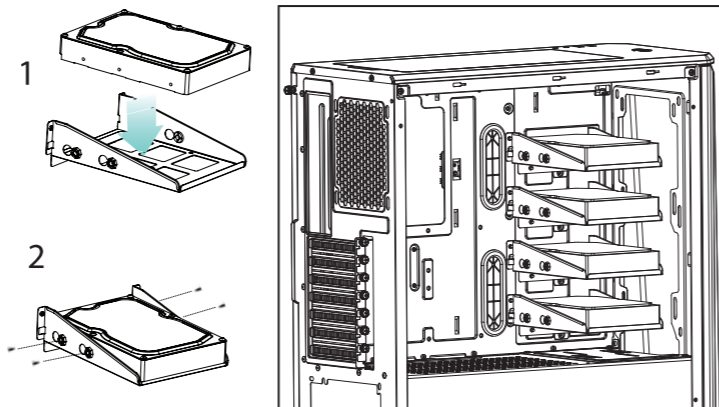

INTRODUCTION

Thank you for choosing Phanteks. Please take a moment to carefully go through the manual. Phanteks will not take responsibility for any damages incurred due to incorrect installation or usage of this product.

This manual is applicable for the following products:

- PH-EC400ATG
- PH-EC400ATG\_D
- PH-EC416PTG
- PH-EC416PSTG

INCLUDED ACCESSORIES

Eclipse P400A / Eclipse 400(S)

PRODUCT OVERVIEW

**CLEARANCE**

CPU Cooler Height	160mm
PSU Clearance	270mm
GPU Clearance	420mm
E-ATX Motherboard	272mm
360mm Front radiator	130x420x115mm
280mm Front radiator	145x325mm

**REAR**

120 FAN	120
120 RAD	120

**TOP**

120 FAN	120
140 FAN	140

**FRONT**

120 FAN	120
120 RAD	240
140 FAN	140
140 RAD	280

\*remove the mid-plate cover

**ECLIPSE P400A FRONT I/O**

**ECLIPSE P400(S) FRONT I/O**

English	Français
1. Headphone	1. Casque
2. Microphone	2. Microphone
3. USB 3.0	3. USB 3.0
4. HDD LED	4. HDD LED
5. Power Button	5. Bouton d'alimentation
6. Fan Control	6. Contrôle du ventilateur
7. Reset Button	7. Bouton de réinitialisation
8. RGB Control	8. RGB Contrôle
9. D-RGB Mode	9. D-RGB Mode
10. D-RGB Color	10. D-RGB Couleur

Deutsch	Espanol
1. Kopfhörer	1. Auricular
2. Mikrophon	2. Micrófono
3. USB 3.0	3. USB 3.0
4. HDD LED	4. HDD LED
5. Ein-/Aus Schalter	5. Botón de encendido
6. Lüftersteuerung	6. Control del ventilador
7. Reset-Knopf	7. Botón de reinicio
8. RGB Steuerung	8. RGB Controlador
9. D-RGB Modus	9. D-RGB Mode
10. D-RGB Farbe	10. D-RGB Color

**PRO TIP** The 3-pin fan controller allows you to set any connected fans to low, medium or full speed.

LIGHTING CONTROLS

**Digital-RGB CONTROLS (P400A\_D MODEL)**

MODES: SOLID, BREATHING, RADAR, SPARKLE, RAINBOW

COLORS: [Color palette]

2 SEC PRESS AND HOLD THE MODE BUTTON TO TURN OFF LEDS

**RGB CONTROLS (P400(S) MODELS)**

- Short Press to change color: [Color palette]
- Long Press to change mode: Solid, Breathing, Color Cycle
- Press and Hold to turn off or switch to motherboard control.

**PRO TIP** Press and Hold to turn off the case controller to sync with the motherboard RGB or D-RGB software.

INTRODUCTION

There are three panels that can be removed from the P400 Chassis; the left side tempered glass panel, the right side panel and the front panel. Follow these steps below.

LEFT SIDE PANEL

1. REMOVE 4 THUMB SCREWS



2. REMOVE TEMPERED GLASS PANEL

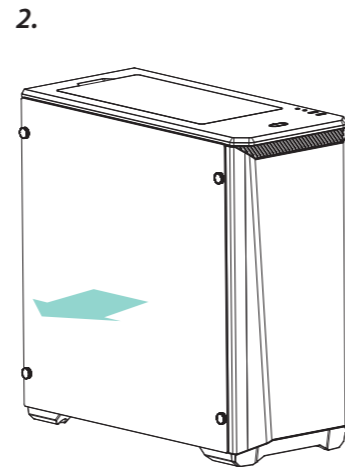
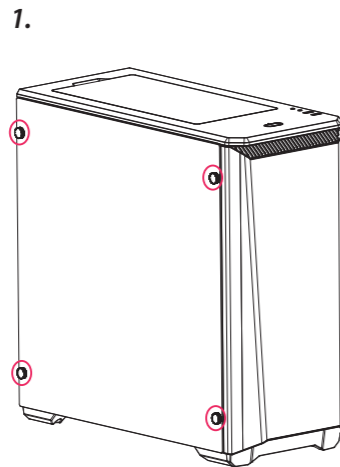

RIGHT SIDE PANEL

1. LOOSEN THUMB SCREWS



2. SLIDE SIDE PANEL OFF

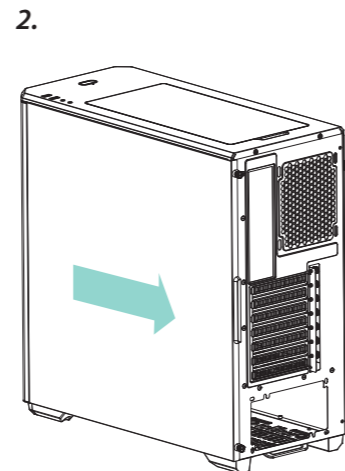
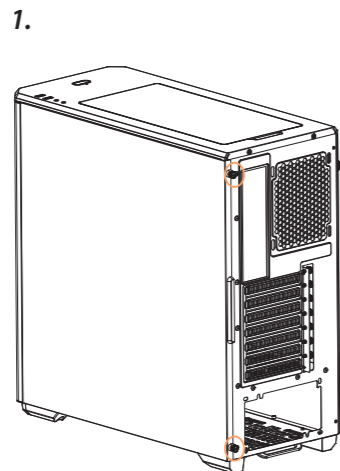

FRONT PANEL

1. REMOVE FRONT PANEL BY PULLING ON THE PANEL FROM BELOW

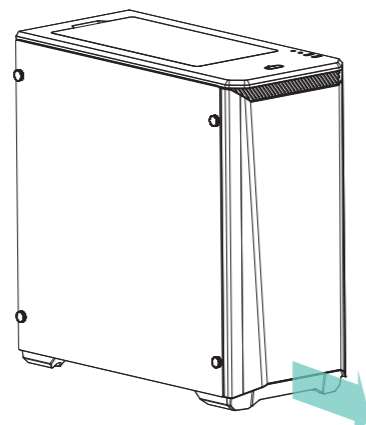

With the P400(S) models you can access the dust filters after removing the front panel. We recommend to clean the dust filters every month for optimal performance.

HARDWARE INSTALLATION

MOTHERBOARD

1. INSTALL THE MOTHERBOARD WITH 9 MOTHERBOARD SCREWS

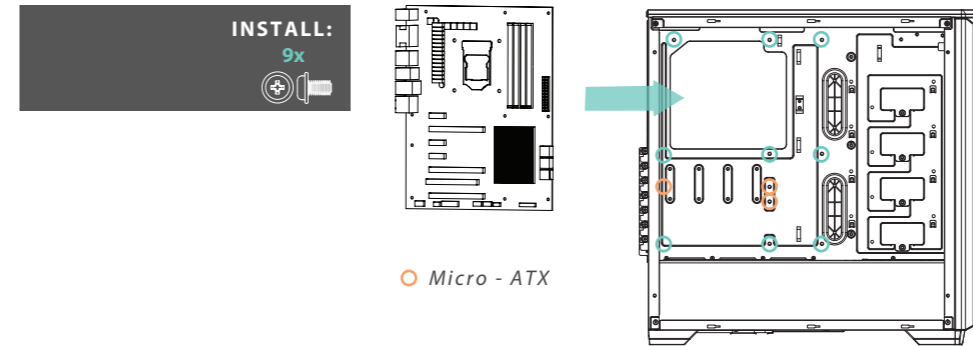

POWER SUPPLY

1. INSTALL THE POWER SUPPLY WITH 4 PSU SCREWS

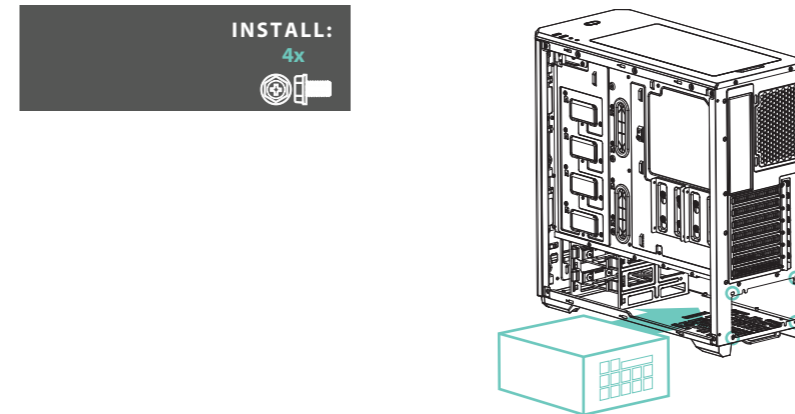

2.5" SSD

1. INSTALL THE SSD DRIVE WITH 4 SSD SCREWS

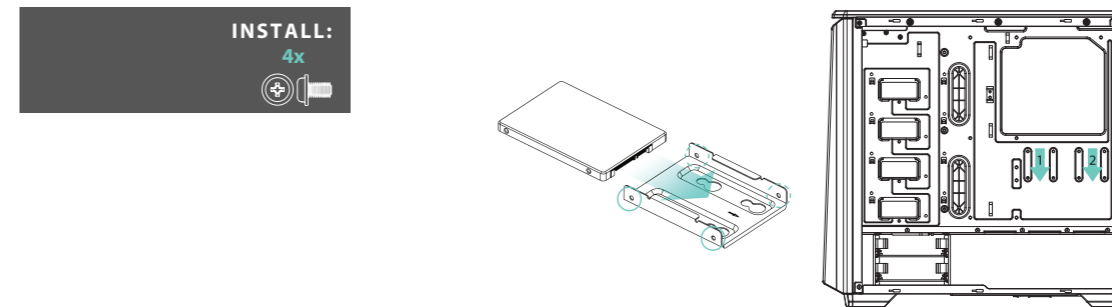

3.5" HDD

1. INSTALL THE HDD DRIVE IN THE TOOLLES HDD TRAY AND SLIDE IT BACK INTO THE CHASSIS

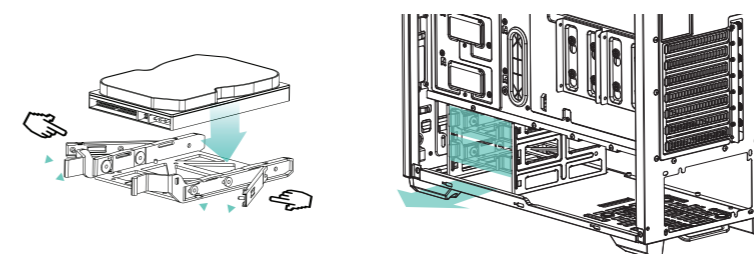

The HDD Tray can also hold a 2.5" SSD

Ovaj dokument je originalno proizveden i objavljen od strane proizvođača, brenda PHANTEKS, i preuzet je sa njihove zvanične stranice. S obzirom na ovu činjenicu, Tehnoteka ističe da ne preuzima odgovornost za tačnost, celovitost ili pouzdanost informacija, podataka, mišljenja, saveta ili izjava sadržanih u ovom dokumentu.

Napominjemo da Tehnoteka nema ovlašćenje da izvrši bilo kakve izmene ili dopune na ovom dokumentu, stoga nismo odgovorni za eventualne greške, propuste ili netačnosti koje se mogu naći unutar njega. Tehnoteka ne odgovara za štetu nanесenu korisnicima pri upotrebi netačnih podataka. Ukoliko imate dodatna pitanja o proizvodu, ljubazno vas molimo da kontaktirate direktno proizvođača kako biste dobili sve detaljne informacije.

Za najnovije informacije o ceni, dostupnim akcijama i tehničkim karakteristikama proizvoda koji se pominje u ovom dokumentu, molimo posetite našu stranicu klikom na sledeći link:

<https://tehnoteka.rs/p/phanteks-kuciste-p400a-akcija-cena/>