

## Uputstvo za upotrebu (EN)

LOGITECH zvučnici za kompjuter Z533 2.1

logitech



Tehnoteka je online destinacija za upoređivanje cena i karakteristika bele tehnike, potrošačke elektronike i IT uređaja kod trgovinskih lanaca i internet prodavnica u Srbiji. Naša stranica vam omogućava da istražite najnovije informacije, detaljne karakteristike i konkurentne cene proizvoda.

Posetite nas i uživajte u ekskluzivnom iskustvu pametne kupovine klikom na link:

<https://tehnoteka.rs/p/logitech-zvucnici-za-kompjuter-z533-21-akcija-cena/>

# Z533 SPEAKER SYSTEM WITH SUBWOOFER

## SYSTÈME DE HAUT-PARLEURS Z533 AVEC CAISSON DE BASSES

Complete Setup Guide  
Guide d'installation complet

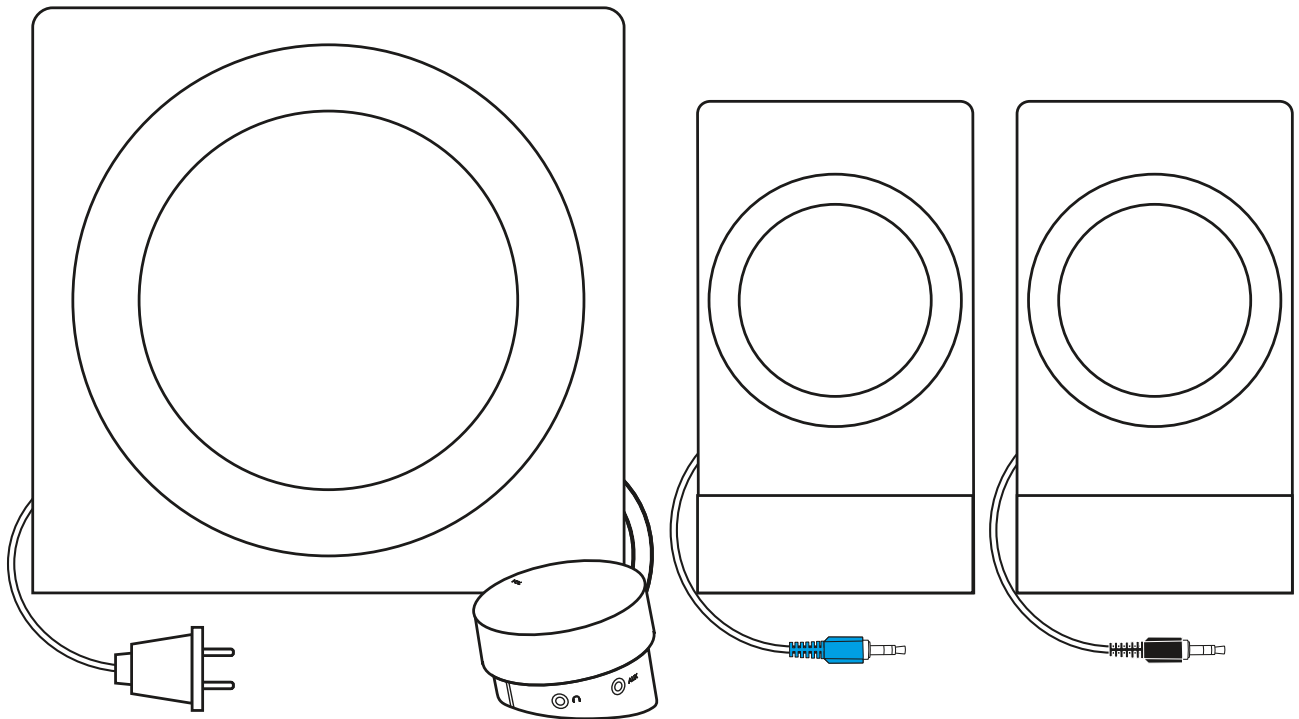

## CONTENTS

English . . . . .3

Français . . . . .8

Español . . . . . 13

Português . . . . . 18

# KNOW YOUR PRODUCT

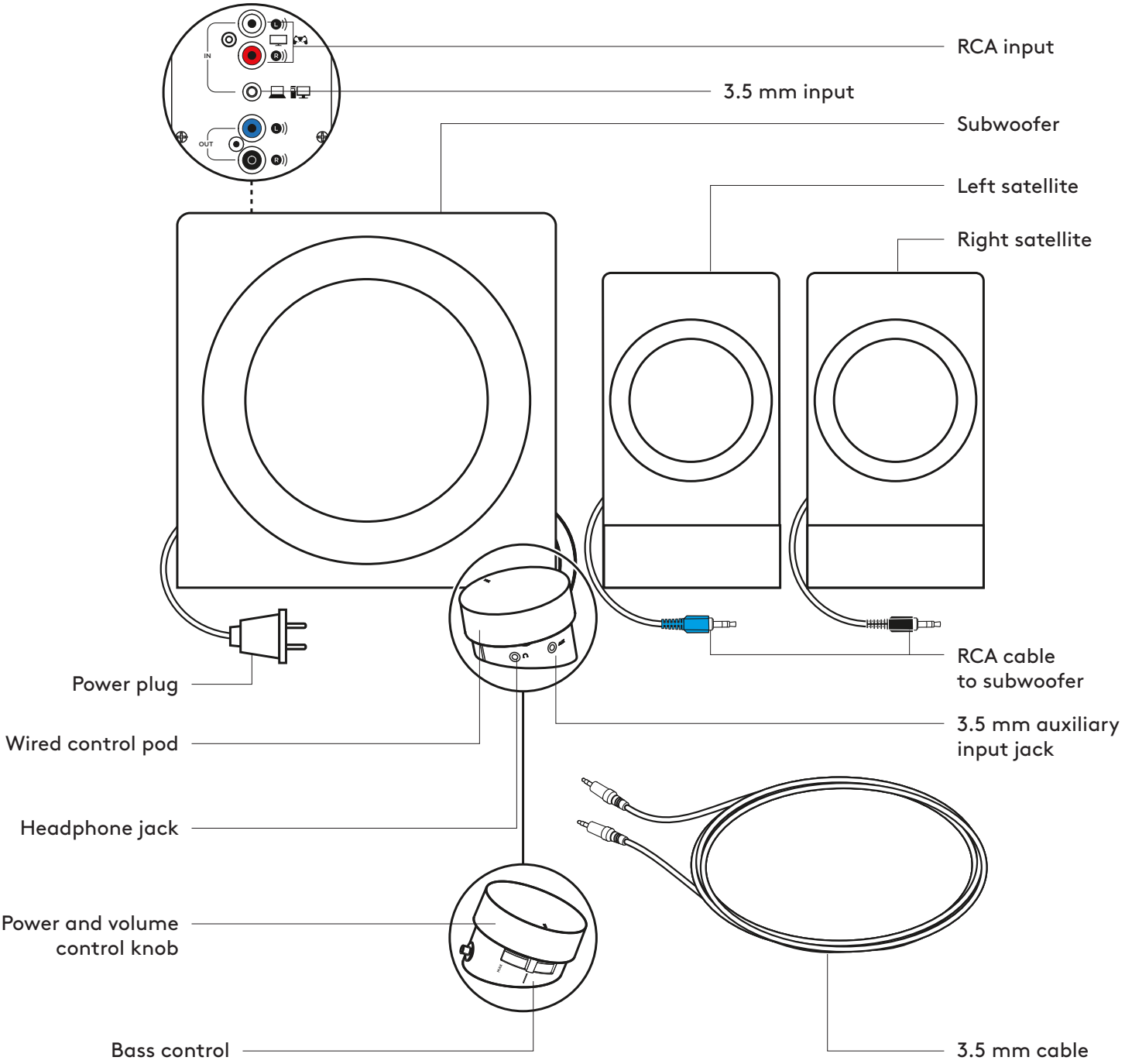

## CONNECT THE SPEAKERS

1. Plug the black RCA connector on the right satellite into the black subwoofer jack.
2. Plug the blue RCA connector on the left satellite into the blue subwoofer jack.
3. Plug the power plug into an electrical outlet.

1

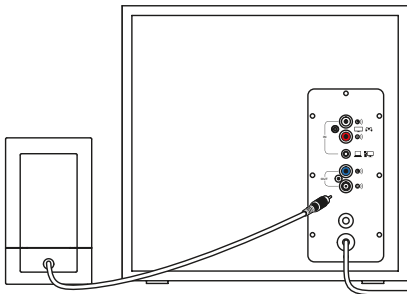

2

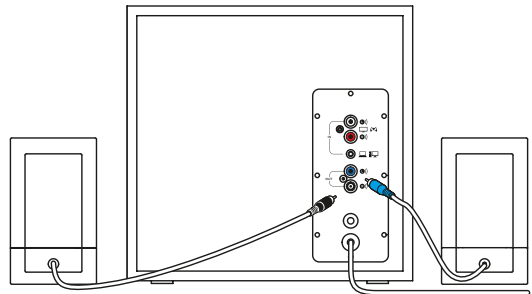

3

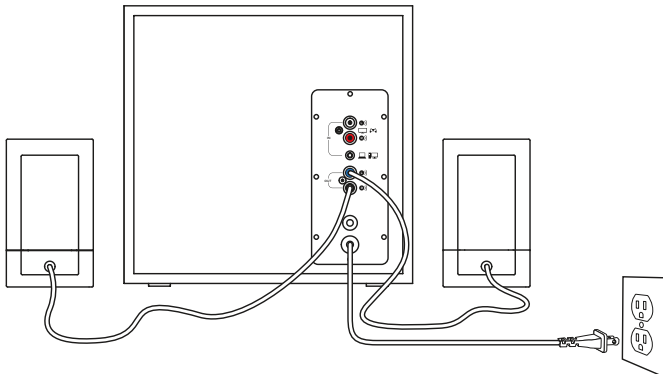

## CONNECT TO AUDIO SOURCE

### 1A. For 3.5 mm connection:

Connect one end of the provided 3.5 mm cable to the corresponding jack on the back of subwoofer or the 3.5 mm jack on the control pod. Insert the other end of the 3.5 mm cable into the audio jack on your device (computer, smartphone, tablet, etc.)

### 1B. For RCA connection:

Connect one end of the RCA cable to the corresponding RCA jack on the back of subwoofer. Insert the other end of the RCA cable into the RCA outlet on your device (TV, gaming console, etc.)

Note: The RCA cable is not included in the box and must be purchased separately.

2. Plug your headphones into the headphone jack on the control pod. Adjust the volume either from the control pod or the audio source.
3. Power speakers on/off by turning clockwise the volume knob on the control pod. You will notice a “click” sound once the system is ON (the LED in front of the wired remote will also turn on).

# 1A

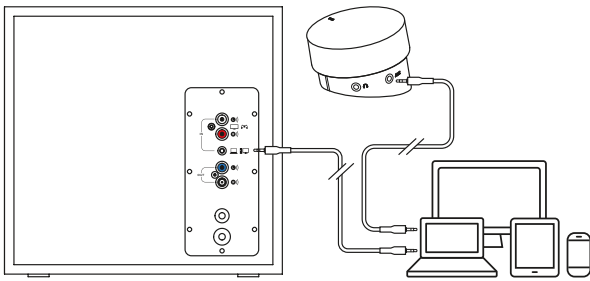

# 1B

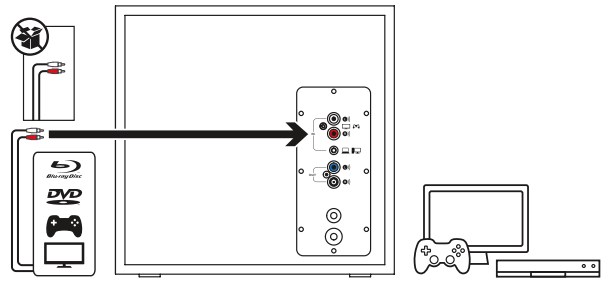

# 2

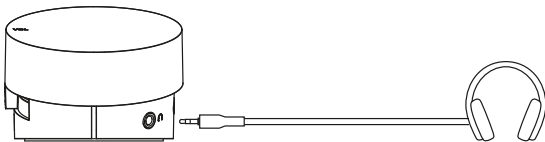

# 3

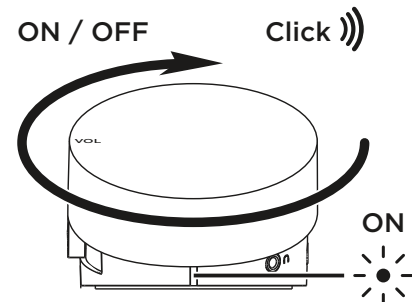

## CONNECT TO TWO DEVICES SIMULTANEOUSLY

1. Connect to two devices at the same time through the RCA connector and 3.5 mm input on the back of subwoofer.
2. To switch between audio sources, just pause audio on one connected device and play audio from the other connected device.

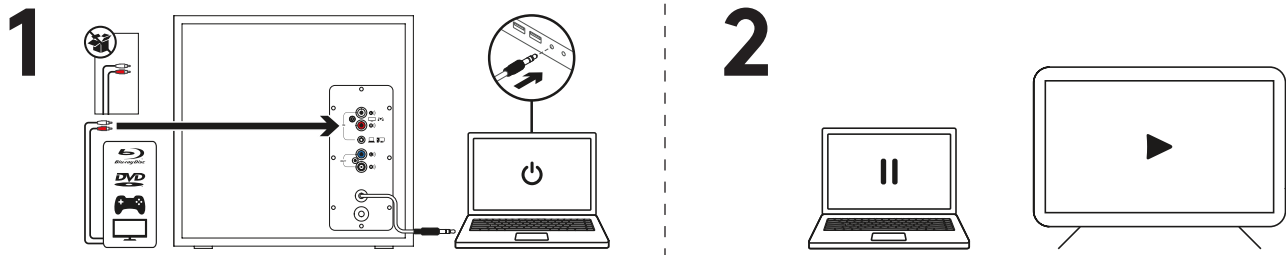

## ADJUST THE VOLUME

1. Adjust the volume of Z533 with the knob on the control pod.  
Turn the knob clockwise (to the right) to increase volume.  
Turn the knob counter-clockwise (to the left) to decrease volume.

## ADJUST THE BASS

2. Adjust the bass level by moving the bass slider on the side of the control pod.

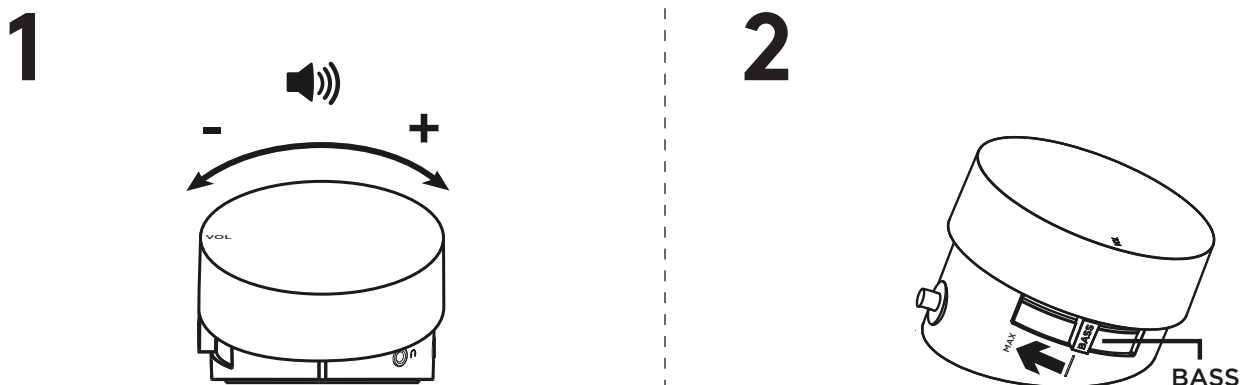

[www.logitech.com/support/Z533](http://www.logitech.com/support/Z533)



# PRÉSENTATION DU PRODUIT

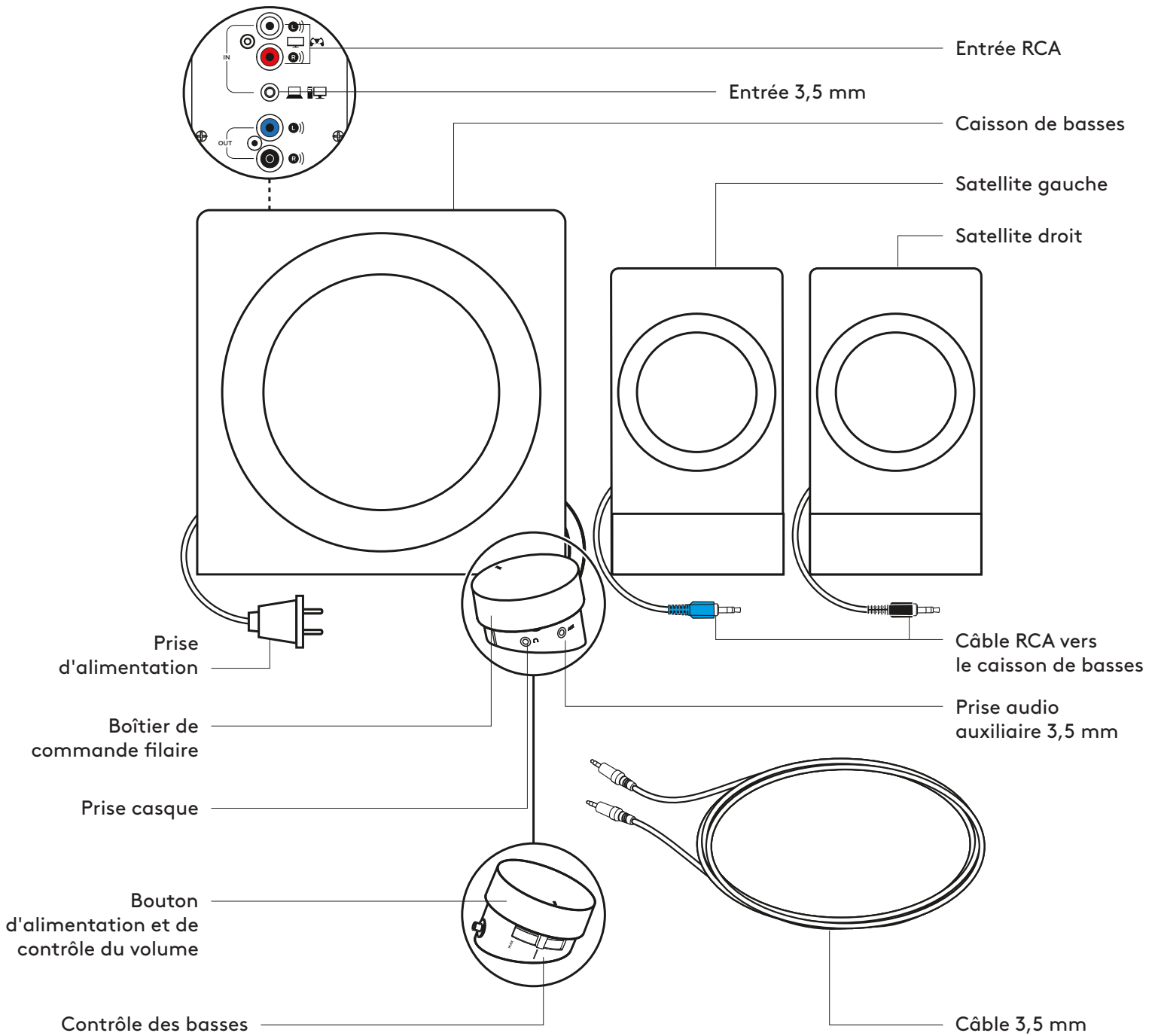

## CONNEXION DES HAUT-PARLEURS

1. Branchez le connecteur RCA noir sur la prise noire du caisson de basses située sur le satellite droit.
2. Branchez le connecteur RCA bleu sur la prise bleue du caisson de basse située sur le satellite gauche.
3. Branchez l'adaptateur secteur à une prise électrique.

1

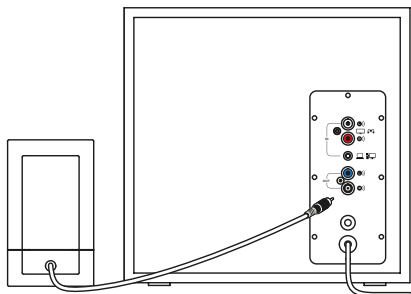

2

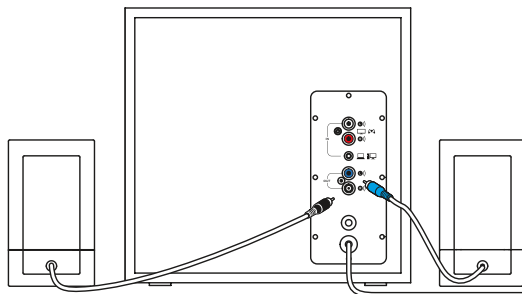

3

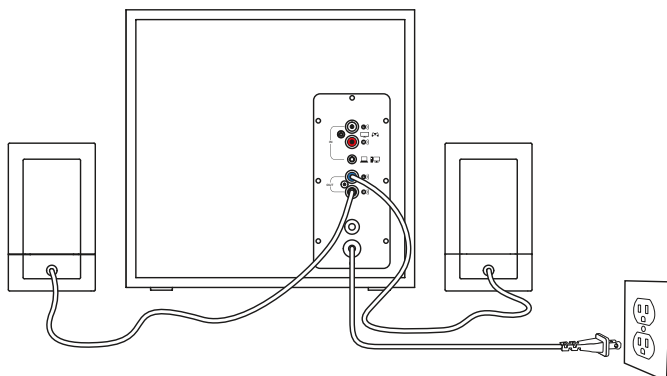

## CONNEXION À LA SOURCE AUDIO

1A. Pour la connexion 3,5 mm:

connectez une extrémité du câble 3,5 mm fourni sur l'entrée audio correspondante à l'arrière du caisson de basses ou sur la prise audio 3,5 mm du boîtier de commande. Insérez l'autre extrémité du câble 3,5 mm dans la prise audio de votre dispositif (ordinateur, smartphone, tablette, etc.)

1B. Pour la connexion RCA:

connectez une extrémité du câble RCA à la prise RCA correspondante à l'arrière du caisson de basses. Insérez l'autre extrémité du câble RCA dans la prise RCA de votre dispositif (téléviseur, console de jeu, etc.)  
Remarque: Le câble RCA n'est pas fourni et doit être acheté séparément.

2. Branchez votre casque dans la prise audio du boîtier de commande. Réglez le volume à partir du boîtier de commande ou de la source audio.
3. Mettez les haut-parleurs sous/hors tension en tournant dans le sens des aiguilles d'une montre le bouton de volume du boîtier de commande. Vous entendrez un "clic" une fois le système sous tension (le témoin lumineux sur la télécommande filaire s'allume également).

# 1A

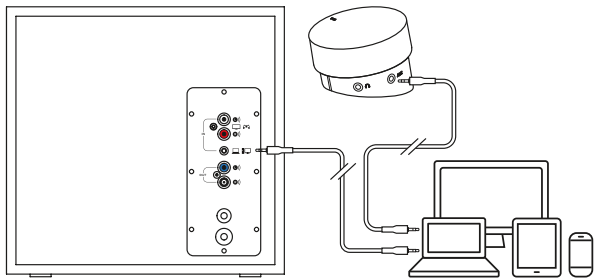

# 1B

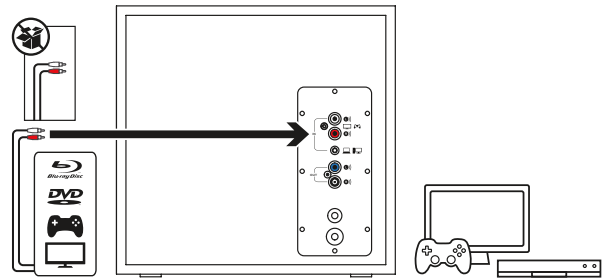

# 2

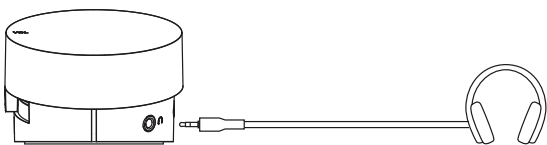

# 3

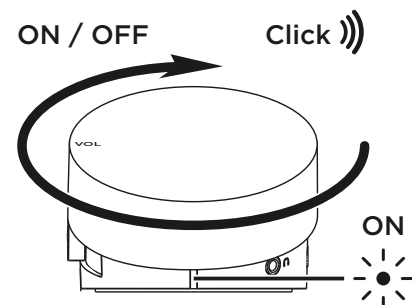

## SE CONNECTER À DEUX DISPOSITIFS SIMULTANÉMENT

1. Connectez deux dispositifs en même temps en passant par le connecteur RCA et l'entrée 3,5 mm à l'arrière du caisson de basses.
2. Pour basculer entre les sources audio, il suffit de suspendre l'audio sur un dispositif connecté et de lire l'audio depuis l'autre dispositif connecté.

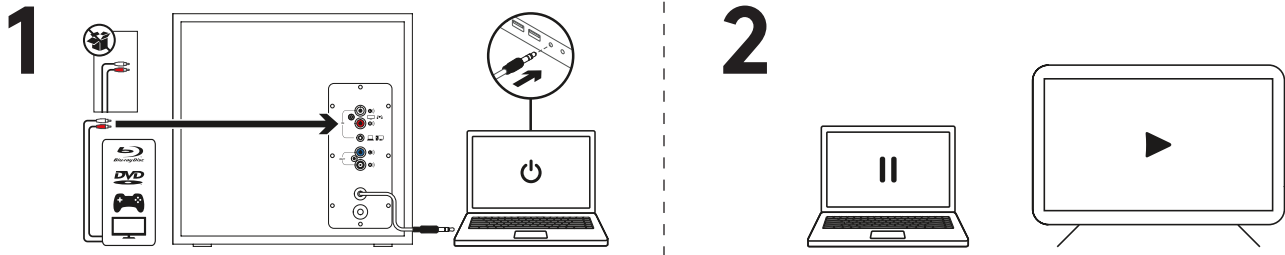

## AJUSTEMENT DU VOLUME

1. Réglez le volume des haut-parleurs Z533 à l'aide du bouton du boîtier de commande. Tournez le bouton dans le sens horaire (vers la droite) pour augmenter le volume. Tournez le bouton dans le sens antihoraire (vers la gauche) pour diminuer le volume.

## RÉGLER LES BASSES

2. Ajustez le niveau des basses en déplaçant le curseur de réglage situé sur le côté du boîtier de commande.

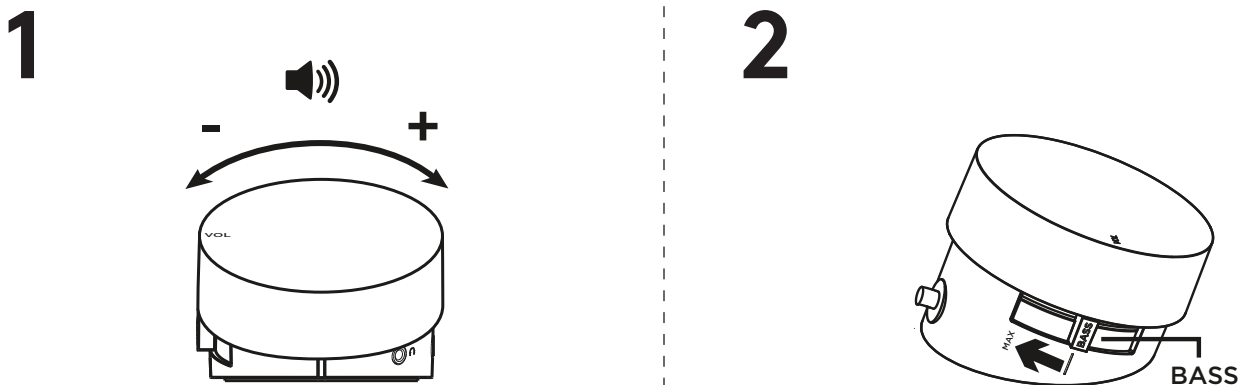

[www.logitech.com/support/Z533](http://www.logitech.com/support/Z533)

# COMPONENTES DEL PRODUCTO

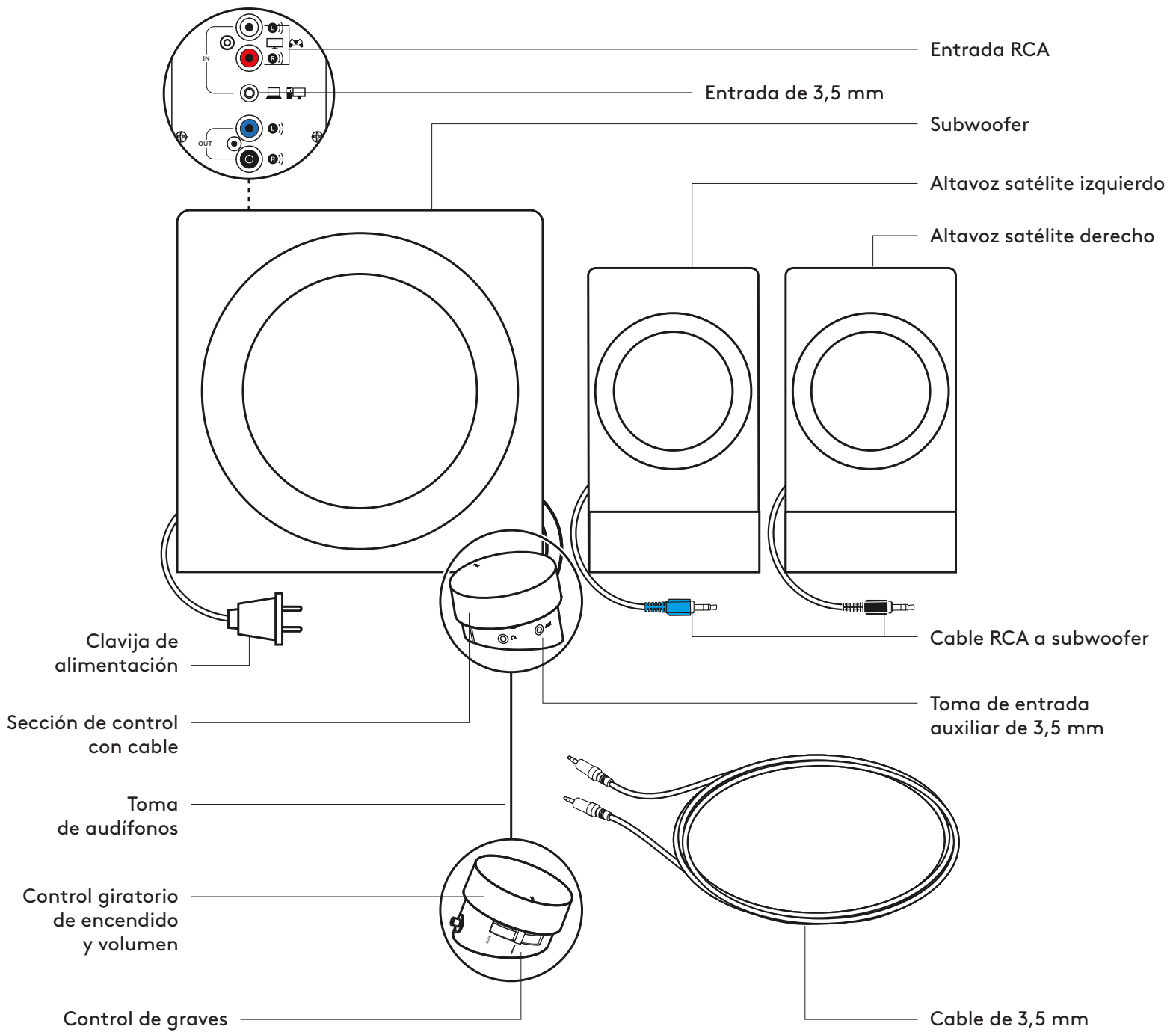

## CONECTA LOS ALTAVOCES

1. Conecta el conector RCA negro del altavoz satélite derecho a la toma de subwoofer negra.
2. Conecta el conector RCA azul del altavoz satélite izquierdo a la toma de subwoofer azul.
3. Conecta la clavija de alimentación a una toma de corriente.

1

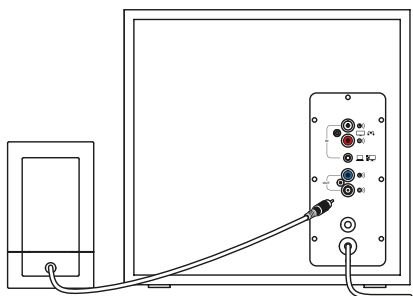

2

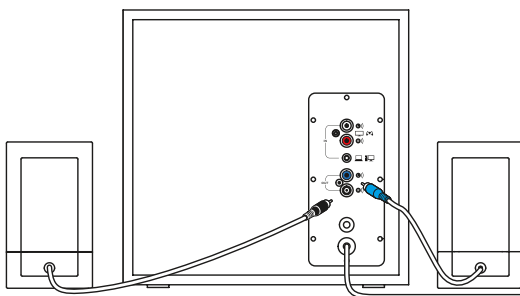

3

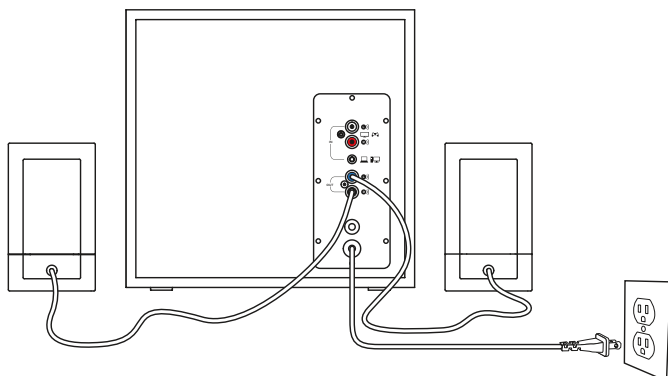

## CONECTA A LA FUENTE DE AUDIO

1A. Para la conexión de 3,5 mm:

Conecta un extremo del cable de 3,5 mm suministrado a la toma correspondiente en la parte posterior del subwoofer o la toma de 3,5 mm en la sección de control. Inserta el otro extremo del cable de 3,5 mm en la toma de audio de tu dispositivo (computadora, smartphone, tablet, etc.)

1B. Para la conexión RCA:

Conecta un extremo del cable RCA a la toma RCA correspondiente en la parte posterior del subwoofer. Inserta el otro extremo del cable RCA en la toma RCA de tu dispositivo (TV, consola de videojuegos, etc.)

Nota: El cable RCA no se incluye en la caja y debe adquirirse por separado.

2. Conecta los audífonos a la toma de audífonos de la sección de control. Ajusta el volumen desde la sección de control o la fuente de audio.

3. Enciende o apaga los altavoces girando el control giratorio de volumen en la sección de control en el sentido de las agujas del reloj. Al encenderse el sistema, se oirá un "click" (y se encenderá el LED en la parte frontal del mando con cable).

# 1A

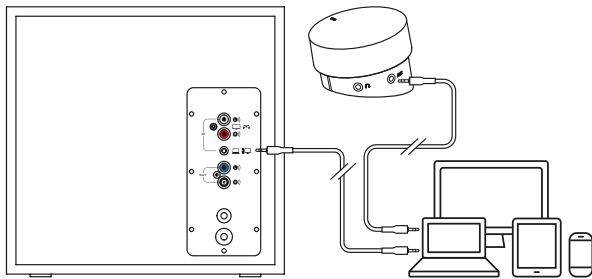

# 1B

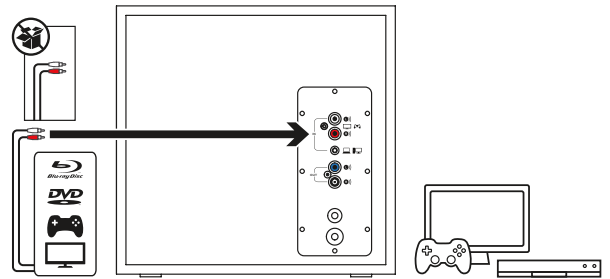

# 2

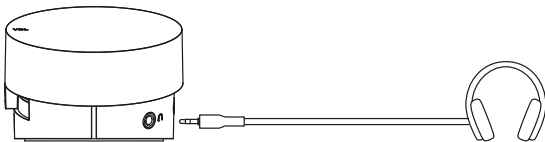

# 3

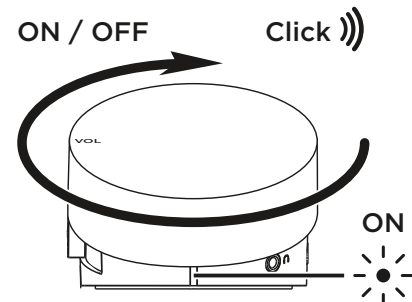



## CONECTA LOS ALTAVOCES A DOS DISPOSITIVOS A LA VEZ

1. Conecta a dos dispositivos al mismo tiempo usando el conector RCA y la entrada de 3,5 mm en la parte posterior del subwoofer.
2. Para cambiar de fuente de audio, simplemente pon en pausa el audio en un dispositivo conectado y reproduce audio del otro dispositivo conectado.

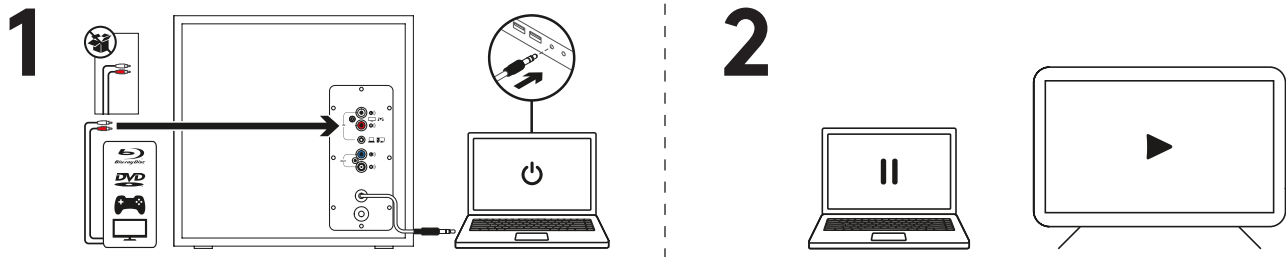

## AJUSTA EL VOLUMEN

1. Ajusta el volumen de los altavoces Z533 con el control giratorio de la sección de control. Gira el control giratorio en el sentido de las agujas del reloj (hacia la derecha) para subir el volumen. Gira el control giratorio en el sentido contrario al de las agujas del reloj (hacia la izquierda) para bajar el volumen.

## AJUSTA LOS GRAVES

2. Ajusta el nivel de graves moviendo el control deslizante de graves situado en el lateral de la sección de control.

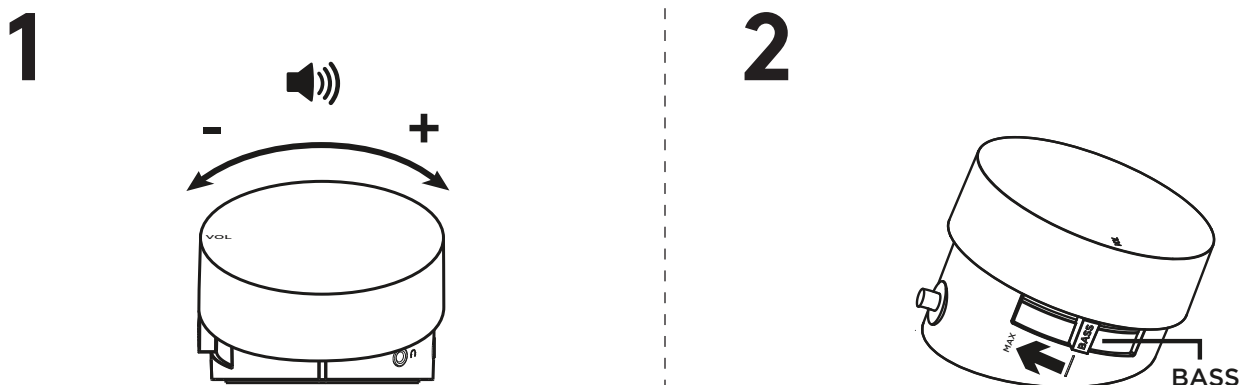

[www.logitech.com/support/Z533](http://www.logitech.com/support/Z533)

# CONHEÇA O SEU PRODUTO

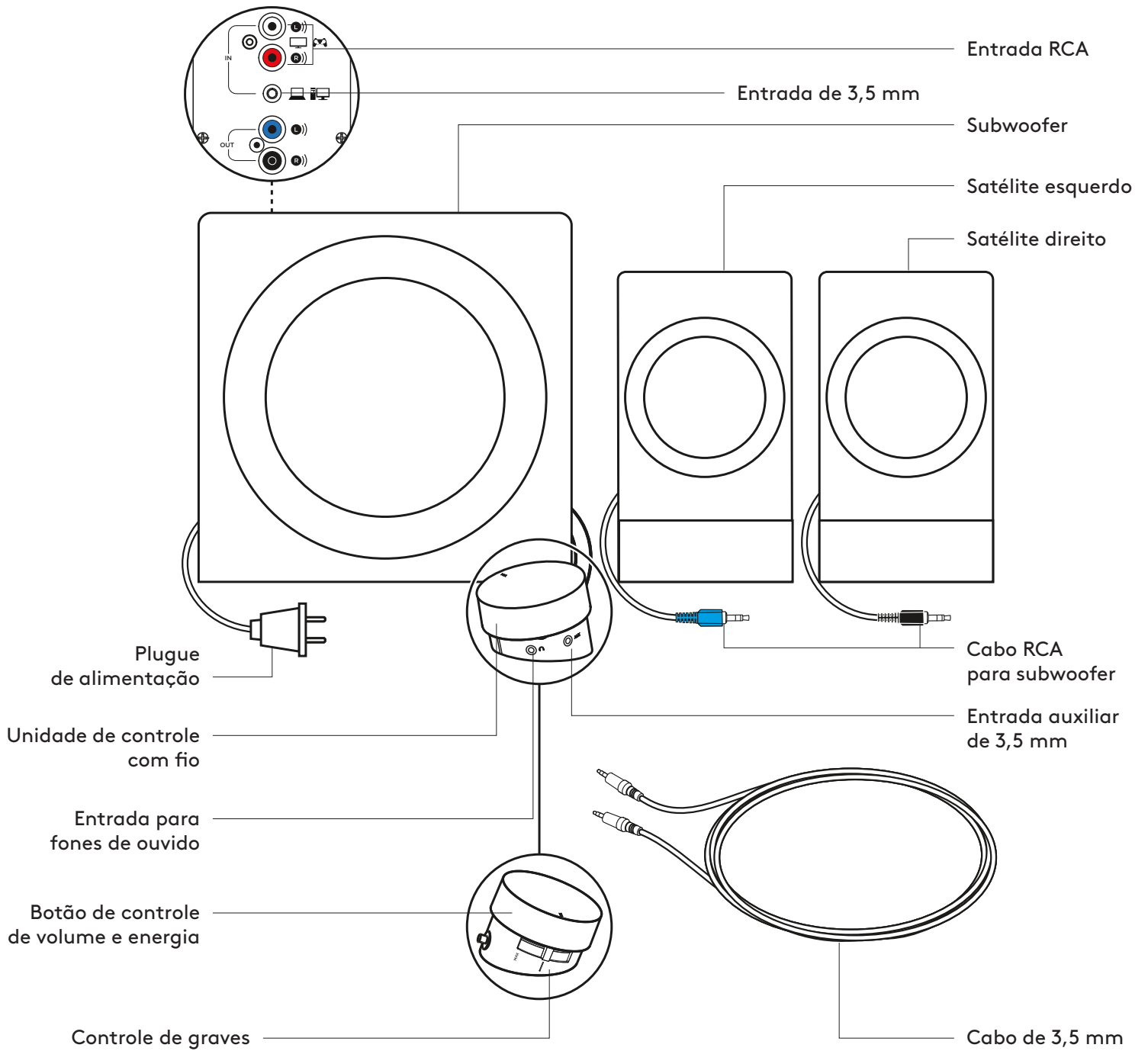

## CONECTAR AS CAIXAS DE SOM

1. Conecte o conector RCA do satélite direito à entrada preta do subwoofer.
2. Conecte o conector RCA do satélite esquerdo à entrada azul do subwoofer.
3. Conecte o plugue de alimentação a uma tomada.

1

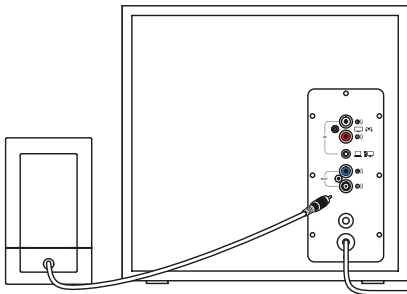

2

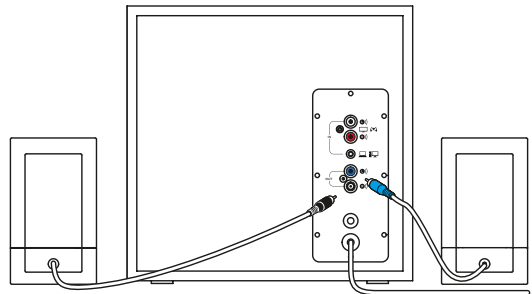

3

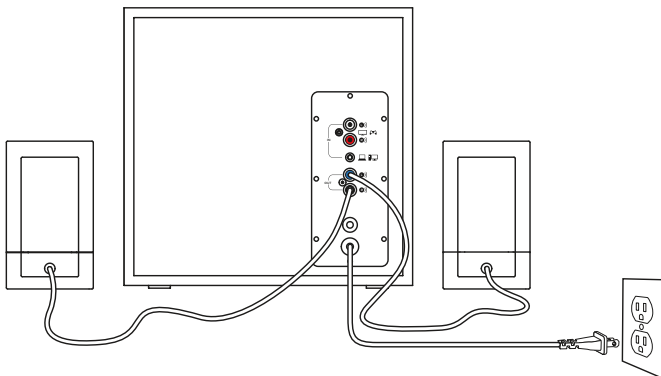

## CONECTAR À FONTE DE ÁUDIO

### 1A. Para a conexão de 3,5 mm:

Conecte uma extremidade do cabo de 3,5 mm fornecido à entrada correspondente na parte traseira do subwoofer ou à tomada de 3,5 mm na unidade de controle. Insira a outra extremidade do cabo de 3,5 mm na entrada de áudio do seu dispositivo (computador, smartphone, tablet etc.)

### 1B. Para conexão RCA:

Conecte uma extremidade do cabo RCA à entrada RCA correspondente na parte traseira do subwoofer. Insira a outra extremidade do cabo RCA na tomada RCA do dispositivo (TV, console de jogos, etc.)

Nota: O cabo RCA não está incluído na embalagem e deve ser adquirido separadamente.

### 2. Conecte os fones de ouvido na entrada para fones de ouvido de 3,5 mm da unidade de controle.

Ajuste o volume a partir da unidade de controle ou da fonte de áudio.

### 3. Ligue/desligue as caixas de som, girando no sentido horário o botão de volume na unidade de controle.

Você ouvirá um clique quando o sistema estiver LIGADO (o LED na frente do controle remoto com fio também acenderá).

# 1A

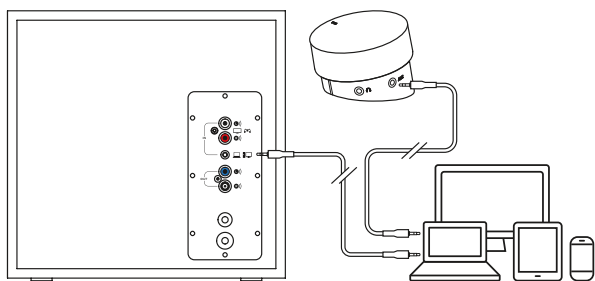

# 1B

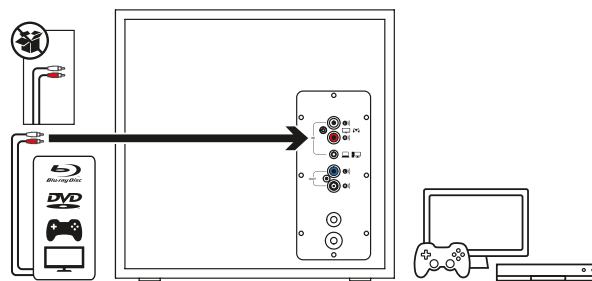

# 2

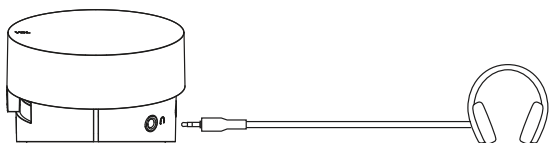

# 3

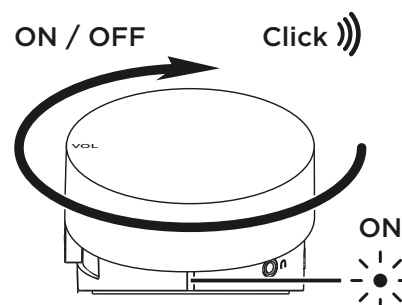

## CONECTAR DOIS DISPOSITIVOS SIMULTANEAMENTE

1. Conecte a dois dispositivos ao mesmo tempo através do conector RCA e entrada de 3,5 mm na parte traseira do subwoofer.
2. Para alternar entre as fontes de áudio, basta pausar o áudio em um dispositivo conectado e reproduzir o áudio do outro dispositivo conectado.

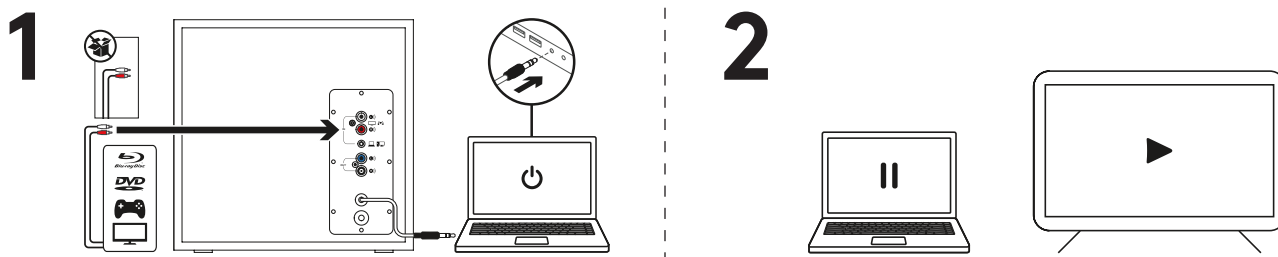

## AJUSTAR O VOLUME

1. Ajuste o volume do Z533 com o botão da unidade de controle.  
Gire o botão no sentido horário (para a direita) para aumentar o volume. Gire o botão no sentido anti-horário (para a esquerda) para diminuir o volume.

## AJUSTAR OS GRAVES

2. Ajuste o nível de graves movendo o botão deslizante de graves na parte lateral da unidade de controle.

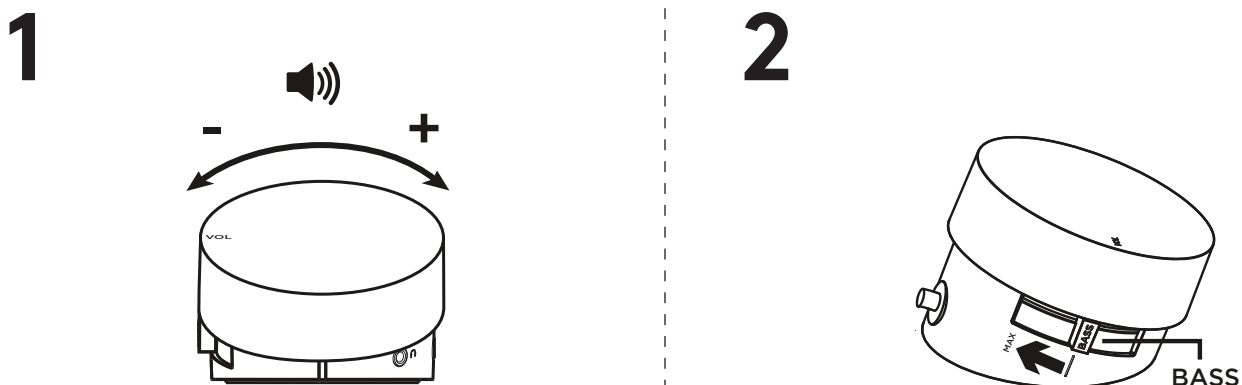

[www.logitech.com/support/Z533](http://www.logitech.com/support/Z533)

[www.logitech.com/support/Z533](http://www.logitech.com/support/Z533)



Ovaj dokument je originalno proizveden i objavljen od strane proizvođača, brenda Logitech, i preuzet je sa njihove zvanične stranice. S obzirom na ovu činjenicu, Tehnoteka ističe da ne preuzima odgovornost za tačnost, celovitost ili pouzdanost informacija, podataka, mišljenja, saveta ili izjava sadržanih u ovom dokumentu.

Napominjemo da Tehnoteka nema ovlašćenje da izvrši bilo kakve izmene ili dopune na ovom dokumentu, stoga nismo odgovorni za eventualne greške, propuste ili netačnosti koje se mogu naći unutar njega. Tehnoteka ne odgovara za štetu nanесenu korisnicima pri upotrebi netačnih podataka. Ukoliko imate dodatna pitanja o proizvodu, ljubazno vas molimo da kontaktirate direktno proizvođača kako biste dobili sve detaljne informacije.

Za najnovije informacije o ceni, dostupnim akcijama i tehničkim karakteristikama proizvoda koji se pominje u ovom dokumentu, molimo posetite našu stranicu klikom na sledeći link:

<https://tehnoteka.rs/p/logitech-zvucnici-za-kompjuter-z533-21-akcija-cena/>