

Uputstvo za upotrebu

KitchenAid mikser sa posudom KA5KSM7990XEWB

KitchenAid[®]



Tehnoteka je online destinacija za upoređivanje cena i karakteristika bele tehnike, potrošačke elektronike i IT uređaja kod trgovinskih lanaca i internet prodavnica u Srbiji. Naša stranica vam omogućava da istražite najnovije informacije, detaljne karakteristike i konkurentne cene proizvoda.

Posetite nas i uživajte u ekskluzivnom iskustvu pametne kupovine klikom na link:

<https://tehnoteka.rs/p/kitchenaid-mikser-sa-posudom-ka5ksm7990xewb-akcija-cena/>



KitchenAid

Professional Bowl-Lift Stand Mixer 5KSM7990X



EN	Use and Care manual	2	NO	Håndbok for bruk og vedlikehold	131
DE	Gebrauchs- und Pflegeanleitung	17	FI	Käyttö- ja huolto-opas	145
FR	Manuel d'utilisation et d'entretien	31	DA	Vejledning til anvendelse og vedligehold	159
IT	Manuale d'uso e manutenzione	47	IS	Notenda & Meðhöndlunar handbók	173
NL	Gebruiks- en onderhoudshandleiding	61	RU	Руководство по эксплуатации и уходу	187
ES	Manual de uso y cuidado	75	PL	Instrukcja obsługi i konserwacji	201
PT	Manual de utilização e manutenção	89	CS	Návod k použití a údržbě	215
EL	Εγχειρίδιο Χρήσης και Φροντίδας	103	TR	Kullanım ve Bakım kılavuzu	229
SV	Handbok för skötsel och användning	117	AR	دليل الاستخدام والعناية	1





PARTS AND FEATURES

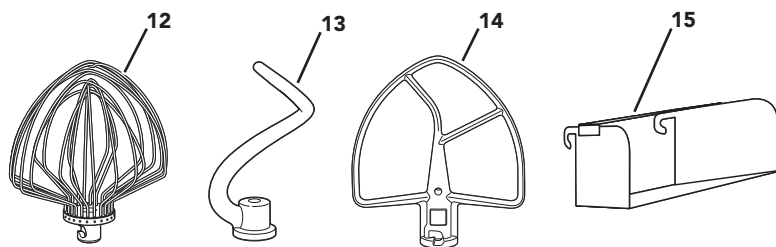
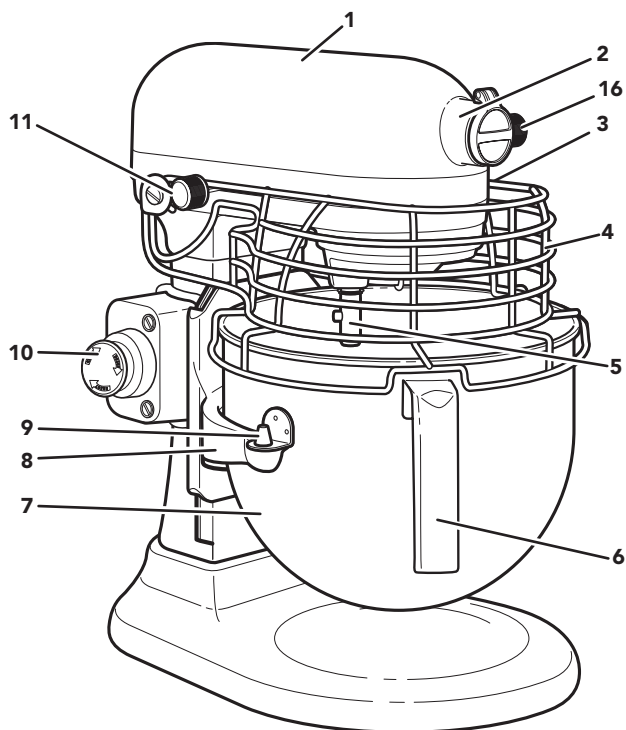

- | | |
|--|---|
| 1 Motor Head | 9 Locating Pins |
| 2 Attachment Hub | 10 Stop Switch |
| 3 Bowl-Lift Lever (not shown) | 11 Speed Control Lever |
| 4 Bowl Guard** | 12 11-Wire Stainless Steel Elliptical Whip |
| 5 Beater Shaft | 13 Stainless Steel Spiral Dough Hook |
| 6 Bowl Handle* | 14 Stainless Steel Flat Beater |
| 7 6.9 L (7 qt.) Stainless Steel Bowl* | 15 Removable Pouring Chute** |
| 8 Bowl Support | 16 Attachment Knob |

*Bowl type may vary. Bowls are also available for purchase as separate accessories.

**Included with select models. Picture/Style may vary from product depending on model.



PRODUCT SAFETY

Your safety and the safety of others are very important.

We have provided many important safety messages in this manual and on your appliance. Always read and obey all safety messages.



This is the safety alert symbol.

This symbol alerts you to potential hazards that can kill or hurt you and others.

All safety messages will follow the safety alert symbol and either the word "DANGER" or "WARNING." These words mean:

 **DANGER**

You can be killed or seriously injured if you don't immediately follow instructions.

 **WARNING**

You can be killed or seriously injured if you don't follow instructions.

All safety messages will tell you what the potential hazard is, tell you how to reduce the chance of injury, and tell you what can happen if the instructions are not followed.

IMPORTANT SAFEGUARDS

When using electrical appliances, basic safety precautions should always be followed, including the following:

1. Read all instructions. Misuse of appliance may result in personal injury.
2. To protect against the risk of electrical shock do not put Stand Mixer in water or other liquid.
3. This appliance is not intended for use by persons (including children) with reduced physical, sensory, or mental capabilities, or lack of experience and knowledge, unless they have been given supervision or instruction concerning use of the appliance by a person responsible for their safety.
4. European Union Only: Appliances can be used by persons with reduced physical, sensory or mental capabilities or lack of experience and knowledge if they have been given supervision or instruction concerning use of the appliance in a safe way and understand the hazards involved. Children shall not play with the appliance.
5. European Union Only: This appliance shall not be used by children. Keep the appliance and its cord out of reach of children.
6. Turn the appliance OFF (0), then unplug from the outlet when not in use, before assembling or disassembling parts and before cleaning. To unplug, grasp the plug and pull from the outlet. Never pull from the power cord.
7. Avoid contacting moving parts. Keep hands, hair, and clothing, as well as spatulas and other utensils, away from beater during operation to reduce the risk of injury to persons and/or damage to the Stand Mixer.
8. Do not operate any appliance with a damaged cord or plug, or after the appliance malfunctions, or is dropped or damaged in any manner. Return appliance to the nearest Authorised Service Facility for examination, repair, or electrical or mechanical adjustment.
9. The use of accessories or attachments not recommended or sold by the manufacturer may cause fire, electric shock or injury.



PRODUCT SAFETY

10. If the supply cord is damaged, it must be replaced by the manufacturer, its service agent, or similarly qualified persons in order to avoid a hazard.
11. Never leave the appliance unattended while it is in operation.
12. Do not use the Stand Mixer outdoors.
13. Do not let the cord hang over the edge of table or counter.
14. To avoid product damage, do not use the Stand Mixer bowls in areas of high heat such as an oven, microwave, or on a stovetop.
15. Remove the Flat Beater, Wire Whip, or Spiral Dough Hook from the Stand Mixer before washing.
16. Refer to the "Care and Cleaning" section for instructions on cleaning the surfaces in contact with food.
17. The appliance is not to be cleaned with a water jet.
18. This appliance is intended to be used for commercial applications, for example in kitchens of restaurants, canteens, hospitals and in commercial enterprises such as bakeries, butcheries, etc., but not for continuous mass production of food.

SAVE THESE INSTRUCTIONS

ELECTRICAL REQUIREMENTS

⚠ WARNING



Electrical Shock Hazard

Plug into an earthed outlet.

Do not remove earth prong.

Do not use an adapter.

Do not use an extension cord.

Failure to follow these instructions can result in death, fire, or electrical shock.

Voltage: 220-240 V~

Frequency: 50-60 Hz

Wattage: 325 W

Recommended operating time:
1-30 minutes with a duty cycle of
10 min. ON / 15 min. OFF (0).

Do not use an extension cord. If the power supply cord is too short, have a qualified electrician or service technician install an outlet near the appliance.

The wattage rating is determined by using the attachment that draws the greatest load (power). Other recommended attachments may draw significantly less power.

This product is supplied with a Y type power cord. If the power cord is damaged, it must be replaced by the manufacturer or a service agent in order to avoid a hazard.

The acoustic pressure level measured in conformity with the prEN 454-test code is less than 70 dBA.

A * in the model number indicates additional characters that designate machine colour and engineering digits for the actual model (eg. 5KSM7990X).





PRODUCT SAFETY

ELECTRICAL EQUIPMENT WASTE DISPOSAL

Scrapping the product

- This appliance is marked in compliance with European Directive 2012/19/EU, Waste Electrical and Electronic Equipment (WEEE).

- By ensuring this product is disposed of correctly, you will help prevent potential negative consequences for the environment and human health, which could otherwise be caused by inappropriate waste handling of this product.



- The symbol  on the product or on the accompanying documentation indicates that it should not be treated as domestic waste but must be taken to an appropriate collection centre for the recycling of electrical and electronic equipment.

Disposal must be carried out in accordance with local environmental regulations for waste disposal.

For more detailed information about treatment, recovery and recycling of this product, please contact your local city office, your household waste disposal service or the shop where you purchased the product.

DECLARATION OF CONFORMITY

This appliance has been designed, constructed and distributed in compliance with the safety requirements of EC Directives: 2014/35/EU, 2014/30/EU, 2009/125/EC and 2011/65/EU (RoHS Directive).



KitchenAid

DECLARATION OF CONFORMITY
UE DECLARATION DE CONFORMITE



KitchenAid Europa, Inc

located in: Nijverheidslaan 3-Box 5, B-1853 Strombeek-Bever, Belgium

DECLARES

Product Category: **Stand Mixer**
Brand: **KitchenAid**
Product Model (s): **5KSM79XX+; 5KSMC89XX+**

Where XX = up to 2 alphanumeric characters, which represents the features, distributor code, and/or color
Where + = May or may not be followed by up to five digit suffix codes to indicate change in aesthetics.

to which this declaration relates has been designed, manufactured and placed on the market in conformity with the following standard(s) or other normative documents(s)

- IEC 60335-1:2010
- EN 60335-1:1994+ A1:1996 + A11:1995 + A12:1996 + A13:1998 + A14: 1998 + A15:2000 + A16:2001
- IEC 60335-2-64:2002 + A1
- EN 60335-2-64:2000 + A1
- EN 62233:2008
- CISPR 14-1:2016
- CISPR 14-2:2015
- IEC 61000-3-2:2018 / EN 61000-3-2:2019
- IEC 61000-3-3:2013 + A1:2017 / EN 61000-3-3:2013
- EN 55014-1:2006 + A1:1009 + A2:2011
- EN 55014-2:2015
- EN 50564: 2011

The object of the declaration described above is in conformity with the relevant Union harmonization legislation

- 2014/35/EU Low Voltage Directive
- 2014/30/EU Electromagnetic Compatibility Directive
- 2011/65/EU - ROHS II European Directive
- 2015/863/EU Commission delegated Directive amending annex II of ROHS II Directive
- 2009/125/EC Framework for the setting of Ecodesign requirements for energy-related products
- 1275/2008 Ecodesign for Standby and Off Mode Electric Power

This declaration of conformity is issued under the sole responsibility of the manufacturer

Signed for and on behalf of: KitchenAid Europa, Inc.

St. Joseph, MI 07 July 2020
Place and date:

Legal Representative:
Doug Youngerman, Director
KitchenAid Portable Appliance Division

Signature

Date

Last two digits of the year in which the CE marking was affixed: 12





ACCESSORY GUIDE

Accessory	Use to mix	Description	Operating time
Stainless Steel Flat Beater	Normal to heavy mixtures	Cakes, creamed frostings, candies, cookies, biscuits, pie pastry, quick breads, meat loaf, mashed potatoes.	1-10 minutes
Stainless Steel Spiral Dough Hook	Mixing and kneading yeast doughs	Breads, rolls, pizza dough, coffee cakes, buns.	1-10 minutes
11-Wire Stainless Steel Elliptical Whip	Mixtures that need air incorporated	Eggs, egg whites, heavy cream, boiled frostings, sponge cakes, angel food cakes, mayonnaise, some candies.	1-30 minutes

SPEED CONTROL GUIDE

All speeds features Soft Start which allows the Stand Mixer to start at a lower speed to help avoid ingredient splash-out and "flour puff" at start-up, then increases to the selected speed.

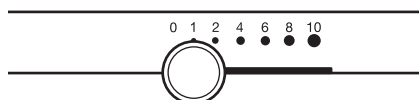

Speed	Accessory	Action	Description
1	Stainless Steel Flat Beater	Stirring	For slow stirring, combining, mashing, and starting all mixing procedures. Use to add flour and dry ingredients to batter, and add liquids to dry ingredients. Do not use speed 1 to mix or knead yeast doughs.
2	Stainless Steel Flat Beater Stainless Steel Spiral Dough Hook	Slow mixing, Kneading	For slow mixing, mashing, and faster stirring. Use to mix and knead yeast doughs, heavy batters, and candies; start mashing potatoes or other vegetables; cut shortening into flour; mix thin or splashy batters.
4	Stainless Steel Flat Beater 11-Wire Stainless Steel Elliptical Whip	Mixing, Beating	For mixing semi-heavy batters, such as cookies. Use to combine sugar and shortening and to add sugar to egg whites for meringues. Medium speed for cake mixes. Use with: food grinder, rotor slicer/shredder, pasta roller, and fruit/vegetable strainer.
6	Stainless Steel Flat Beater 11-Wire Stainless Steel Elliptical Whip	Beating, Creaming	For medium-fast beating (creaming) or whipping. Use to finish mixing cake, doughnut, and other batters. High speed for cake mixes.
8-10	11-Wire Stainless Steel Elliptical Whip	Fast beating, Whipping	For whipping cream, egg whites, and boiled frostings. For whipping small amounts of cream, egg whites, or for final whipping of mashed potatoes.

NOTE: Use Speed 2 to mix or knead yeast doughs. Use of any other speed creates high potential for Stand Mixer failure. The PowerKnead Stainless Steel Spiral Dough Hook efficiently kneads most yeast dough within 4 minutes.





CAPACITY CHART

6.9 L Bowl	
All-purpose flour	2 to 2.2 kg
Bread	8 breads of 450 g
Cookies / Biscuits	160 pieces
Mashed Potatoes	3.6 kg

PRODUCT ASSEMBLY

1

Turn the Stand Mixer to "OFF (0)" and then unplug.

2

Place Bowl-Lift Lever in down position.

3

Spring latch
Locating pin

To attach the Bowl: Fit the Bowl Supports over Locating Pins and press down on back of the Bowl until Bowl Pin snaps into spring latch.

IMPORTANT: If the Bowl is not securely snapped into place, it will be unstable and wobble during use.

4

Pin

To attach the accessory: Slip the accessory onto the shaft. Turn to hook it over the pin on the shaft.

5

To raise the bowl: Rotate the Bowl-Lift Lever to the straight up position. The Bowl must always be in the raised position when mixing.





PRODUCT ASSEMBLY

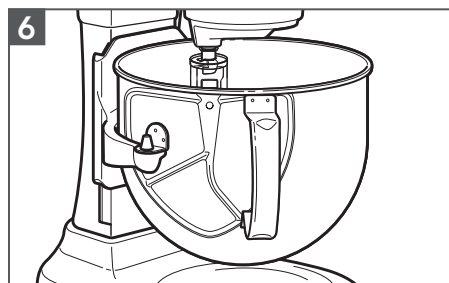

Test the beater to bowl clearance: Plug the Stand Mixer into an earthed outlet. Turn Stand Mixer ON and test each speed, making sure the beater does not touch the bowl during operation. If the beater is too far away from the bottom or is hitting the Bowl, proceed to next step to make adjustments.

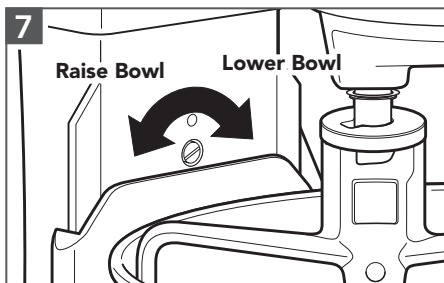

(OPTIONAL) To adjust Beater to Bowl clearance: Lower the Bowl to the down position. Turn the screw slightly counterclockwise (left) to raise the Beater, or clockwise (right) to lower it. Adjust the beater so that it just clears the surface of the Bowl. Check again the clearance of the Beater to the Bowl.

IMPORTANT: When properly adjusted, the Stainless Steel Flat Beater will not strike on the bottom or sides of the bowl. If the flat beater or the wire whip is so close that it strikes the bottom of the bowl, coating may wear off the beater or wires on the whip may wear.

USING THE BOWL GUARD* AND POURING CHUTE*

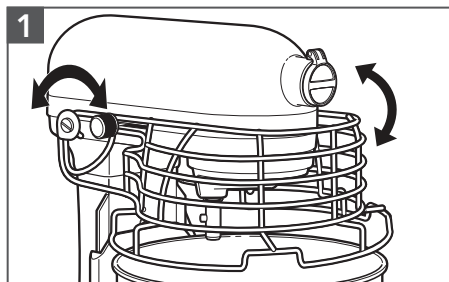

To attach the Bowl Guard*: Make sure that the guard is returned to the down position before beginning to use the Stand Mixer. The Stand Mixer will not run if the Bowl Guard is not in the proper position.

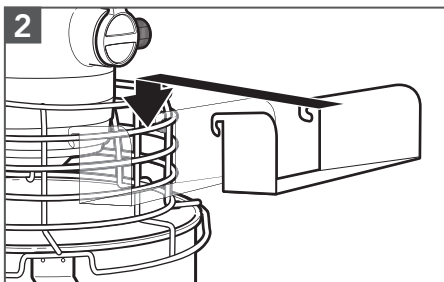

Place the Pouring Chute*: Attach the pouring shield to the front of Bowl Guard. It provides a convenient way to add ingredients to the Stand Mixer Bowl.

*Available with select models only and available as an accessory purchase.

Auto-Reset Motor Protection: If the Stand Mixer stops due to overload, slide the Speed Control Lever to "OFF (0)" and unplug the Stand Mixer. After a few minutes, the Stand Mixer will automatically reset. Plug the Stand Mixer back in and slide the Speed Control Lever to the desired speed and continue mixing. If the Stand Mixer does not restart, unplug the Stand Mixer for a longer period of time to allow it to cool, then plug back in and restart the Stand Mixer.

Stop Switch: If you need to stop the Stand Mixer immediately during use, press the Stop Switch. To resume operation, reset the Speed Control Lever to "OFF (0)", and pull out the Stop Switch. Then, your Stand Mixer is ready to be used normally again.



PRODUCT ASSEMBLY

⚠ WARNING



Electrical Shock Hazard

- Plug into an earthed outlet.**
- Do not remove earth prong.**
- Do not use an adapter.**
- Do not use an extension cord.**
- Failure to follow these instructions can result in death, fire, or electrical shock.**

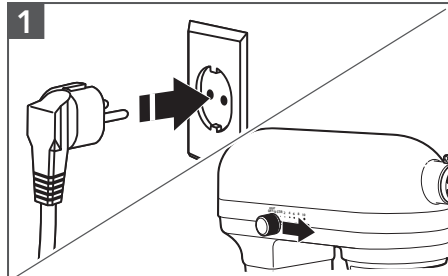

1 Plug it into an earthed outlet. Start with lower speed to avoid splashing and increase it gradually. Refer to the "Speed Control Guide".

⚠ WARNING

Injury Hazard

- Unplug mixer before touching beaters.**
- Failure to do so can result in broken bones, cuts, or bruises.**

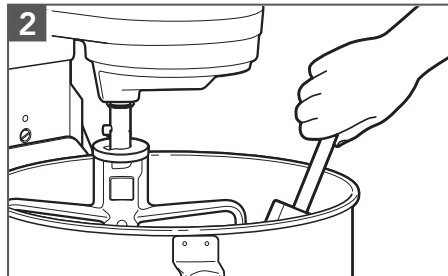

2 Do not scrape the Bowl while operating. Scraping the Bowl once or twice during mixing is usually sufficient.



PRODUCT USAGE

OPTIONAL ATTACHMENTS

KitchenAid offers a wide range of optional attachments such as the Spiralizer, Pasta Cutters, or Food Grinder that may be attached to the Stand Mixer attachment power hub.

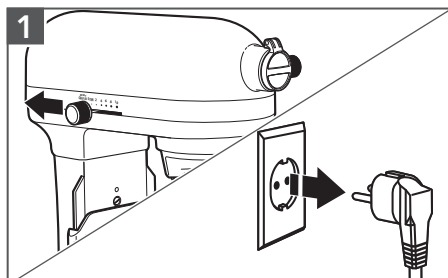

1 Turn the Stand Mixer to "OFF (0)" and then unplug.



2 Flip up hinge Attachment Hub cover to open.

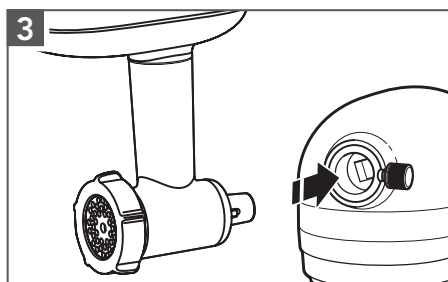

3 Insert attachment into Attachment Hub, making certain that attachment power shaft fits into the square Attachment Hub socket.

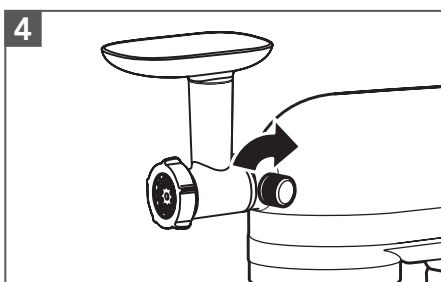

4 Tighten the Attachment Knob by turning it clockwise until the attachment is secured to the Stand Mixer.

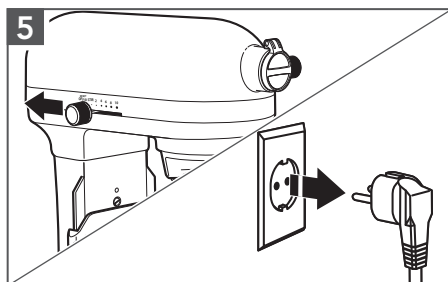

5 **To remove:** Turn the Stand Mixer to "OFF (0)" and then unplug.

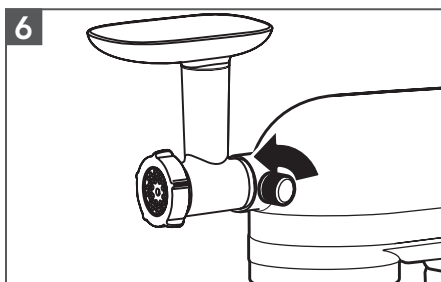

6 Loosen Attachment Knob by turning it counterclockwise. Rotate attachment slightly back and forth while pulling it out.

NOTE: See the Use and Care Guide of each specific attachment for more details.





PRODUCT DISASSEMBLY

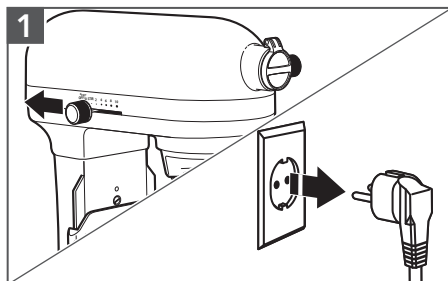

1 Turn the Stand Mixer to "OFF (0)" and then unplug.

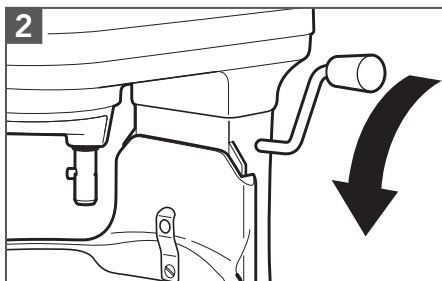

2 Place Bowl-Lift Lever in down position.

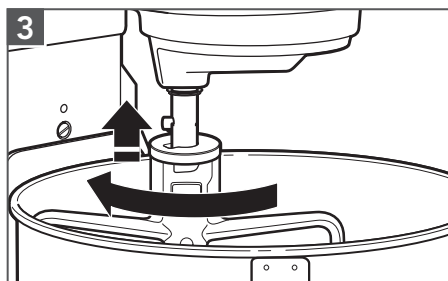

3 **Remove the accessory:** Press accessory upward and turn to the left. Pull down the accessory from Beater Shaft.

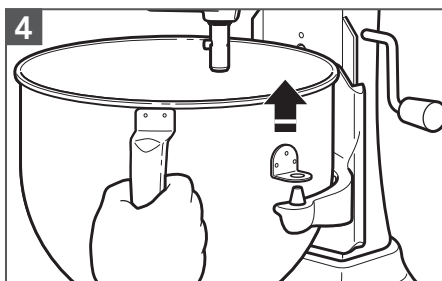

4 **To Remove Bowl:** Place Bowl-Lift Lever in the down position. Grasp Bowl Handle and lift straight up and off Locating Pins

CARE AND CLEANING

IMPORTANT: Do not immerse the Stand Mixer body in water or other liquids. The appliance is not to be cleaned with a water jet.

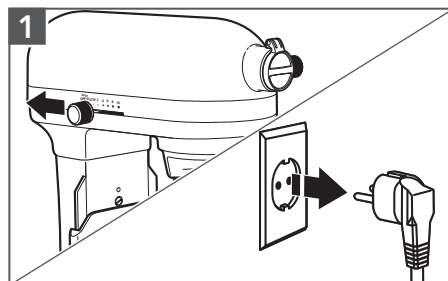

1 Turn the Stand Mixer to "OFF (0)" and then unplug.

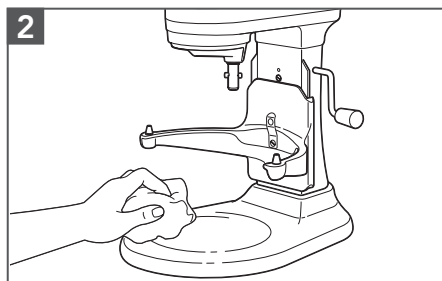

2 Wipe the Stand Mixer body with a soft, damp cloth.





CARE AND CLEANING

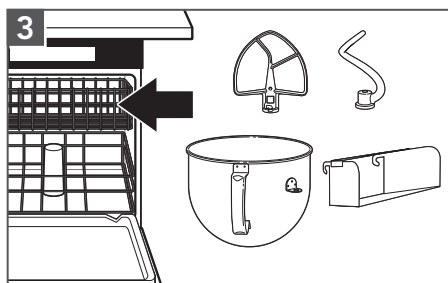

The following parts are dishwasher-safe, top rack only: Bowl, Stainless Steel Flat Beater, Stainless Steel Spiral Dough Hook, and Removable Pouring Chute*.

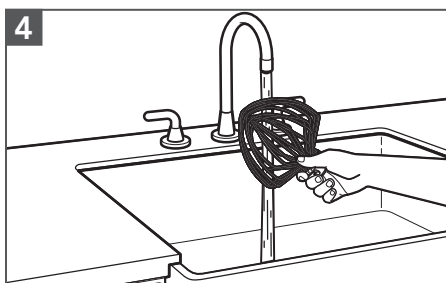

The following part should be hand-washed only using warm, soapy water and drying thoroughly: 11-Wire Stainless Steel Elliptical Whip.

*Available with select models only and available as an accessory purchase.

TROUBLESHOOTING

Problem	Solution
If Stand Mixer warms up during use:	Under heavy loads with extended mixing time periods, you may not be able to comfortably touch the top of the unit. This is normal.
The Stand Mixer emit a pungent odour:	This is common with Electric Motors, especially when new.
If the Stainless Steel Flat Beater hits the Bowl:	Stop the Stand Mixer. See the "Beater to Bowl Clearance" section and adjust the Beater to Bowl Clearance.
If your Stand Mixer should fail to operate, please check the following:	Is the Stand Mixer plugged in?
	Is the fuse in the circuit to the Stand Mixer in working order? If you have a circuit breaker box, be sure the circuit is closed.
	Turn OFF (0) the Stand Mixer for 10-15 seconds, then turn it back on. If the Stand Mixer still does not start, allow it to cool for 30 minutes before turning it back on.
If the problem cannot be corrected:	See the "Terms of KitchenAid Guarantee ("Guarantee")" section. Do not return the Stand Mixer to the retailer; retailers do not provide service.



TERMS OF KITCHENAID GUARANTEE ("GUARANTEE")

Covering U.K. - Ireland - South Africa - UAE

KitchenAid Europa, Inc., Nijverheidslaan 3, Box 5, 1853 Strombeek-Bever, Belgium ("Guarantor") grants the end-customer, who is a consumer, a Guarantee pursuant to the following terms.

FOR U.K.:

The Guarantee applies in addition to and does not limit or affect the statutory warranty rights of the end-customer against the seller of the product. In summary, the Consumer Rights Act 2015 says products must be as described, fit for purpose and of satisfactory quality. During the expected lifespan of your product your legal rights entitle you to the following:

- Up to 30 days: if your product is faulty, then you can get an immediate refund.
- Up to six months: if your product can't be repaired or replaced, then you're entitled to a full refund, in most cases.
- Up to six years: if your product does not last a reasonable length of time you may be entitled to some money back.

These rights are subject to certain exceptions. For detailed information please visit the Citizens Advice website www.adviceguide.org.uk or call **03454 04 05 06**.

FOR IRELAND:

The Guarantee applies in addition to and does not limit or affect the statutory warranty rights of the end-customer against the seller of the product under the European Communities (Certain Aspects of the Sale of Consumer Goods and Associated Guarantees Regulations 2003 (S.I. No. 11/2003)) and other enactments governing the sale of consumer goods.

FOR SOUTH AFRICA:

The Guarantee applies in addition to and does not limit or affect the statutory warranty rights of the end-customer against the seller of the product. In summary, the Consumer Protection Act, 2008 says that products must be: (i) reasonably suitable for the purpose for which they are intended; (ii) in good working order, of good quality and free of any defects; (iii) useable and durable for a reasonable period of time, having regard to the use to which they would normally be put and to all the surrounding circumstances; and (iv) in compliance with any applicable standards or any other public regulations.

During the expected lifespan of your product and where the products are not purchased online, your legal rights will entitle you to the following:

- You will be entitled to a full refund, if you did not have the opportunity to examine the product before delivery and if you rejected delivery of the product on the basis that the type and quality of the product was not as reasonably expected or did not reasonably conform to the material specifications.
- Within 5 business days after delivery: you may rescind your purchase and request a refund, if your purchase resulted from direct marketing.
- Within 10 business days after delivery: you will be entitled to a full refund, if it is found that the product was unsuitable for a particular purpose specifically communicated to you by the Guarantor.
- Within 15 business days after delivery: you will be entitled to a refund if: (i) the product was not delivered to you; or (ii) if you returned the product to the Guarantor.
- Within 6 months after delivery: you will be entitled to a refund or a replacement product, if the product is defective or fails to operate in terms of its specifications.





TERMS OF KITCHENAID GUARANTEE ("GUARANTEE")

Where you have purchased a product online your legal rights will be governed by the Electronic Communications and Transactions Act, 2002 and you will be entitled to the following:

- Within 7 days after conclusion of the transaction or after delivery: you may cancel your purchase without reason and without penalty.
- Within 30 days of the date of cancellation of the transaction: you will be entitled to receive a refund, if you have already made payment.
- You will only be liable for the direct costs of returning the product to the Guarantor.

FOR UAE:

The Guarantee applies in addition to and does not limit or affect the statutory warranty rights of the end-customer against the seller of the product.

1) SCOPE AND TERMS OF THE GUARANTEE

a) The Guarantor grants the Guarantee for the products mentioned under Section 1.b) which a consumer has purchased from a seller or a company of the KitchenAid-Group within the following countries: U.K., Ireland, or South Africa, or the United Arab Emirates (UAE).

b) The Guarantee period depends on the purchased product and is as follows:

5KSM7990X One Year full guarantee from date of purchase.

c) The Guarantee period commences on the date of purchase, i.e. the date on which a consumer purchased the product from a dealer or a company of the KitchenAid-Group.

d) The Guarantee covers the defect-free nature of the product.

e) The Guarantor shall provide the consumer with the following services under this Guarantee, at the choice of the Guarantor, if a defect occurs during the Guarantee period:

- Repair of the defective product or product part, or
- Replacement of the defective product or product part. If a product is no longer available, the Guarantor is entitled to exchange the product for a product of equal or higher value.

f) If the consumer wishes to make a claim under the Guarantee, the consumer has to contact the country specific KitchenAid service centres or the Guarantor directly at KitchenAid Europa, Inc. Nijverheidslaan 3, Box 5, 1853 Strombeek-Bever, Belgium;

Email-Address U.K.: CONSUMERCARE.UK@kitchenaid.eu

Email-Address IRELAND: CONSUMERCARE.IE@kitchenaid.eu

Toll Free Number U.K. & IRELAND: **00 800 381 040 26**

FOR SOUTH-AFRICA:

Our local KitchenAid Distributor:

KitchenAid Africa
PO Box 52102
V&A Waterfront
Cape Town
8002



TERMS OF KITCHENAID GUARANTEE ("GUARANTEE")

Contact our distributor:

Telephone: +27 21 555 0700

You can contact our Customer Service Centre for Small Domestic Appliances from 8.30 am to 1.00pm and from 1.30 pm to 5.00 pm or write to us at the following address: hello@kitchenaidafrica.com

FOR UAE:

AL GHANDI ELECTRONICS.

POST BOX NO. 9098,

DUBAI, UNITED ARAB EMIRATES

Toll free number: +971 4 2570007

g) The costs of repair, including spare parts, and any postage costs (if applicable) for the delivery of a defect-free product or product part shall be borne by the Guarantor. The Guarantor shall also bear the postage costs for returning the defective product or product part if the Guarantor or the country specific KitchenAid customer service centre requested the return of the defective product or product part. However, the consumer shall bear the costs of appropriate packaging for the return of the defective product or product part.

h) To be able to make a claim under the Guarantee, the consumer must present the receipt or invoice of the purchase of the product.

2) LIMITATIONS OF THE GUARANTEE

a) **The Guarantee applies only to products used for private purposes and not for professional or commercial purposes.**

b) **The Guarantee does not apply in the case of normal wear and tear, improper or abusive use, failure to follow the instructions for use, use of the product at the wrong electrical voltage, installation and operation in violation of the applicable electrical regulations, and use of force (e.g. blows).**

c) **The Guarantee does not apply if the product has been modified or converted, e.g. conversions from 120 V products to 220-240 V products.**

d) **The provision of Guarantee services does not extend the Guarantee period, nor does it initiate the commencement of a new Guarantee period. The Guarantee period for installed spare parts ends with the Guarantee period for the entire product.**

e) **FOR SOUTH-AFRICA & UAE ONLY:**

Further or other claims, in particular claims for damages, are excluded unless liability is mandatory by law.

After expiry of the Guarantee period or for products for which the Guarantee does not apply, the KitchenAid customer service centres are still available to the end-customer for questions and information.

Further information is also available on our website:

- For U.K. & Ireland www.kitchenaid.eu

- For South-Africa: www.kitchenaidafrica.com

- For UAE: www.KitchenAid-MEA.com

PRODUCT REGISTRATION

Register your new KitchenAid appliance now: <http://www.kitchenaid.eu/register>

©2020 All rights reserved.

KITCHENAID and the design of the Stand Mixer are trademarks in the U.S. and elsewhere.



Ovaj dokument je originalno proizveden i objavljen od strane proizvođača, brenda KitchenAid, i preuzet je sa njihove zvanične stranice. S obzirom na ovu činjenicu, Tehnoteka ističe da ne preuzima odgovornost za tačnost, celovitost ili pouzdanost informacija, podataka, mišljenja, saveta ili izjava sadržanih u ovom dokumentu.

Napominjemo da Tehnoteka nema ovlašćenje da izvrši bilo kakve izmene ili dopune na ovom dokumentu, stoga nismo odgovorni za eventualne greške, propuste ili netačnosti koje se mogu naći unutar njega. Tehnoteka ne odgovara za štetu nanесenu korisnicima pri upotrebi netačnih podataka. Ukoliko imate dodatna pitanja o proizvodu, ljubazno vas molimo da kontaktirate direktno proizvođača kako biste dobili sve detaljne informacije.

Za najnovije informacije o ceni, dostupnim akcijama i tehničkim karakteristikama proizvoda koji se pominje u ovom dokumentu, molimo posetite našu stranicu klikom na sledeći link:

<https://tehnoteka.rs/p/kitchenaid-mikser-sa-posudom-ka5ksm7990xewh-akcija-cena/>