

## Uputstvo za upotrebu

KitchenAid toster KA5KMT4205EMS

**KitchenAid®**



Tehnoteka je online destinacija za upoređivanje cena i karakteristika bele tehnike, potrošačke elektronike i IT uređaja kod trgovinskih lanaca i internet prodavnica u Srbiji. Naša stranica vam omogućava da istražite najnovije informacije, detaljne karakteristike i konkurentne cene proizvoda.

Posetite nas i uživajte u ekskluzivnom iskustvu pametne kupovine klikom na link:

<https://tehnoteka.rs/p/kitchenaid-toster-ka5kmt4205ems-akcija-cena/>

5KMT2204  
5KMT4205

[PRODUCT IMAGE]

**KitchenAid**

<b>English</b> .....	5
<b>Deutsch</b> .....	00
<b>Français</b> .....	00
<b>Italiano</b> .....	00
<b>Nederlands</b> .....	00
<b>Español</b> .....	00
<b>Português</b> .....	00
<b>Ελληνικά</b> .....	00
<b>Svenska</b> .....	00
<b>Norsk</b> .....	00
<b>Suomi</b> .....	00
<b>Dansk</b> .....	00
<b>Íslenska</b> .....	00
<b>Русский</b> .....	00
<b>Polski</b> .....	00
<b>Český</b> .....	00
<b>العربية</b> .....	00

# TABLE OF CONTENTS

<b>TOASTER SAFETY</b>	
Important safeguards.....	6
Electrical requirements .....	8
<b>PARTS AND FEATURES</b>	
Toaster parts.....	9
Control panel features.....	10
Toaster features.....	11
<b>OPERATING THE TOASTER</b>	
Before first use .....	11
Using the Toaster.....	12
Using the special toasting functions.....	13
<b>CARE AND CLEANING</b> .....	17
<b>TROUBLESHOOTING</b> .....	18
<b>WARRANTY AND SERVICE</b> .....	19

**Your safety and the safety of others are very important.**

We have provided many important safety messages in this manual and on your appliance. Always read and obey all safety messages.



This is the safety alert symbol.

This symbol alerts you to potential hazards that can kill or hurt you and others.

All safety messages will follow the safety alert symbol and either the word "DANGER" or "WARNING." These words mean:

**! DANGER**

**You can be killed or seriously injured if you don't immediately follow instructions.**

**! WARNING**

**You can be killed or seriously injured if you don't follow instructions.**

All safety messages will tell you what the potential hazard is, tell you how to reduce the chance of injury, and tell you what can happen if the instructions are not followed.

**IMPORTANT SAFEGUARDS**

When using electrical appliances, basic safety precautions should always be followed, including the following:

1. Read all instructions.
2. Do not touch hot surfaces. Use handles or knobs.
3. To protect against electrical shock, do not immerse cord, plugs, or toaster in water or other liquid.
4. This appliance can be used by children aged from 8 years and above and persons with reduced physical, sensory or mental capabilities or lack of experience and knowledge if they have been given supervision or instruction concerning use of the appliance in a safe way and understand hazards involved. Children shall not play with the appliance. Cleaning and user maintenance shall not be made by children without supervision.
5. Unplug toaster from outlet when not in use and before cleaning. Allow to cool before putting on or taking off parts.
6. Do not operate any appliance with a damaged cord or plug or after the appliance malfunctions or has been damaged in any manner. Return appliance to the nearest Authorized Service Center for examination, repair or adjustment.
7. The use of accessory attachments not recommended by the appliance manufacturer may cause injuries.

8. Do not use outdoors.
9. Do not let cord hang over edge of table or counter, or touch hot surfaces.
10. Do not place on or near a hot gas or electric burner, or in a heated oven.
11. To disconnect, turn any control to "OFF," then remove plug from outlet.
12. Do not use toaster for other than intended use.
13. Oversize foods, metal foil packages, or utensils must not be inserted in toaster as they may involve a risk of fire or electric shock.
14. A fire may occur if toaster is covered with or touching flammable material, including curtains, draperies, walls and the like, when in operation.
15. Do not attempt to dislodge food when toaster is plugged in.
16. **This product is designed for household use only.**

**SAVE THESE INSTRUCTIONS**

Electrical requirements

**⚠ WARNING**



**Electrical Shock Hazard**

- Plug into a grounded outlet.**
- Do not remove ground prong.**
- Do not use an adapter.**
- Do not use an extension cord.**
- Failure to follow these instructions can result in death, fire, or electrical shock.**

Voltage: 220-240 Volts  
 Frequency: 50/60 Hertz  
 Wattage: 1250 Watts

**NOTE:** If the power cord is damaged, it must be replaced by the manufacturer or its service agent in order to avoid a hazard. Do not use an extension cord. If the power supply cord is too short, have a qualified electrician or serviceman install an outlet near the appliance.

Electrical equipment waste disposal

**Disposal of packing material**

The packing material is 100% recyclable and is marked with the recycle symbol . The various parts of the packing must therefore be disposed of responsibly and in full compliance with local authority regulations governing waste disposal.

**Scrapping the product**

- This appliance is marked in compliance with European Directive 2002/96/EC, Waste Electrical and Electronic Equipment (WEEE).
- By ensuring this product is disposed of correctly, you will help prevent potential negative consequences for the environment

and human health, which could otherwise be caused by inappropriate waste handling of this product.

- The symbol  on the product or on the accompanying documentation indicates that it should not be treated as domestic waste but must be taken to an appropriate collection center for the recycling of electrical and electronic equipment.

For more detailed information about treatment, recovery and recycling of this product, please contact your local city office, your household waste disposal service or the shop where you purchased the product.

4-slice model

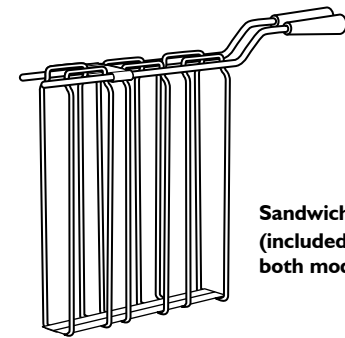

Sandwich rack (included with both models)

Extra-wide slots with automatic self-centering racks

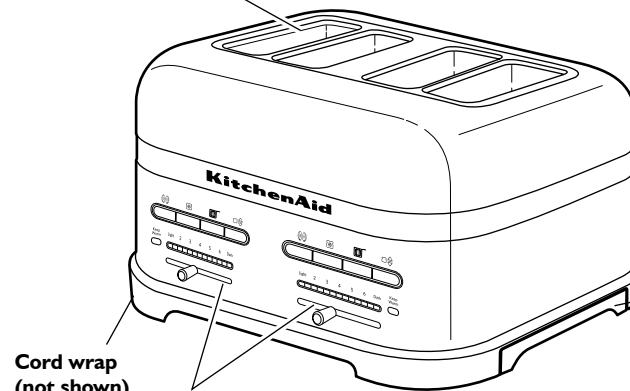

Cord wrap (not shown)

Dual-independent controls

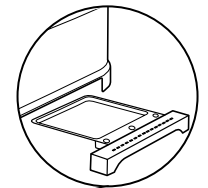

Removable crumb tray

2-slice model

Extra-wide slots with automatic self-centering racks

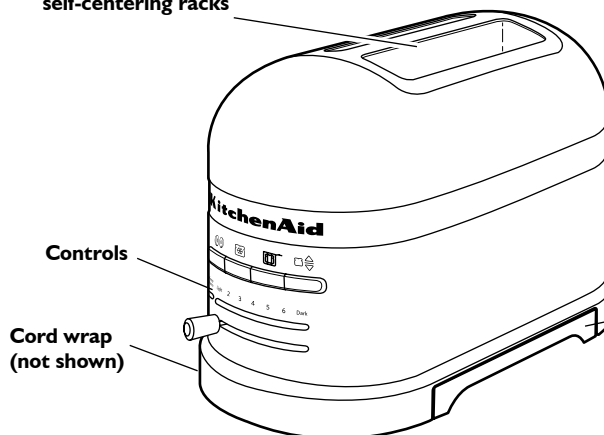

Controls

Cord wrap (not shown)

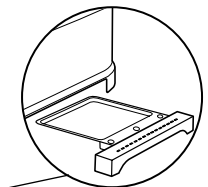

Removable crumb tray

## Control panel features

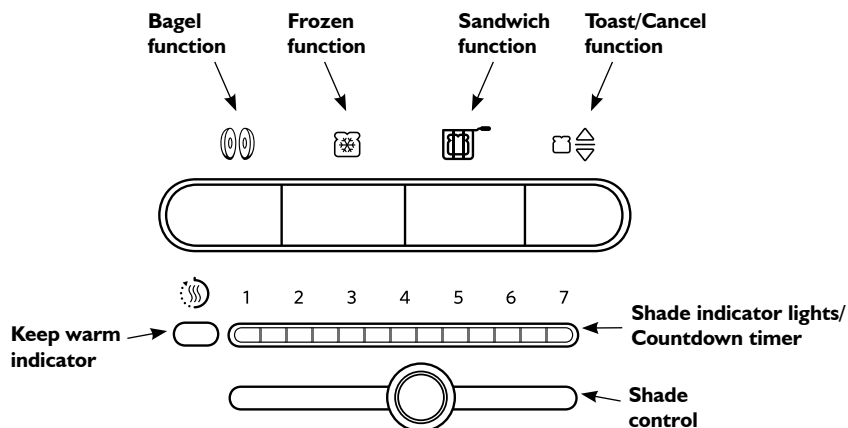
**Toast/Cancel function**

This is an automatic toaster. As soon as bread is placed in either slot it will begin to lower and toasting will begin using the selected settings.

Some food may be too light to trigger automatic toasting. If food does not begin to drop after 3 seconds, press TOAST/CANCEL (☐⬇️) to start the cycle manually. Press again to cancel a toasting cycle already in process, or to end a Keep warm cycle.

**Shade control and Shade indicator lights/Countdown timer**

Precisely sets the desired brownness level. Indicator lights show the setting at a glance. During toasting, lights on the shade setting bar will blink to indicate time left in the toasting cycle.

**Keep warm indicator**

If the food is not removed within 45 seconds of the end of a cycle, the toaster will automatically lower the food and activate a "Keep warm" cycle using low heat for up to 3 minutes. The Keep warm (☁️) indicator will light while this cycle is active. You can cancel this cycle at any time by pressing TOAST/CANCEL (☐⬇️).

**Bagel function**

Your Toaster features a special setting for toasting bagels, ensuring optimal heat and time for the best results. The heating elements will adjust to nicely toast the inside of a cut bagel without burning the bagel's outside surface.

**Frozen function**

Your Toaster features a Frozen function that gently defrosts and toasts frozen bread. Use Frozen for frozen foods only.

**Sandwich function**

Your Toaster features a special "Sandwich" setting to be used exclusively with the KitchenAid Sandwich rack to toast sandwiches made with thinly sliced meats and cheese. See "Toasting sandwiches" for more information.

## Toaster features

**Extra-wide slots with automatic self-centering racks**

Extra-wide slots allow you to easily toast bread, bagels, and English muffins up to 2.8 cm (1 1/8") thick. Self-centering racks help ensure even heating of thin or thick breads. An automatic lift mechanism raises and lowers racks.

**Controls**

Easy-to-use controls allow you to quickly select the desired settings and light to provide visual feedback.

**Dual independent controls (4-slice models only)**

Dual independent controls allow you to select different settings for each pair of slots.

**Cord wrap**

The cord wrap provides convenient storage of the cord when not in use.

**Removable crumb tray**

The removable crumb tray slides out for quick removal of crumbs. Hand-wash only.

## OPERATING THE TOASTER

## Before first use

Before using your Toaster, check the extra-wide slots and remove any packing or printed material that might have fallen inside during shipping or handling. Do not probe inside the Toaster with a metal object.

You may see light smoke the first time you use the Toaster. This is normal. The smoke is harmless and will soon disappear.

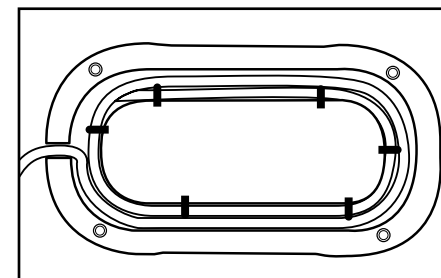

Shorten cord, if necessary, by wrapping cord under the base. The Toaster's feet are tall enough to allow the cord to exit from under any side of the Toaster.

Using the Toaster

**⚠ WARNING**



**Electrical Shock Hazard**

- Plug into a grounded outlet.**
- Do not remove ground prong.**
- Do not use an adapter.**
- Do not use an extension cord.**
- Failure to follow these instructions can result in death, fire, or electrical shock.**

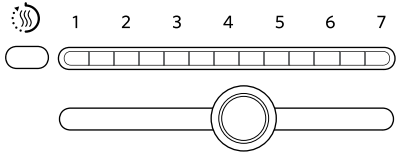

**2** Move the Shade control to select the degree of brownness you want. Move the Shade control to the right for darker toast or to the left for lighter. The indicator lights will display the shade level, from 1 (light) to 7 (dark).

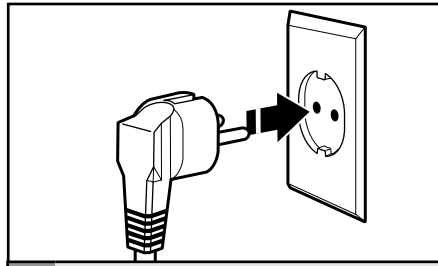

**1** Plug the Toaster cord into a grounded outlet.

**NOTE:** Different types of bread and their moisture levels may require different shade settings. For example, dry bread will brown more rapidly than moist bread and will require a lighter setting.

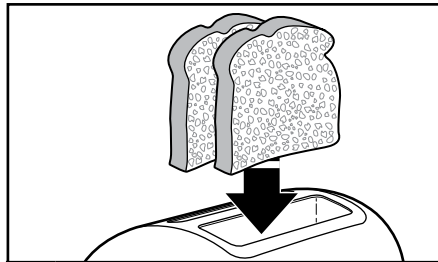

**3** Insert bread or other food to be toasted in slot(s).

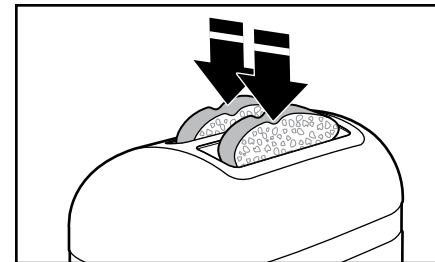

**4** As soon as bread is placed in either slot it will automatically begin to lower and toasting will begin. Some food may be too light to trigger automatic toasting. If the food does not begin to drop after 3 seconds press TOAST/CANCEL (☐↻) to start the cycle manually.



**5** (Optional) Press desired special toasting function button within 5 seconds. See the "Special Toasting Functions" section for more information.

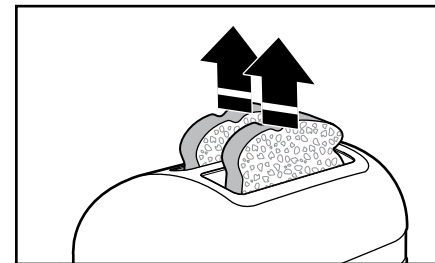

**6** When the Toaster is finished, it will automatically raise the food and a signal will sound. If food is not removed within 45 seconds, the Toaster will initiate the Keep warm mode.



**7** To cancel toasting at any time, press TOAST/CANCEL (☐↻). The Toaster will raise the toast and turn off.

Using the special toasting functions

If the food is not removed within 45 seconds of the end of a cycle, the Toaster will automatically lower the food and activate a "Keep warm" cycle using low heat for up to 3 minutes. The KEEP WARM (☁) indicator will light while this cycle is active.

**Keep warm function (☁)**



**1** Press the TOAST/CANCEL (☐↻) button once. If food is not removed, the Keep warm function will activate.

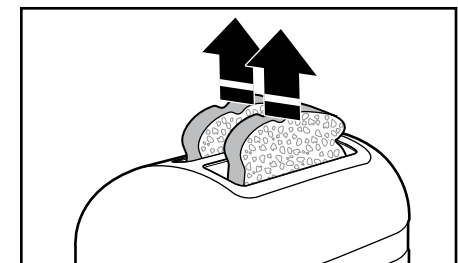

**2** If food is not removed within the 3 minute Keep warm cycle, it will raise up and the Toaster will turn off.



## Bagel function (☉)

Your Toaster features a special setting for toasting bagels, ensuring optimal heat and time for the best results. The heating elements will adjust to nicely toast the inside of a cut bagel without burning the bagel's outside surface.

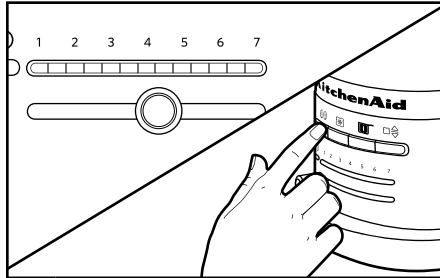

- 1 With the Shade control set to the desired level of brownness, press the BAGEL (☉) button.

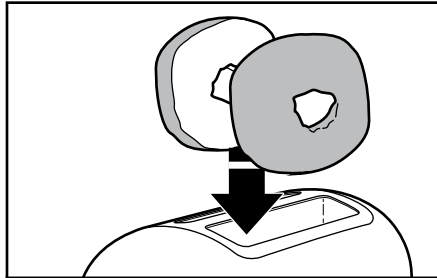

- 2 Insert bagel halves with the cut sides facing in, as shown. The Toaster will automatically lower the bagel and start toasting.

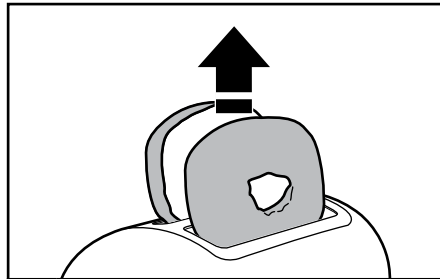

- 3 When the bagel is ready, the Toaster will raise it and a signal will beep. If bagel is not removed within 45 seconds, the Toaster will enter Keep warm mode.

## Frozen function (❄)

Your Toaster features a Frozen mode that gently defrosts and toasts frozen bread and bagels. Use the Frozen function for frozen foods only.

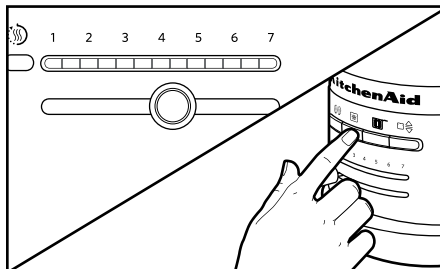

- 1 With the desired brownness level selected, press the FROZEN (❄) button.

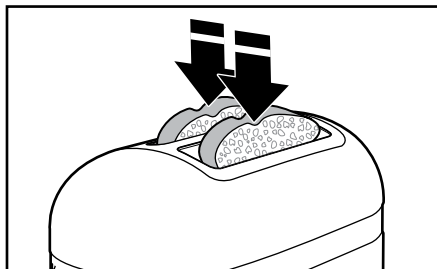

- 2 The Toaster automatically lowers the bread, runs a defrosting cycle to thaw it, then toasts it to the desired brownness.

## Toasting Sandwiches (☒)

Your Toaster features a special “Sandwich” setting to be used exclusively with the KitchenAid Sandwich rack to toast sandwiches made with thinly sliced meats and cheeses.

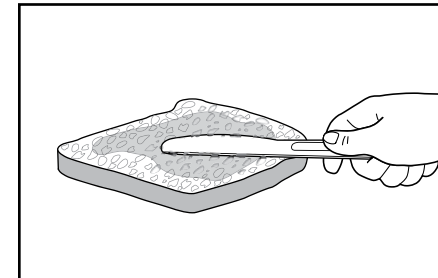

- 1 Lightly butter the outside of the sandwich bread – do not butter the side that will face the filling. Buttering the outside of the bread will slow browning and help warm the filling.

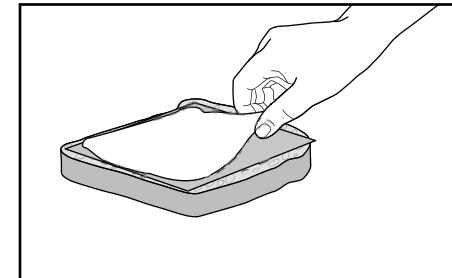

- 2 Fill the sandwich with desired ingredients, but do not overfill it! Thinly sliced ingredients – like ham, turkey, and cheese – work best.

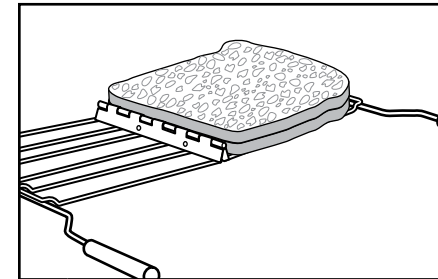

- 3 Open the Sandwich rack by spreading the handles apart. Then, place an edge of your sandwich flush with the bottom channel of the rack, as shown.

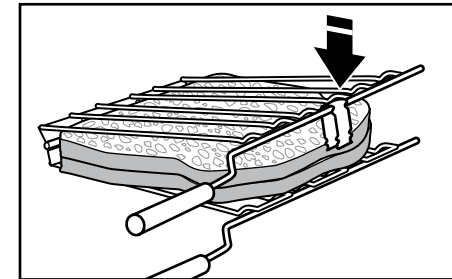

- 4 Press the Sandwich rack handles together to grip the sandwich. Close the clip to keep grids together.

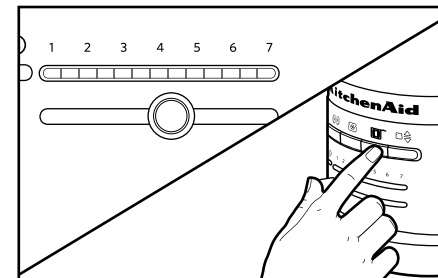

- 5 Set the Shade control to the desired level of brownness, then press the SANDWICH (☒) button.

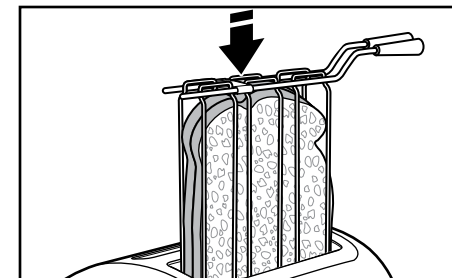

- 6 Insert the Sandwich rack into the toaster slot, with your sandwich inside, as shown. The Toaster will automatically lower the Sandwich rack and start toasting.

## OPERATING THE TOASTER

**NOTE:** For even toasting on 2-slot models, toast only one bread type and thickness at a time. If toasting two different types or thicknesses of bread with 4-slot models with Dual Independent Controls, be sure to toast only one bread type in each pair of slots.

Do **NOT** store your Sandwich rack in the Toaster, or place it back in the Toaster once sandwich is toasted and unloaded. This would start a new toasting cycle and prevent toaster from working properly.

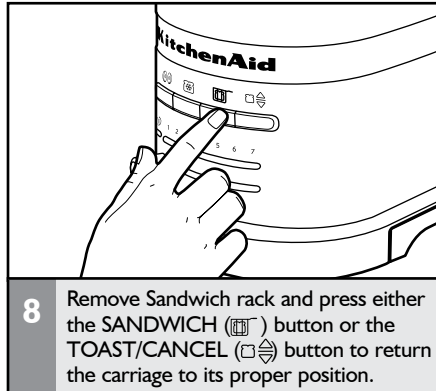
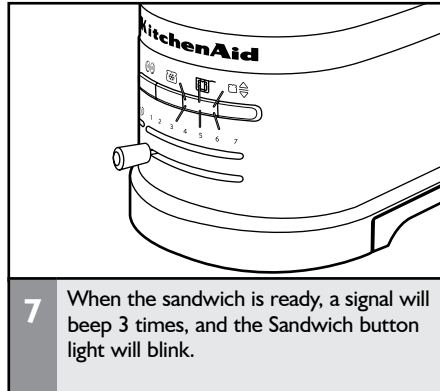

**NOTE:** If Sandwich rack is not removed, a signal will beep every 30 seconds for 2 minutes and the Sandwich button light will blink to remind you to remove it. If Sandwich rack is not removed within 2 minutes, the toaster will automatically turn off. In any case, the Sandwich rack must be removed to operate Toaster again.

## CARE AND CLEANING

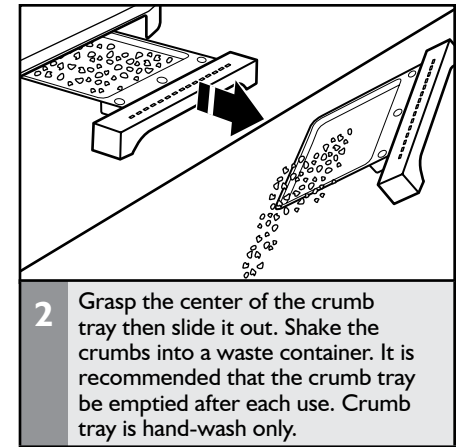
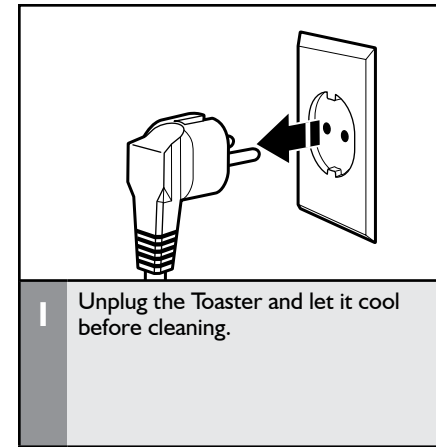

**IMPORTANT:** The tray will be hot immediately following a toasting cycle.

**NOTE:** If grease or oil splatters on the Toaster, wipe splatters away immediately using a soft, damp cotton cloth.

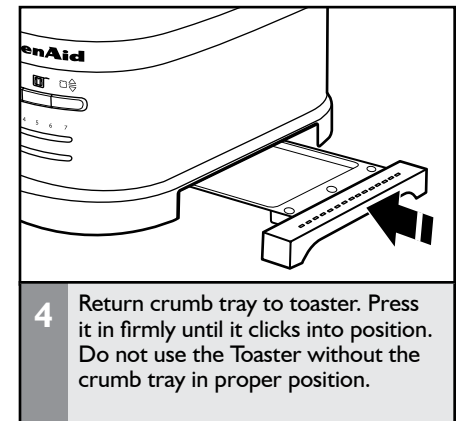
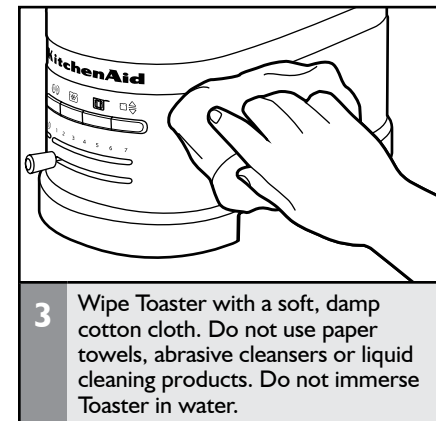

**NOTE:** KitchenAid does not recommend the use of a toaster cover.

**⚠ WARNING****Electrical Shock Hazard**

**Plug into a grounded outlet.**

**Do not remove ground prong.**

**Do not use an adapter.**

**Do not use an extension cord.**

**Failure to follow these instructions can result in death, fire, or electrical shock.**

**NOTE:** You may see light smoke the first time you use the Toaster. This is normal. The smoke is harmless and will soon disappear.

**If your Toaster should fail to operate, check the following:**

1. If the Toaster does not begin to drop and toast after 3 seconds, it might be that the food inserted is too light to trigger automatic toasting. Press TOAST/CANCEL (☐☐) to start the cycle manually.
2. If the Toaster fails to operate and the Sandwich light blinks, it means that a heavy item is preventing the Toaster from working properly. Remove the Sandwich rack or any other heavy items from the Toaster, then press the SANDWICH button (☐☐) or the TOAST/CANCEL button (☐☐) to allow the carriage to return to its proper position.
3. Check that the Toaster is plugged into a grounded 3-prong electrical outlet.
4. If the Toaster is plugged in, unplug it, then plug in the toaster again.
5. If the Toaster still does not work, check the household fuse or circuit breaker.

If the problem cannot be corrected, contact an Authorized Service Center (see the "Warranty and service" section).

Do not return the Toaster to the retailer - they do not provide service.

## KitchenAid Toaster warranty

Length of Warranty:	KitchenAid Will Pay For:	KitchenAid Will Not Pay For:
Europe, Middle East and Africa: Five years full warranty from date of purchase.	The replacement parts and repair labor costs to correct defects in materials or workmanship. Service must be provided by an Authorized KitchenAid Service Center.	A. Repairs when Toaster is used for operations other than normal household food preparation. B. Damage resulting from accident, alterations, misuse, abuse, or installation/operation not in accordance with local electrical codes.

**KITCHENAID DOES NOT ASSUME ANY RESPONSIBILITY FOR INDIRECT DAMAGES.**

## Customer service

**In U.K. and Ireland:**

For any questions, or to find the nearest KitchenAid Authorized Service Center, please find our contact details below.

**NOTE:** All service should be handled locally by an Authorized KitchenAid Service Center.

Contact number for U.K. and Northern Ireland:

Tollfree number 0800 988 1266 (calls from mobile phones are charged standard network rate)

Contact number for Ireland:

Tollfree number +44 (0) 20 8616 5148

E-mail contact for U.K. and Ireland:

Go to [www.kitchenaid.co.uk](http://www.kitchenaid.co.uk), and click on the link "Contact Us" at the bottom of the page

Address for U.K. and Ireland:

KitchenAid Europa, Inc.  
PO BOX 19  
B-2018 ANTWERP 11  
BELGIUM

**In other countries:**

For all product related questions and after sales matters, please contact your dealer to obtain the name of the nearest Authorized KitchenAid Service/Customer Center.

[www.KitchenAid.eu](http://www.KitchenAid.eu)

**KitchenAid**

© 2013. All rights reserved.  
Specifications subject to change without notice.

Ovaj dokument je originalno proizveden i objavljen od strane proizvođača, brenda KitchenAid, i preuzet je sa njihove zvanične stranice. S obzirom na ovu činjenicu, Tehnoteka ističe da ne preuzima odgovornost za tačnost, celovitost ili pouzdanost informacija, podataka, mišljenja, saveta ili izjava sadržanih u ovom dokumentu.

Napominjemo da Tehnoteka nema ovlašćenje da izvrši bilo kakve izmene ili dopune na ovom dokumentu, stoga nismo odgovorni za eventualne greške, propuste ili netačnosti koje se mogu naći unutar njega. Tehnoteka ne odgovara za štetu nanесenu korisnicima pri upotrebi netačnih podataka. Ukoliko imate dodatna pitanja o proizvodu, ljubazno vas molimo da kontaktirate direktno proizvođača kako biste dobili sve detaljne informacije.

Za najnovije informacije o ceni, dostupnim akcijama i tehničkim karakteristikama proizvoda koji se pominje u ovom dokumentu, molimo posetite našu stranicu klikom na sledeći link:

<https://tehnoteka.rs/p/kitchenaid-toster-ka5kmt4205ems-akcija-cena/>